

# SINGER

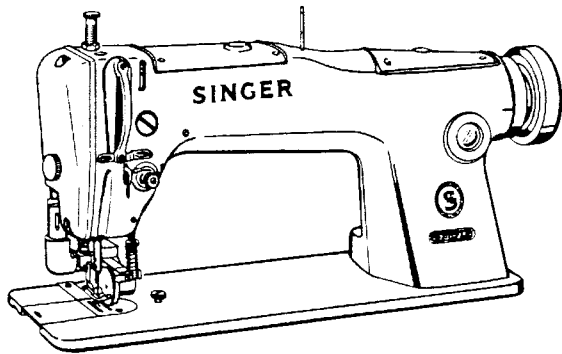

## PARTS 281-23

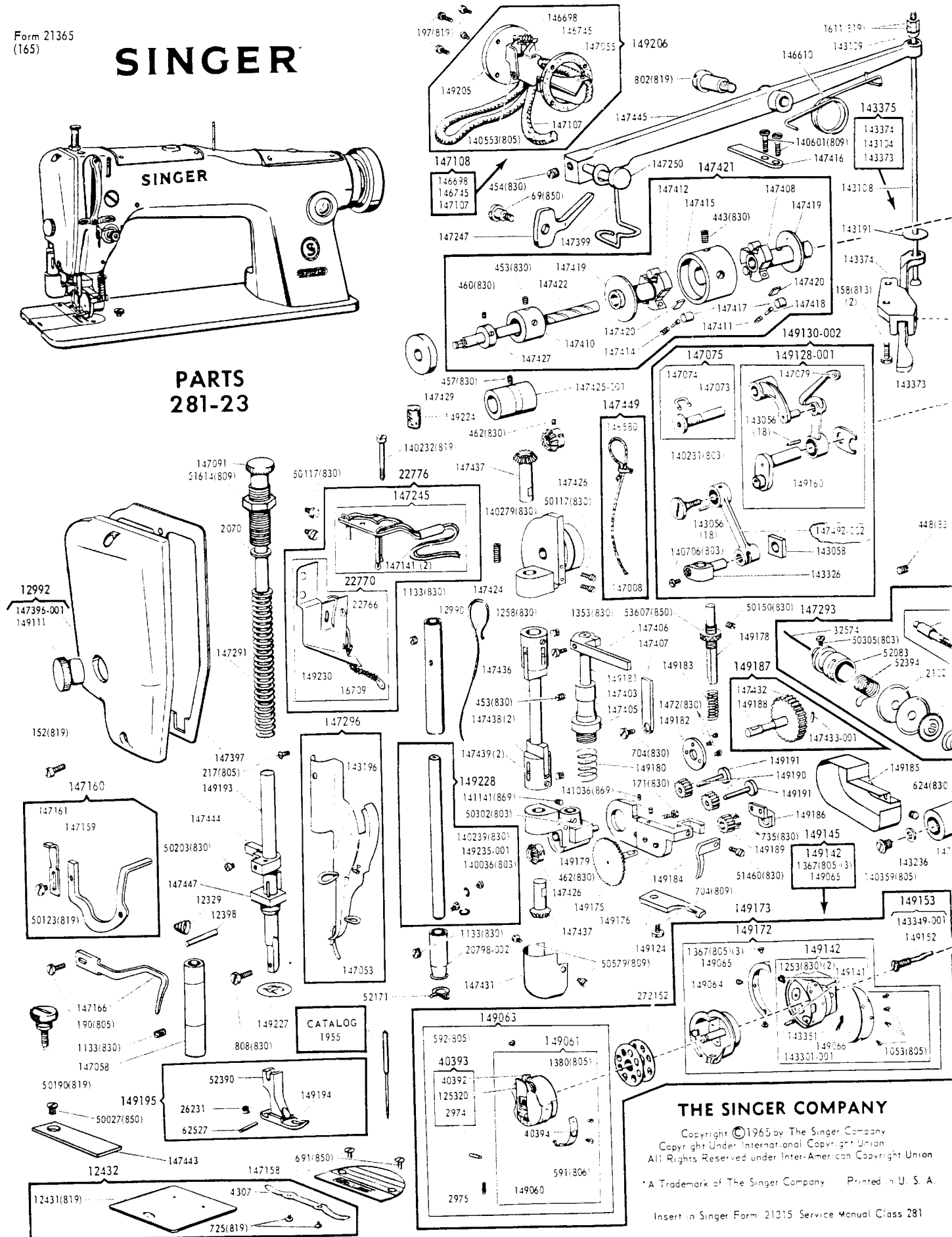

### THE SINGER COMPANY

Copyright © 1965 by The Singer Company  
 Copyright Under International Copyright Union  
 All Rights Reserved under Inter-American Copyright Union  
 A Trademark of The Singer Company Printed in U. S. A.

Insert in Singer Form 21315 Service Manual Class 281

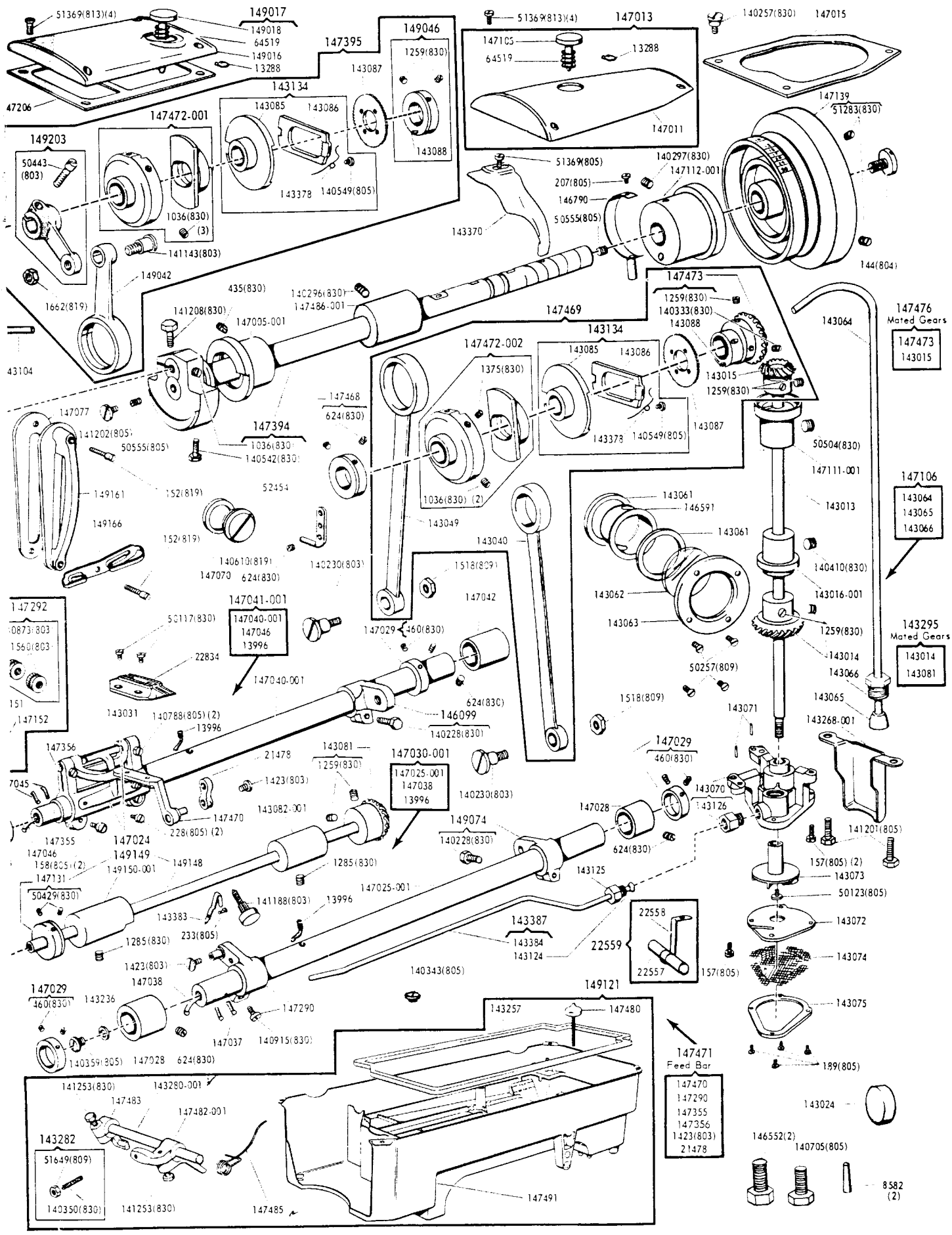

NUMERICAL LIST OF PARTS FOR 281-23 MACHINE

NUMBER	DESCRIPTION	NUMBER	DESCRIPTION	NUMBER	DESCRIPTION
69(850)	Presser Bar Lifter Hinge Screw	624(830)	Feed Rock Shaft Bushing (back) Set Screw	1662(819)	Feed (side) Wheel Eccentric Connecting Rod Hinge Screw Nut
144(804)	Arm Shaft (horizontal) Screw (back)	624(830)	Feed Lifting Rock Shaft Bushing (front) Set Screw	2070	Presser Bar Spring Washer
152(819)	Thread Take-up Lever Guard Screw (upper)	624(830)	Arm Shaft (horizontal) Thrust Collar Set Screw(2)	2102	Tension Disc(2)
152(819)	Thread Take-up Lever Guard and Thread Eyelet and Thread Guard Screw (front of Arm)	691(850)	Throat Plate Screw(2)	2974	Rotating Hook Bobbin Case Latch Lever Fulcrum Pin
152(819)	Face Plate Screw(2)	704(803)	Feed (side) Wheel Bracket Holder Shaft Guide Bracket Holder Screw	2975	Rotating Hook Bobbin Case Latch Spring
157(805)	Magnet Retaining Clamp and Oil Pump (centrifugal) Body Screw	704(809)	Rotating Hook Bobbin Case Holder Position Bracket Screw	4307	Bed Slide Spring
157(805)	Magnet Retaining Clamp and Oil Pump (centrifugal) Body Screw	725(819)	Bed Slide Spring Screw(2)	8582	Arm Dowel Pin(2)
157(805)	Oil Pump (centrifugal) Body Screw	735(830)	Feed (side) Wheel Spur Gear (front) Set Screw(2)	12329	Tension Releasing Lever Spring
158(805)	Feed Bar Carrier Clamping Screw (2)	802(819)	Presser Bar and Feed (side) Wheel Lifting Lever Hinge Screw	12398	Tension Releasing Lever Hinge Pin
158(813)	Bell Crank Bracket Screw(2)	808(830)	Presser Foot Screw	12431(819)	Bed Slide
171(830)	Feed (side) Wheel Gear Cover and Wheel Position Bracket Screw(2)	1036(830)	Feed Eccentric Body Set Screw(2)	12432	Bed Slide complete, Nos. 4307, 12431(819) and two 725(819)
189(805)	Oil Pump (centrifugal) Screen Frame Screw(4)	1036(830)	Feed (side) Wheel Eccentric Set Screw(3)	12990	Needle Bar Bushing (upper)
190(805)	Slack Thread Regulator Screw	1036(830)	Thread Take-up Crank Set Screw	12992	Face Plate 147396-001 with 149111
197(819)	Oil Removing Wick (head end) Hinge Plate and Cover Screw(4)	1053(805)	Rotating Hook Thread Guard Screw(4)	13288	Arm Top Cover (front) Stitch Regulator Plunger Spring Stop Ring
207(805)	Arm Shaft (horizontal) Flanged Bushing (back) Oil Sump Tube Holder Screw	1133(830)	Presser Bar Bushing (lower) Set Screw	13288	Arm Top Cover (back) Stitch Regulator Plunger Stop Ring
217(805)	Thread Take-up Lever Oil Guard Screw	1133(830)	Needle Bar Bushing (upper) Set Screw	13996	Feed Rock Shaft Oil Wick
228(805)	Feed Bar Carrier Oil Wick Holder Screw (2)	1133(830)	Needle Bar Bushing (lower) Set Screw	13996	Feed Lifting Rock Shaft Oil Wick
233(805)	Rotating Hook Oil Flow Regulating Thumb Screw Spring Screw	1253(830)	Rotating Hook Set Screw(2)	16709	Arm Side Shield Wick Spring Holder
435(830)	Thread Take-up Lever Link Hinge Stud Set Screw	1258(830)	Feed (side) Wheel Driving Shaft (upright) Driving Collar Set Screw(4)	20798-002	Needle Bar Bushing (lower)
435(830)	Arm Shaft (horizontal) Flanged Bushing (front) Set Screw	1259(830)	Arm Shaft (upright) Bevel Gear (upper) Set Screw(2)	21478	Feed Bar Connecting Link
443(830)	Feed (side) Wheel Clutch Body Set Screw(2)	1259(830)	Feed Lifting Eccentric Set Screw	22557	Magnet (for removing iron particles from oil)
448(830)	Thread Take-up Spring Regulator Set Screw	1259(830)	Arm Shaft (upright) Bevel Gear (lower) Set Screw(2)	22558	Magnet Retaining Clamp
453(830)	Feed (side) Wheel Bracket Holder Shaft Bushing Set Screw	1259(830)	Rotating Hook Shaft Bevel Gear Set Screw(2)	22559	Magnet Retaining Clamp 22558 with 22557
453(830)	Feed (side) Wheel Clutch (bracket) Bushing Set Screw(2)	1259(830)	Feed (side) Wheel Feed Regulating Locking Slide Ratchet Wheel Retaining Collar Set Screw(2)	22766	Arm Side Shield Wick (16 in. long)
454(830)	Presser Bar and Feed (side) Wheel Lifting Lever Pin Set Screw	1285(830)	Rotating Hook Shaft Bushing (front) Set Screw	22770	Arm Side Shield complete, Nos. 16709, 22766 and 149230
457(830)	Feed (side) Wheel Clutch Shaft Arm Bushing (rear) Set Screw	1285(830)	Rotating Hook Shaft Bushing (back) Set Screw	22776	Arm Side Shield and Oil Wick Holder Nos. 22770 and 147245
460(830)	Feed Lifting Rock Shaft Collar Set Screw(4)	1353(830)	Feed (side) Wheel Bracket Holder Shaft Guide Bracket Clamping Screw	22834	Feed Dog (20 teeth to the inch)
460(830)	Feed Rock Shaft Collar Set Screw(2)	1367(805)	Rotating Hook Section Screw(3)	26231	Presser Foot Spring
460(830)	Feed (side) Wheel Clutch Shaft Collar Set Screw(2)	1375(830)	Feed Eccentric Body Position Screw	32574	Tension Releasing Pin
462(830)	Feed (side) Wheel Clutch Shaft Bevel Gear Set Screw(2)	1380(805)	Rotating Hook Bobbin Case Tension Spring Screw	40392	Rotating Hook Bobbin Case Latch
462(830)	Feed (side) Wheel Driving Shaft (horizontal) Bevel Gear Set Screw(2)	1423(803)	Feed Bar Connecting Link Cap Screw(2)	40393	Rotating Hook Bobbin Case Latch Hinge, Nos. 2974, 40392 and 125320
591(806)	Rotating Hook Bobbin Case Tension Regulating Screw	1472(850)	Feed (side) Wheel Bracket Position Plate Screw(3)	40394	Rotating Hook Bobbin Case Tension Spring
592(805)	Rotating Hook Bobbin Case Latch Stop Screw	1518(809)	Feed Lifting Rock Shaft Connecting Rod Hinge Screw Nut	50027(850)	Feed Roll Plate Screw
624(830)	Feed Lifting Rock Shaft Bushing (back) Set Screw	1518(809)	Feed Rock Shaft Connecting Rod Hinge Screw Nut	50117(830)	Feed Dog Screw(2)
624(830)	Feed Rock Shaft Bushing (front) Set Screw	1560(803)	Tension Regulating Thumb Nut Lock Nut	50117(830)	Arm Side Shield Screw(2)
624(830)	Thread Retainer Set Screw	1560(803)	Tension Regulating Thumb Nut	50123(819)	Tension Releasing Lever (adjustable) Screw
		1611(819)	Presser Bar and Feed (side) Wheel Lifting Lever Connecting Rod Nut Lock Nut	50123(805)	Oil Pump (centrifugal) Impeller Locking Screw
		1611(819)	Presser Bar and Feed (side) Wheel Lifting Lever Connecting Rod Nut	50150(830)	Feed (side) Wheel Bracket Guide Set Screw
				50190(819)	Guide Thumb Screw
				50203(830)	Presser Bar Guide Bracket Clamping Screw
				50257(809)	Oil Flow Window Cap Screw(4)
				50302(803)	Feed (side) Wheel Bracket Stop Screw
				50305(803)	Tension Stud Set Screw
				50429(830)	Rotating Hook Shaft Oil Ring Set Screw(2)
				50443(830)	Feed (side) Wheel Clutch Shaft Driving Crank Clamping Screw

Numerical List of Parts for 281-23 Machine

NUMBER	DESCRIPTION	NUMBER	DESCRIPTION	NUMBER	DESCRIPTION
50504(830)	Arm Shaft (upright) Bushing (upper) Set Screw	140549(805)	Feed (side) Wheel Feed Regulator Lacking Slide Spring Screw	143058	Needle Bar Connecting Stud Slide Block
50555(805)	Arm Shaft (horizontal) Plug Screw(2)	140549(805)	Stitch Regulator Lacking Slide Spring Screw	143061	Oil Flow Body Gasket(2)
50579(809)	Feed (side) Wheel Driving Shaft (horizontal) Bevel Gear Cover Screw(2)	140553(805)	Oil Removing Wick (head end) Holder Body Hinge Screw	143062	Oil Flow Window
51283(830)	Machine Pulley Set Screw(2)	140601(809)	Feed (side) Wheel Clutch Position Bracket Screw(2)	143063	Oil Flow Window Cap
51369(805)	Oil Lead Screw	140607(819)	Arm Top Cover (front) Stitch Regulator Plunger Hole Plug Screw	143064	Oil Pipe
51369(813)	Arm Top Cover (back) Screw(4)	140607(819)	Arm Top Cover (back) Stitch Regulator Plunger Hole Plug Screw	143065	Oil Pipe Clamping Sleeve
51369(813)	Arm Top Cover (front) Screw(4)	140610(819)	Thread Take-up Crank Clamping Screw Hole Plug Screw	143066	Oil Pipe Clamping Sleeve Nut
51460(830)	Feed (side) Wheel Finger Guard Screw Pressure Regulating Thumb Screw Lock Nut	140705(805)	Arm Screw (back)	143070	Oil Pump (centrifugal) Body with 143126
51614(809)	Knee Lifter Rock Shaft Crank adjusting Screw Lock Nut	149706(830)	Needle Bar Connecting Stud Clamping Screw	143071	Oil Pump (centrifugal) Body Position Pin(2)
52083	Thread Take-up Spring Regulator with 50305(803)	140788(805)	Feed Bar Hinge Pin Clamping Screw(2)	143072	Oil Pump (centrifugal) Cover
52171	Needle Bar Bushing (lower) Thread Eyelet	140873(803)	Tension Stud	143073	Oil Pump (centrifugal) Impeller
52390	Presser Foot Shank	140915(830)	Feed Lifting Rock Shaft Crank (front) Clamping Screw	143074	Oil Pump (centrifugal) Screen
52394	Thread Take-up Spring	141036(869)	Feed (side) Wheel Spur Gear (intermediate) Stud Set Screw(2)	143075	Oil Pump (centrifugal) Screen Frame
52454	Thread Retainer	141141(869)	Feed (side) Wheel Bracket Holder Set Screw(2)	143081	Rotating Hook Shaft Bevel Gear (left hand spiral) with two 1259(830)
53607(850)	Feed (side) Wheel Bracket Pressure Spring Adjusting Nut	141143(803)	Feed (side) Wheel Eccentric Connecting Rod Hinge Screw	Note: To ensure proper functioning of Gears, No. 143081 will not be supplied separately to Agencies, but will be substituted by Pair of Gears No. 143295	
62527	Presser Foot Hinge Pin	141188(803)	Rotating Hook Oil Flow Regulating Thumb Screw	143082-001	Rotating Hook Shaft Bushing (back)
64519	Arm Top Cover (front) Stitch Regulator Plunger Spring	141201(805)	Arm and Bed Leg (back) Screw(2)	143085	Feed (side) Wheel Feed Regulator
64519	Arm Top Cover (back) Stitch Regulator Plunger Spring	141202(805)	Arm Shaft (horizontal) Screw Plug (front)	143085	Stitch Regulator
125320	Rotating Hook Bobbin Case Latch Lever	141208(830)	Thread Take-up Crank Clamping Screw	143086	Stitch Regulator Lacking Slide
140036(803)	Needle Bar Thread Guard Screw	141253(830)	Knee Lifter Rock Shaft Crank Clamping Screw	143086	Feed (side) Wheel Feed Regulator Lacking Slide
140228(830)	Feed Rock Shaft Crank Clamping Screw	141253(830)	Knee Lifter Rock Shaft Stop Dog Clamping Screw	143087	Feed (side) Wheel Feed Regulator Lacking Slide
140228(830)	Feed Lifting Rock Shaft Crank (back) Clamping Screw	143013	Arm Shaft (upright)	143087	Stitch Regulator Lacking Slide
140230(803)	Feed Rock Shaft Connecting Rod Hinge Screw	143014	Arm Shaft (upright) Bevel Gear (lower) right hand spiral with two 1259(830)	143088	Ratchet Wheel
140230(803)	Feed Lifting Rock Shaft Connecting Rod Hinge Screw	143015	Arm Shaft (upright) Bevel Gear (upper) left hand spiral with two 1259(830)	143088	Stitch Regulator Lacking Slide
140231(803)	Needle Bar Connecting Link Cap Screw	Note: To ensure proper functioning of Gears, No. 143014 will not be supplied separately to Agencies, but will be substituted by Pair of Gears No. 143295		143088	Stitch Regulator Lacking Slide
140232(819)	Oil Wick Holder Screw	143016-001	Arm Shaft (upright) Bushing (lower)	143104	Ratchet Wheel Pin
140239(830)	Needle Set Screw	143024	Bed Hole Plug	143108	Bell Crank Hinge Pin
140257(830)	Feed Eccentric Stop Screw (5-1/2 stitch)	143031	Feed Bar Carrier	143108	Presser Bar and Feed (side) Wheel Lifting Lever Connecting Rod
140279(830)	Feed (side) Wheel Clutch Shaft Arm Bushing (front) Set Screw	143040	Oil Wick	143109	Presser Bar and Feed (side) Wheel Lifting Lever Connecting Rod Swivel
140296(830)	Arm Shaft (horizontal) Bushing (center) Set Screw	143049	Feed Lifting Rock Shaft Connecting Rod	143124	Oil Pipe Clamping Sleeve
140297(830)	Arm Shaft (horizontal) Flanged Bushing (back) Set Screw	143056	Feed Rock Shaft Connecting Rod Needle Bar	143125	Oil Pipe Clamping Sleeve Nut
140333(830)	Feed Lifting Eccentric Position Screw	143056	Connecting Link Roller Bearing(18)	143126	Oil Pipe Clamping Sleeve Nut Adaptor
140343(805)	Machine and Machine Base Oil Reservoir Screw Hole Plug Screw	143056	Thread Take-up Lever Roller Bearing (18)	143134	Feed (side) Wheel Feed Regulator 143085 with 140549(805), 143086 and 143378
140350(805)	Knee Lifter Rock Shaft Crank Adjusting Screw	143056	Thread Take-up Lever Roller Bearing (18)	143134	Stitch Regulator 143085 with 140549(805), 143086 and 143378
140359(805)	Feed Rock Shaft Oil Screw Plug	143056	Thread Take-up Lever Roller Bearing (18)	143191	Presser Bar and Feed (side) Wheel Lifting Lever Connecting Rod Oil Mist Retaining Disc (felt)
140359(805)	Feed Lifting Rock Shaft Oil Screw Plug	143056	Thread Take-up Lever Roller Bearing (18)	143196	Needle Bar Oil Wick
140410(830)	Arm Shaft (upright) Bushing (lower) Set Screw	143056	Thread Take-up Lever Roller Bearing (18)	143236	Feed Rock Shaft Oil Screw Plug Washer (fiber)
140542(830)	Needle Bar Crank Position Screw	143056	Thread Take-up Lever Roller Bearing (18)	143236	Feed Lifting Rock Shaft Oil Screw Plug Washer (fiber)

Numerical List of Parts for 281-23 Machine

NUMBER	DESCRIPTION	NUMBER	DESCRIPTION	NUMBER	DESCRIPTION
143268-001	Bed Leg (back)	147041-001	Feed Rock Shaft	147290	Feed Lifting Rock Shaft Crank (front) with 140915(830)
143280-001	Knee Lifter Rock Shaft	147040-001	with 13996, 147046 and suitable length of	147291	Presser Bar Spring
143282	Knee Lifter Rock Shaft Crank Adjusting Screw 140350(803) with 51649(809)	147042	Feed Rock Shaft Bushing (back)	147292	Tension Stud 140873(803) with two 1560(803)
143295	Pair of Gears for Lower Shaft Nos. 143014 and 143081	147043	Feed Rock Shaft Bushing (front)	147293	Tension complete, Nos 32574, 52083, 52394, 147151, 147152, 147292 and two 2102
143301-001	Rotating Hook Oil Wick (felt)	147045	Feed Rock Shaft Oil Wick (short)(2)	147296	Thread Take-up Lever Oil Guard with 143196 and 147053
143326	Needle Bar Connecting Stud with 140706(803)	147046	Feed Rock Shaft Oil Wick (long)	147355	Feed Bar Carrier with two each 158(805) and 140788(805)
143349-001	Rotating Hook Shaft Oil Filter Wick Holder	147050-001	Needle Bar Connecting Link 147492-002 with 143326	147356	Feed Bar Hinge Pin (eccentric)
143351	Rotating Hook Wiper (leather)	147053	Needle Bar Connecting Stud Oil Wick	147394	Arm Shaft (horizontal) with 1036(830) and 140542(830)
143370	Oil Lead	147055	Oil Removing Wick (head end) Hinge Plate and Cover Gasket	147395	Combination of Feed Roll Feed and Stitch Regulator Parts, Nos. 1662(819), 141143(803), 143087, 143134, 147472-001 149042, 149046 and 149203
143373	Bell Crank	147058	Presser Bar Bushing (lower)	147396-001	Face Plate
143374	Bell Crank Bracket	147070	Thread Take-up Crank Clamping Screw Hole Plug Gasket	147397	Face Plate Gasket
143375	Bell Crank Complete, Nos. 143104, 143373 and 143374	147073	Thread Take-up Lever Link Hinge Stud	147399	Feed (side) Wheel and Presser Bar Lifting Lever Link
143378	Stitch Regulator Lacking Slide Spring	147074	Thread Take-up Lever Link Hinge Stud	147403	Feed (side) Wheel Bracket Holder Shaft Bushing
143378	Feed (side) Wheel Feed Regulator Lacking Slide Spring	147075	Thread Take-up Lever Link Hinge Stud 147073 with 147074	147405	Feed (side) Wheel Bracket Holder Pressure Spring Adjusting Nut
143383	Rotating Hook Oil Flow Regulating Thumb Screw Spring	147077	Thread Take-up Lever Guard Gasket	147406	Feed (side) Wheel Bracket Holder Shaft Guide Bracket with 1353(830)
143384	Oil Pipe for Oiling Rotating Hook Shaft (front) Bearing	147079	Thread Take-up Lever Thread Eyelet Bushing	147407	Feed (side) Wheel Bracket Holder Shaft Guide Bracket Holder
143387	Oil Pipe 143384 with 143124 for oiling Rotating Hook Shaft Front Bearing	147091	Pressure Regulating Thumb Screw and Presser Bar Guide	147408	Feed (side) Wheel Clutch (brake)
146099	Feed Rock Shaft Crank with 140228(830)	147105	Arm Top Cover (back) Stitch Regulator Plunger	147410	Feed (side) Wheel Clutch (brake) Bushing with two 453(830)
146552	Arm Screw (front and intermediate)(2)	147106	Oil Pipe Complete from Oil Pump to Arm Shaft (horizontal) Center Bearing, Nos. 143064, 143065 and 143066	147411	Feed (side) Wheel Clutch (brake) Member Spring(3)
146580	Feed (side) Wheel Bracket Holder Shaft Oil Retaining Wick Clip	147107	Oil Removing Wick (head end)	147412	Feed (side) Wheel Clutch (drive)
146591	Oil Flow Body	147108	Oil Removing Wick (head end) Holder Body 146745 with 146698 and 147107	147414	Feed (side) Wheel Clutch (drive) Member Spring(3)
146610	Presser Bar and Feed (side) Wheel Lifting Lever Spring	147111-001	Arm Shaft (upright) Bushing (upper)	147415	Feed (side) Wheel Clutch Body with two 443(830)
146698	Oil Removing Wick (head end) Holder Body Spring	147112-001	Arm Shaft (horizontal) Flanged Bushing (back)	147416	Feed (side) Wheel Clutch Position Bracket
146745	Oil Removing Wick (head end) Holder Body	147131	Rotating Hook Shaft Oil Retaining Collar with two 50429(830)	147417	Feed (side) Wheel Clutch Roller(6)
146790	Arm Shaft (horizontal) Flanged Bushing (back) Oil Sump Tube	147139	Machine Pulley small rim diameter (disc power) "V" belt groove 2.9 in. diam. with two 51283(830)	147418	Feed (side) Wheel Clutch Roller Plunger(6)
147005-001	Arm Shaft (horizontal) Flanged Bushing (front)	147141	Oil Wick, 11 in. long (for oiling Take-up Lever, Take-up Lever Link, Needle Bar Connecting Link and Thread Take-up Lever Link Hinge Bearing) (2)	147419	Feed (side) Wheel Clutch Washer(2)
147008	Feed (side) Wheel Bracket Holder Shaft Oil Retaining Wick	147151	Tension Releasing Disc	147420	Feed (side) Wheel Clutch Wearing Plate (6)
147011	Arm Top Cover (back) for 147013	147152	Tension Spring	147421	Feed (side) Wheel Clutch and Shaft complete, Nos. 147408, 147410, 147412, 147415, 147422, 147427, two 147419, three 147411, 147414 and six each 147417, 147418 and 147420
147013	Arm Top Cover (back) with Stitch Regulator Plunger complete, Nos. 13288, 64519, 147011 and 147105	147158	Throat Plate	147422	Feed (side) Wheel Clutch Shaft
147015	Arm Top Cover (back) Gasket	147159	Tension Releasing Lever Body	147424	Feed (side) Wheel Clutch Shaft Arm Bushing (front) Oil Wick
147024	Feed Bar Carrier Oil Wick Holder with 143031	147160	Tension Releasing Lever (adjustable) 147159 with 50123(819) and 147161	147425-001	Feed (side) Wheel Clutch Shaft Arm Bushing (rear)
147025-001	Feed Lifting Rock Shaft	147161	Tension Releasing Lever Segment		
147028	Feed Lifting Rock Shaft Bushing (front)	147166	Slack Thread Regulator		
147028	Feed Lifting Rock Shaft Bushing (back)	147206	Arm Top Cover (front) Gasket		
147029	Feed Lifting Rock Shaft Collar with two 460(830)(2)	147245	Oil Wick Holder with two 147141		
147029	Feed Rock Shaft Collar with two 460(830)	147247	Presser Bar Lifter		
147030-001	Feed Lifting Rock Shaft 147025-001 with 13996, 147038 and suitable length of No. 1229 White Lighter Wicking	147250	Presser Bar and Feed (side) Wheel Lifting Lever Pin		
147037	Feed Lifting Rock Shaft Oil Wick (short) (2)				
147038	Feed Lifting Rock Shaft Oil Wick (long)				
147040-001	Feed Rock Shaft				

Numerical List of Parts for 281-23 Machine

NUMBER	DESCRIPTION	NUMBER	DESCRIPTION	NUMBER	DESCRIPTION
147426	Feed (side) Wheel Clutch Shaft Bevel Gear with two 462(830)	147482-001	Knee Lifter Rock Shaft Crank with 141253(830) and 143282	149166	Thread Eyelet and Thread Guard (front of Arm)
147426	Feed (side) Wheel Driving Shaft (horizontal) Bevel Gear with two 462(830)	147483	Knee Lifter Rock Shaft Stop Dog with 141253(830)	149172	Rotating Hook (Air Cooled) 149142 with 149064, 149065 and three 1367(805)
147427	Feed (side) Wheel Clutch Shaft Collar with two 460(830)	147485	Knee Lifter Rock Shaft Spring	149173	Rotating Hook (Air Cooled) 149172 with 149063 and 149153
147429	Feed (side) Wheel Clutch Shaft Oil Retainer (felt)	147486-001	Arm Shaft (horizontal) Bushing (center)	149175	Feed (side) Wheel
147431	Feed (side) Wheel Driving Shaft (horizontal) Bevel Gear Cover	147491	Machine Base and Oil Reservoir	149176	Feed (side) Wheel Bracket with two 141036(869)
147432	Feed (side) Wheel Driving Shaft (horizontal) Spur Gear	147492-002	Needle Bar Connecting Link	149177	Feed (side) Wheel Bracket complete, Nos. 51460(830), 147426, 147431, 147437, 149175, 149176, 149179, 149182, 149184, 149185, 149186, 149187, 149189, two each 171(830) 50579(809), 149190, 149191 and three 1472(850)
147433-001	Feed (side) Wheel Driving Shaft (horizontal) Spur Gear Pin (1.2 in. long)	149016	Arm Top Cover (front)	149178	Feed (side) Wheel Bracket Guide
147436	Feed (side) Wheel Driving Shaft (upright)	149017	Arm Top Cover (front) with Stitch Regulator Plunger complete, Nos. 13288, 64519, 149016 and 149018	149179	Feed (side) Wheel Bracket Holder with 50302(803) and two 141141(869)
147437	Feed (side) Wheel Driving Shaft (upright) Bevel Gear (lower)	149018	Arm Top Cover (front) with Stitch Regulator Plunger	149180	Feed (side) Wheel Bracket Holder Pressure Spring
147437	Feed (side) Wheel Driving Shaft (upright) Bevel Gear (upper)	149042	Feed (side) Wheel Eccentric Connecting Rod	149181	Feed (side) Wheel Bracket Holder Shaft
147438	Feed (side) Wheel Driving Shaft (upright) Driving Collar with two 1258(830)(2)	149046	Feed (side) Wheel Feed Regulator Locking Slide Ratchet Wheel Retaining Collar with 143088 and two 1259(830)	149182	Feed (side) Wheel Bracket Position Plate
147439	Feed (side) Wheel Driving Shaft (upright) Hinge Pin (3.4 in. long) (2)	149060	Rotating Hook Bobbin Case	149183	Feed (side) Wheel Bracket Pressure Spring
147443	Feed Roll Plate	149061	Rotating Hook Bobbin Case 149060 with 591(806), 1380(805) and 40394	149184	Feed (side) Wheel Finger Guard
147444	Presser Bar Guide Bracket with 50203(830)	149063	Rotating Hook Bobbin Case complete, Nos. 592(805), 2974, 2975, 40392, 125320 and 149061	149185	Feed (side) Wheel Gear Cover
147445	Presser Bar and Feed (side) Wheel Lifting Lever with 454(830)	149064	Rotating Hook Bobbin Case Holder	149186	Feed (side) Wheel Position Bracket
147447	Presser Bar Lifting Bracket	149065	Rotating Hook Section	149187	Feed (side) Wheel Driving Shaft (horizontal) Spur Gear 147432 with 147433-001 and 149188
147449	Feed (side) Wheel Bracket Holder Shaft Oil Retaining Wick 147008 with 146580	149066	Rotating Hook Thread Guard	149188	Feed (side) Wheel Driving Shaft (horizontal)
147468	Arm Shaft (horizontal) Thrust Collar with two 624(830)	149074	Feed Lifting Rock Shaft Crank (back) with 140228(830)	149189	Feed (side) Wheel Spur Gear (front) with two 735(830)
147469	Combination of Feed and Stitch Regulator Parts, Nos. 143015, 143040, 143049, 143087, 143134, 147472-002 and 147473	149111	Face Plate Plug	149190	Feed (side) Wheel Spur Gear (intermediate) (2)
147470	Feed Bar	149121	Machine Base and Oil Reservoir with Knee Lifter Rock Shaft Nos. 143257, 143280-001, 147480, 147482-001, 147483, 147485 and 147491	149191	Feed (side) Wheel Spur Gear (intermediate) Stud(2)
147471	Feed Bar 147470 with 21478, 147290, 147355, 147356 and two 1423(803)	149128-001	Thread Take-up Crank with Thread Take-up Lever with 149160 and eighteen 143056	149193	Presser Bar (hollow)
147472-001	Feed (side) Wheel Eccentric	149130-002	Thread Take-up Crank and Thread Take-up Lever complete, Nos. 147075 and 149129-002	149194	Presser Foot Plate
147472-002	Feed Eccentric	149141	Rotating Hook (Air Cooled) with 143301-001 and two 1253(830)	149195	Presser Foot (spring hinged) complete, Nos. 26231, 52390, 62527 and 149194
147473	Feed Lifting Eccentric and Arm Shaft (horizontal) Bevel Gear, right hand spiral with 1259(830), 140333(830) and 143088	149142	Rotating Hook (Air Cooled) 149141 with 143351, 149066 and four 1053(805)	149203	Feed (side) Wheel Clutch Shaft Driving Crank with 50443(830)
	Note: To ensure proper functioning of Gears, No. 147473 will not be supplied separately to Agencies, but will be substituted by Pair of Gears No. 147476	149145	Rotating Hook (Air Cooled) 149142 with 149065 and three 1367(805)	149205	Oil Removing Wick (head end) Hinge Plate and Cover
147476	Pair of Gears for Upper Shaft Nos. 143015 and 147473	149148	Rotating Hook Shaft with 149153	149206	Oil Removing Wick (head end) Holder Body complete, Nos. 140553(805), 146698, 146745, 147055, 147107 and 149205
147480	Knee Lifter Bell Crank Plunger	149149	Rotating Hook Shaft 149148 with 147131	149224	Oil Wick Holder Plug (felt)
147481	Knee Lifter Rock Shaft 143280-001 with 147482-001, 147483 and 147485	149150-001	Rotating Hook Shaft Bushing (front)	149227	Presser Bar Bushing (lower) Washer
		149152	Rotating Hook Shaft Oil Filter Wick	149228	Needle Bar (hollow) with 140036(803), 140239(830) and 149235-001
		149153	Rotating Hook Shaft Oil Filter complete, Nos. 143349-001 and 149152	149230	Arm Side Shield
		149160	Thread Take-up Crank Wearing Plate	149235-001	Needle Bar Thread Guard
		149161	Thread Take-up Lever Guard	272152	Rotating Hook Bobbin Needle Cot. 1955 (Size No. 16)