

**SINGER**  
**281-30**

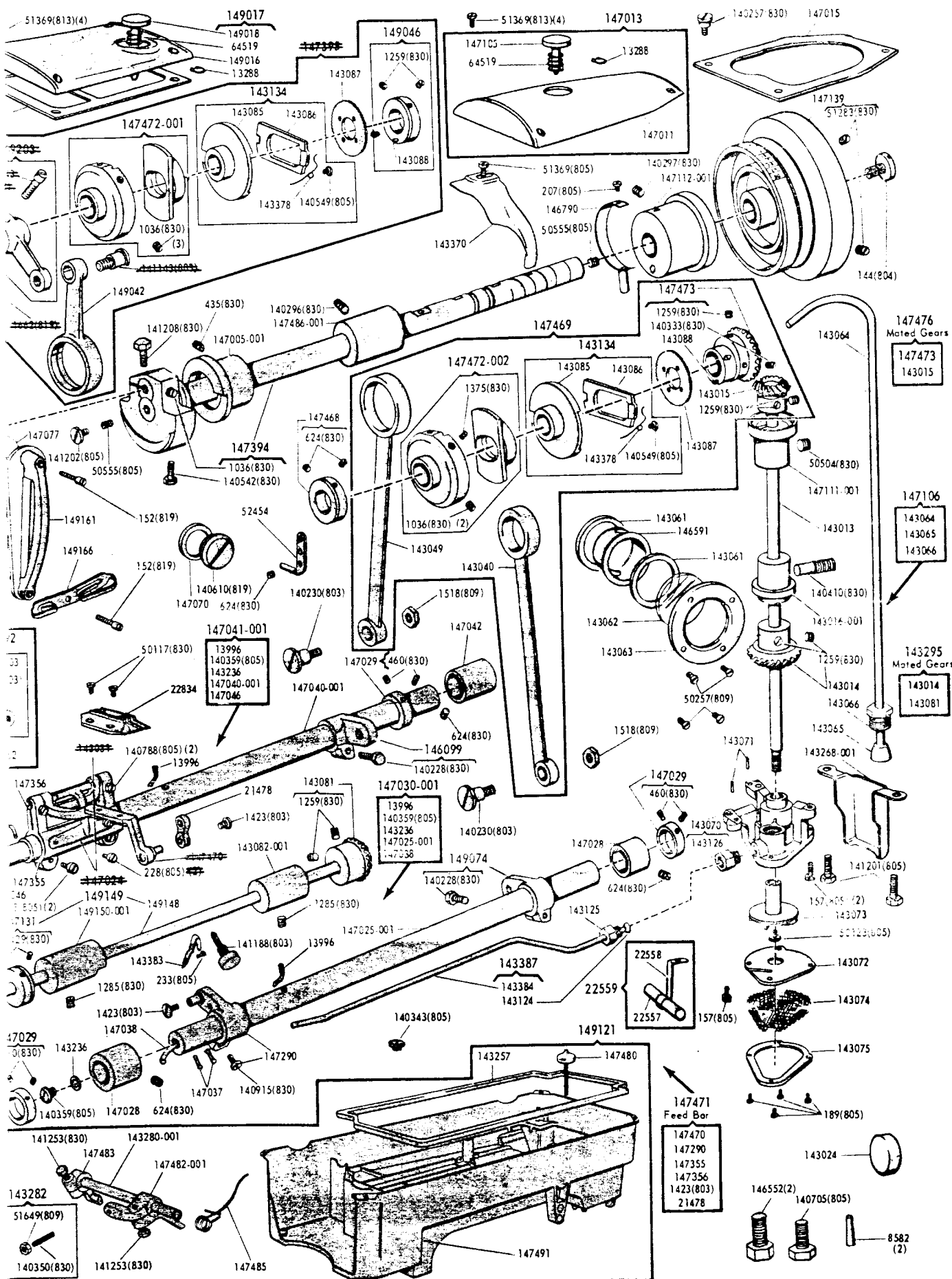



281-30  
NUMERICAL LIST OF PARTS FOR ~~281-30~~ MACHINE

NUMBER	DESCRIPTION	NUMBER	DESCRIPTION	NUMBER	DESCRIPTION	NUMBER	DESCRIPTION
69(850)	Presser Bar Lifter Hinge Screw	624(830)	Arm Shaft (horizontal) Thrust Collar Set Screw(2)	12329	Tension Releasing Lever Spring	50117(8)	
144(804)	Arm Shaft (horizontal) Screw (back)	691(850)	Throat Plate Screw(2)	12398	Tension Releasing Lever Hinge Pin	50123(8)	
152(819)	Thread Take-up Lever Guard and Thread Eyelet and Thread Guard Screw (front of arm)	704(809)	Rotating Hook Bobbin Case Holder Position Bracket Screw	12431(819)	Bed Slide	50123(8)	
152(819)	Face Plate Screw(2)	<del>704(809)</del>	Feed Roll Bracket Shaft Guide Bracket Holder Screw	12432	Bed Slide complete, Nos. 4367, 12431(819) and two 725-819)	50190(8)	
152(819)	Thread Take-up Lever Guard Screw	725(819)	Bed Slide Spring Screw(2)	12990	Needle Bar Bushing (upper)	50203(8)	
157(805)	Oil Pump (centrifugal) Body Screw(2)	802(819)	Presser Bar and Feed Roll Lifting Lever Hinge Screw	<del>12990</del>	Face Plate 147296-001 with 149111	50257(8)	
157(805)	Magnet Retaining Clamp and Oil Pump (centrifugal) Body Screw	1036(830)	Thread Take-up Crank Set Screw	12997	Feed Roll (rubber covered) with 447(830) Note: No. 12997 is furnished on order only	50305(8)	
158(813)	Bell Crank Bracket Screw(2)	1036(830)	Feed Eccentric Body Set Screw(2)	13288	Arm Top Cover (front) Stitch Regulator Plunger Spring Stop Ring	50429(8)	
158(805)	Feed Bar Carrier Clamping Screw(2)	1036(830)	Feed Roll Eccentric Set Screw(3)	13288	Arm Top Cover (back) Stitch Regulator Plunger Stop Ring	50504(8)	
189(805)	Oil Pump (centrifugal) Screen Frame Screw(4)	1053(805)	Rotating Hook Thread Guard Screw(4)	13300	Presser Bar (adjustable) complete, Nos. 14392, 14393 and 14119(869) Note: No. 13300 is furnished on order only	50555(8)	
190(805)	Slack Thread Regulator Screw	1133(830)	Needle Bar Bushing (upper) Set Screw	13996	Feed Lifting Rock Shaft Oil Wick	51233(8)	
197(819)	Oil Removing Wick (head end) Hinge Plate and Cover Screw(4)	1133(805)	Presser Bar Bushing (lower) Set Screw	13996	Feed Rock Shaft Oil Wick	51369(8)	
207(805)	Arm Shaft (horizontal) Flanged Bushing (back) Oil Sump Tube Holder Screw	1133(830)	Needle Bar Bushing (lower) Set Screw	14392	Presser Bar Note: No. 14392 is furnished on order only	51369(8)	
217(805)	Thread Take-up Lever Oil Guard Screw	1253(830)	Rotating Hook Set Screw(2)	14293	Presser Foot Seat Note: No. 14393 furnished on order only	51674(8)	
228(805)	Feed Bar Carrier Oil Wick Holder Screw(2)	1259(830)	Arm Shaft (upright) Bevel Gear (lower) Set Screw(2)	16709	Arm Side Shield Wick Spring Holder	51649(8)	
233(805)	Rotating Hook Oil Flow Regulating Thumb Screw Spring Screw	1259(830)	Arm Shaft (upright) Bevel Gear (upper) Set Screw(2)	20437	Feed Roll Guide Bar Screw Washer(2)	52083(8)	
435(830)	Thread Take-up Link Hinge Stud Set Screw	1259(830)	Feed Roll Feed Regulator Locking Slide Ratchet Wheel Retaining Collar Set Screw(2)	20798-001	Needle Bar Bushing (lower)	52394(8)	
435(830)	Arm Shaft (horizontal) Flanged Bushing (front) Set Screw	1259(830)	Feed Lifting Eccentric Set Screw	21148-001	Needle Bar (hollow) complete, Nos. 140036(803), 149220-002 and 149235-003	52454(8)	
<del>443(830)</del>	Feed Roll Clutch Body Set Screw(2)	1259(830)	Rotating Hook Shaft Bevel Gear Set Screw(2)	21478	Feed Bar Connecting Link	62527(8)	
<del>447(830)</del>	Feed Roll Set Screw	1285(830)	Rotating Hook Shaft Bushing (back) Set Screw	<del>21478</del>	Feed Roll (25 Pitch Diamond Knurl) with 447(830) Note: No. 21479 is furnished as regular to machine	62926(8)	
448(830)	Thread Take-up Spring Regulator Set Screw	1285(830)	Rotating Hook Shaft Bushing (front) Set Screw	<del>21478</del>	Feed Roll Bracket complete, Nos. 21479, 147400, 147426, 147430, 147431, 147432, 147433-001, 147434, 147435, 147437, 147440, 147441, 147442-001 and two each 50470(804) 50579(009) and 141068(819)	64519(8)	
<del>453(830)</del>	Feed Roll Bracket Shaft Bushing Set Screw	<del>1367(805)</del>	Feed Roll Bracket Shaft Guide Bracket Clamping Screw	22557	Magnet (for removing iron particles from oil)	64519(8)	
453(830)	Feed Roll Clutch (bracket) Bushing Set Screw(2)	1375(830)	Feed Eccentric Body Position Screw	22558	Magnet Retaining Clamp	125320(8)	
454(830)	Presser Bar and Feed Roll Lifting Lever Pin Set Screw	1560(805)	Rotating Hook Bobbin Case Tension Spring Screw	22559	Magnet Retaining Clamp 22558 with 22557	140036(8)	
<del>463(830)</del>	Feed Roll Clutch Shaft Arm Bushing (rear) Set Screw	1423(803)	Feed Bar Connecting Link Cap Screw(2)	22766	Arm Side Shield Wick (16 in. long)	140228(8)	
460(830)	Feed Roll Clutch Shaft Collar Set Screw(2)	1518(809)	Feed Lifting Rock Shaft Connecting Rod Hinge Screw Nut	<del>22766</del>	Arm Side Shield complete, Nos. 16709, 22766 and 149230	140228(8)	
460(830)	Feed Rock Shaft Collar Set Screw(2)	1518(809)	Feed Rock Shaft Connecting Rod Hinge Screw Nut	22834	Arm Side Shield and Oil Wick Holder, Nos. 22770 and 147245	140228(8)	
<del>460(830)</del>	Feed Lifting Rock Shaft Collar Set Screw(4)	1560(803)	Tension Regulating Thumb Nut	22837	Feed Dog (20 teeth to the inch), for use with 147158 and 161066	140230(8)	
<del>463(830)</del>	Feed Roll Driving Shaft (horizontal) Bevel Gear Set Screw(2)	1560(803)	Tension Regulating Thumb Nut Lock Nut	22837	Feed Roll (32 rows of spiked teeth, 4 teeth to a row) with 447(830) Note: No. 22837 is furnished on order only	140230(8)	
462(830)	Feed Roll Clutch Shaft Bevel Gear Set Screw(2)	1611(819)	Presser Bar and Feed Roll Lifting Lever Connecting Rod Nut	32574	Tension Releasing Pin	140334(8)	
591(806)	Rotating Hook Bobbin Case Tension Regulating Screw	1611(819)	Presser Bar and Feed Roll Lifting Lever Connecting Rod Nut Lock Nut	40392	Rotating Hook Bobbin Case Latch	140334(8)	
592(805)	Rotating Hook Bobbin Case Latch Stop Screw	1611(819)	Feed Roll Eccentric Connecting Rod Hinge Screw Nut	40393	Rotating Hook Bobbin Case Latch Hinge Nos. 2974, 40392 and 125320	140334(8)	
624(830)	Thread Retainer Set Screw	<del>1664(819)</del>	Feed Roll Guide Bar Adjusting Screw Nut	40394	Rotating Hook Bobbin Case Tension Spring	140334(8)	
624(830)	Feed Rock Shaft Bushing (back) Set Screw	2070	Presser Bar Spring Washer	50027(850)	Feed Roll Plate Screw	140334(8)	
624(830)	Feed Lifting Rock Shaft Bushing (back) Set Screw	2102	Tension Disc(2)	<del>50123(8)</del>	Arm Side Shield Screw(2)	140334(8)	
624(830)	Feed Rock Shaft Bushing (front) Set Screw	2974	Rotating Hook Bobbin Case Latch Lever Fulcrum Pin				
624(830)	Feed Lifting Rock Shaft Bushing (front) Set Screw	2975	Rotating Hook Bobbin Case Latch Spring				
		4307	Bed Slide Spring				
		8582	Arm Dowel Pin(2)				





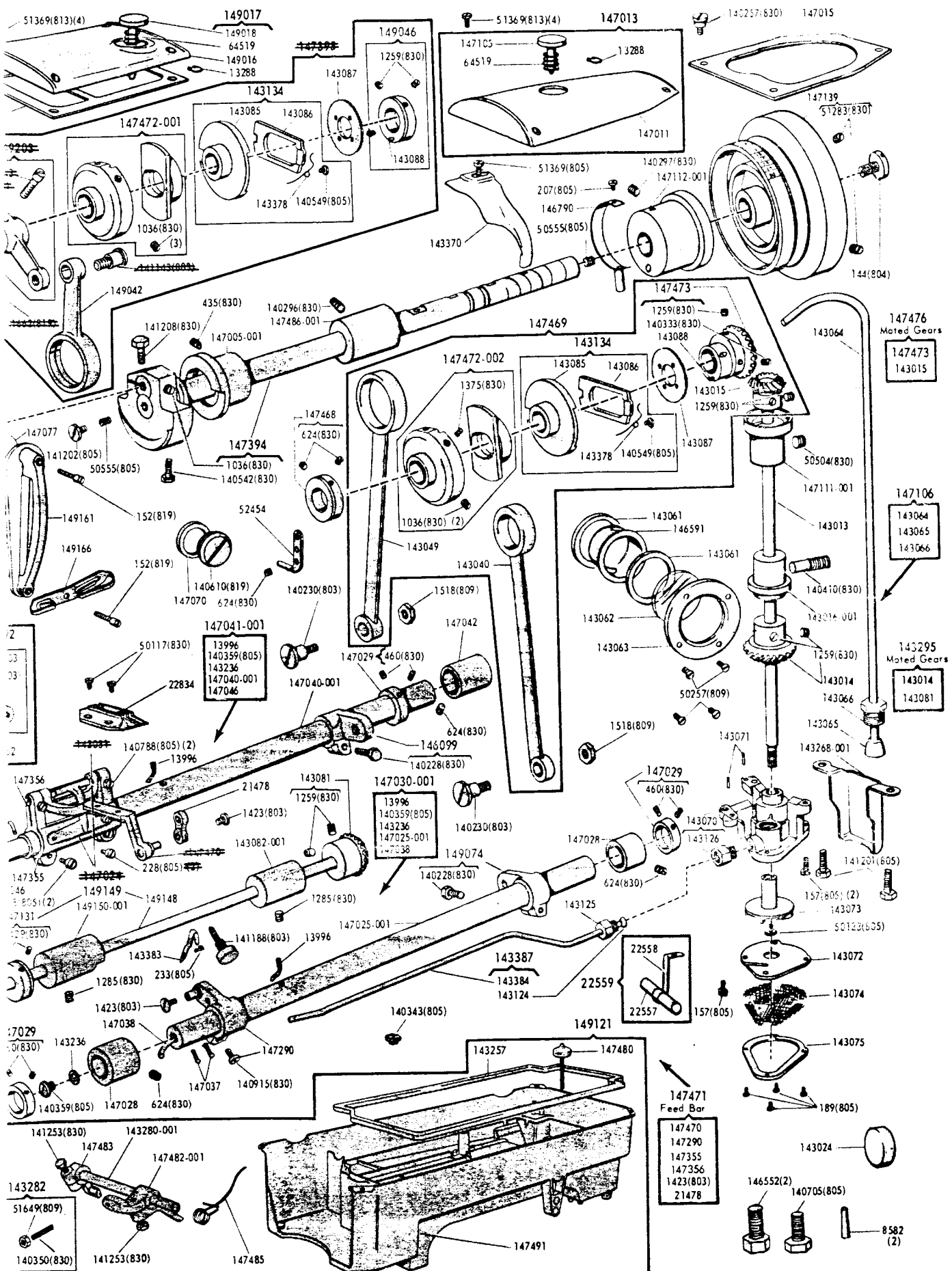

281-30  
Numerical List of Parts for ~~281-20~~ Machine

DESCRIPTION	NUMBER	DESCRIPTION	NUMBER	DESCRIPTION
Feed Roll Clutch (drive) Member Spring(3)	147472-002	Feed Eccentric	149145	Rotating Hook (Air Cooled) 149142 with 149065 and three 1367(805)
Feed Roll Clutch Body with two 443(830)	147473	Feed Lifting Eccentric and Arm Shaft (horizontal) Bevel Gear, right hand spiral with 1259(830), 140333(830) and 143088	149148	Rotating Hook Shaft with 149153
Feed Roll Clutch Position Bracket		Note: To ensure proper functioning of Gears, No. 147473 will not be supplied separately to Agencies, but will be substituted by Pair of Gears No. 147476	149149	Rotating Hook Shaft 149148 with 147131
Feed Roll Clutch Rolled(6)			149150-001	Rotating Hook Shaft Bushing (front)
Feed Roll Clutch Roller Plunger(6)			149152	Rotating Hook Shaft Oil Filter Wick
Feed Roll Clutch Washer(2)			149153	Rotating Hook Shaft Oil Filter complete, Nos. 143349-001 and 147152
Feed Roll Clutch Wearing Plate(6)	147476	Pair of Gears for Upper Shaft Nos. 143015 and 145473	149160	Thread Take-up Crank Wearing Plate
Feed Roll Clutch and Shaft complete, Nos. 147408, 147410, 147412, 147415, 147422, 147427 two 147419, three each 147411, 147414 and six each 147417, 147418 and 147420	147480	Knee Lifter Bell Crank Plunger	149161	Thread Take-up Lever Guard
Feed Roll Clutch Shaft	147482-001	Knee Lifter Rock Shaft Crank with 141253(830) and 143282	149166	Thread Eyelet and Thread Guard (front of arm)
Feed Roll Clutch Shaft Arm Bushing (front)	147485	Knee Lifter Rock Shaft Stop Dog with 141253(830)	149172	Rotating Hook (Air Cooled) 149142 with 149064, 149065 and three 1367(805)
Oil Wick with 146580	147485	Knee Lifter Rock Shaft Spring	149173	Rotating Hook (Air Cooled) 149172 with 149063 and 149153
Feed Roll Clutch Shaft Arm Bushing (rear)	147486-001	Arm Shaft (horizontal) Bushing (center)		
Feed Roll Clutch Shaft Bevel Gear with two 462(830)	147491	Machine Base and Oil Reservoir		
Feed Roll Driving Shaft (horizontal) Bevel Gear with two 462(830)	147492-002	Needle Bar Connecting Link	<del>149203</del>	Feed Roll Clutch Shaft Driving Crank with 50443(830)
Feed Roll Clutch Shaft Collar with two 460(830)	149016	Arm Top Cover (front)	149205	Oil Removing Wick (head end) Hinge Plate and Cover
Feed Roll Clutch Shaft Oil Retainer (felt)	149017	Arm Top Cover (front) with Stitch Regulator Plunger complete, Nos. 13288, 64519, 149016 and 149018	149206	Oil Removing Wick (head end) Holder Body complete, Nos. 140553(805), 146698, 146745, 147055, 147107 and 149205
Feed Roll Driving Shaft (horizontal)	149018	Arm Top Cover (front) Stitch Regulator Plunger	149220-002	Needle Bar (hollow) with 140239(830)
Feed Roll Driving Shaft (horizontal) Bevel Gear Cover	149042	Feed Roll Eccentric Connecting Rod	<del>149222</del>	Feed Roll Bracket Shaft Guide Bracket with 1353(830)
Feed Roll Driving Shaft (horizontal) Spur Gear	149046	Feed Roll Feed Regulator Lacking Slide Ratchet Wheel Retaining Collar with 143088 and two 1259(830)	149224	Oil Wick Holder Plug (felt)
Feed Roll Driving Shaft (horizontal) Spur Gear Pin (1/2 in. long)	149060	Rotating Hook Bobbin Case	149227	Presser Bar Bushing (lower) Washer
Feed Roll Driving Shaft (horizontal) Spur Gear and Feed Roll Shaft Spur Gear Cover	149061	Rotating Hook Bobbin Case 149060 with 591(806), 1380(805) and 40394	<del>149230</del>	Arm Side Shield
Feed Roll Driving Shaft (horizontal) Spur Gear and Feed Roll Shaft Spur Gear Cover Plate	149063	Rotating Hook Bobbin Case complete, Nos. 592(805), 2974, 2975, 40392, 125320 and 149061	149235-003	Needle Bar Thread Guard
Feed Roll Driving Shaft (upright)	149064	Rotating Hook Bobbin Case Holder	161065	Presser Foot Plate
Feed Roll Driving Shaft (upright) Bevel Gear (upper) and (lower)	149065	Rotating Hook Section	161066	Presser Foot (spring hinged) complete, Nos. 62527, 62926, 161065 and 161160, for use with 22834 and 147158
Feed Roll Driving Shaft (upright) Driving Collar with two 1258(830)(2)	149066	Rotating Hook Thread Guard	161160	Presser Foot Spring
Feed Roll Driving Shaft (upright) Hinge Pin (3/4 in. long)(2)	149074	Feed Lifting Rock Shaft Crank (back) with 140228(830)	272152	Rotating Hook Bobbin Needle Cat. No. 1955 (Size No. 16)
Feed Roll Shaft	149111	Face Plate Plug (for plugging the Presser Bar adjustment hole)	---	
Feed Roll Shaft Spur Gear	<del>149112</del>	Feed Roll Guide Bar		
Feed Roll Shaft Spur Gear Pin (3/8 in. long)	<del>149113</del>	Feed Roll Guide Bracket		
Feed Roll Plate	149121	Machine Base and Oil Reservoir with Knee Lifter Rock Shaft, Nos. 143257, 143280-001, 147480, 147482-001, 147483, 147485 and 147491		
Presser Bar Guide Bracket with 50203(830)	<del>149122</del>	Rotating Hook Bobbin Case Holder Position Bracket		
Presser Bar and Feed Roll Lifting Lever with 454(830)	149128-001	Thread Take-up Crank with Thread Take-up Lever with 149160 and eighteen 143056		
Presser Bar Lifting Bracket	149130-002	Thread Take-up Crank and Thread Take-up Lever complete		
Feed Roll Bracket Shaft Oil Retaining Wick 147008 with 146580	149141	Rotating Hook (Air Cooled) with 143301-001 and two 1253(830)		
Arm Shaft (horizontal) Thrust Collar with two 624(830)	149142	Rotating Hook (Air Cooled) 149141 with 143351, 149066 and four 1053(805)		
Combination of Feed and Stitch Regulator Parts, Nos. 143015, 143040, 143049, 143087, 143134, 147472-002 and 147473				
Feed Bar				
Feed Bar 147470 with 21478, 147290, 147355, 147356 and two 1423(803)				
Feed Roll Eccentric				



281-30  
Numerical List of Parts for ~~281-20~~ Machine

NUMBER	DESCRIPTION	NUMBER	DESCRIPTION	NUMBER	DESCRIPTION	NUMBER	DESCRIPTION
143124	Stitch Reg. Lever 143085 with 143049 (803), 143066 and 14337b	147025-001	Feed Lifting Rock Shaft	147141	Oil Wick, 11 in. long for oiling Take-up Lever, Take-up Lever Link, Needle Bar Connecting Link and Thread Take-up Lever Link Hinge Bearing(2)		
143191	Presser Bar and Feed Roll Lifting Lever Connecting Rod Oil Mist Retaining Disc (felt)	147028	Feed Lifting Rock Shaft Bushing (front)	147151	Tension Releasing Disc		
143196	Needle Bar Oil Wick	147028	Feed Lifting Rock Shaft Bushing (back)	147152	Tension Spring		
143246	Feed Lifting Rock Shaft Oil Seal Plug Washer (felt)	147029	Feed Lifting Rock Shaft Collar with two 460(830)(2)	<del>147156</del>	Throat Plate (large needle hole) for use with 22634 and 161066		
143256	Feed Roll Shaft Oil Screw Plug Washer (fiber)	147029	Feed Rock Shaft Collar with two 460(830)	147159	Tension Releasing Lever Body		
143260	Arm Top Cover (back) Spool Pin with Spool Rear, 3-1/2 in. long	147030-001	Feed Lifting Rock Shaft 147025-001 with 13996, 147038 and suitable length of No. 1229 White Lighter Wicking	147160	Tension Releasing Lever Body (adjustable) 147159 with 50123(819) and 147161		
143257	Machine Base and Oil Reservoir Gasket (cork)	147037	Feed Lifting Rock Shaft Oil Wick (short)(2)	147161	Tension Releasing Lever Segment		
143260-001	Bed Leg (brake)	147038	Feed Lifting Rock Shaft Oil Wick (long)	147166	Slack Thread Regulator		
143260-001	Knee Lifter Rock Shaft	147040-001	Feed Rock Shaft	147206	Arm Top Cover (front) Gasket		
143282	Knee Lifter Rock Shaft Crank Adjusting Screw 140350(803) with 51649(809)	147041-001	Feed Rock Shaft 147040-001 with 13996, 147046 and suitable length of No. 1229 White Lighter Wicking	147245	Oil Wick Holder with two 147141		
143295	Pair of Gears for Lower Shaft, Nos. 143014 and 143051	147042	Feed Rock Shaft Bushing (back)	147247	Presser Bar Lifter		
143301-001	Rotating Hook Oil Wick (felt)	147043	Feed Rock Shaft Bushing (front)	147250	Presser Bar and Feed Roll Lifting Lever Pin		
143326	Needle Bar Connecting Stud with 140706(803)	147045	Feed Rock Shaft Oil Wick (short)	147290	Feed Lifting Rock Shaft Crank (front) with 140915(830)		
143349-001	Rotating Hook Shaft Oil Filter Wick Holder	147046	Feed Rock Shaft Oil Wick (long)	147291	Presser Bar Spring		
143351	Rotating Hook Wiper (leather)	147050-001	No. 21/2 B. Connecting Link 147492-002 with 143326	147292	Tension Stud 140873(803) with two 1560(803)		
143370	Oil Lead	147053	Needle Bar Connecting Stud Oil Wick	147293	Tension complete, Nos. 32574, 52083, 52394, 147151, 147152, 147292 and two 2102		
143373	Bell Crank	147055	Oil Removing Wick (head end) Hinge Plate and Cover Gasket	147296	Thread Take-up Lever Oil Guard with 143196 and 147053		
143374	Bell Crank Bushing	147057	Presser Bar (hollow)	147355	Feed Bar Carrier with two each 158(805) and 140788(805)		
143375	Bell Crank Complete, Nos. 143104, 143373 and 143374	147058	Presser Bar Bushing (lower)	147356	Feed Bar Hinge Pin (eccentric)		
143378	Feed Roll Feed Regulator Locking Slide Spring	147070	Thread Take-up Crank Clamping Screw Hole Plug Gasket	147394	Arm Shaft (horizontal) with 1036(830) and 140542(830)		
143378	Stitch Regulator Locking Slide Spring	147073	Thread Take-up Lever Link Hinge Stud	<del>147395</del>	Combination of Feed Roll Feed Parts, Nos. <del>140387</del> , 143087, 143134, 147472-001, 149042, 149046 and 149203		
143383	Rotating Hook Oil Flow Regulating Throat Screw Spring	147074	Thread Take-up Lever Link Hinge Stud Oil Wick	<del>147396-001</del>	Face Plate		
143384	Oil Pipe for oiling Rotating Hook Shaft (front) Bearing	147075	Thread Take-up Lever Link Hinge Stud 147073 with 147074	<del>147397</del>	Face Plate Gasket		
143387	Oil Pipe 143384 with 143124 for oiling Rotating Hook Shaft Front Bearing	147077	Thread Take-up Lever Guard Gasket	<del>147398-001</del>	Feed Roll (48 teeth) with 447(830)		
146099	Feed Roll Shaft Crank with 140228(830)	147079	Thread Take-up Lever Thread Eyelet Bushing Pressure Regulating Thumb Screw and Presser Bar Guide	<del>147399-001</del>	Feed Roll (32 teeth) with 447(830)		
146552	Arm Screw (front end intermediate)(2)	147091	Arm Shaft (upright) Bushing (upper)	<del>147399-002</del>	Notes: No. 147398-002 is furnished on order only		
<del>146580</del>	Feed Roll Bracket Shaft Oil Retaining Wick Clip	147105	Arm Shaft (horizontal) Flanged Bushing (back)	<del>147399-003</del>	Feed Roll and Presser Bar Lifting Lever Link		
146560	Feed Roll Clutch Shaft Arm Bushing (front) Oil Wick Clip	147106	Oil Pipe complete from Oil Pump to Arm Shaft (horizontal) Center Bearing, Nos. 143064, 143065 and 143066	<del>147399-004</del>	Feed Roll Bracket with two 141141(869)		
146591	Oil Flow Body	147107	Oil Removing Wick (head end)	<del>147399-005</del>	Feed Roll Bracket Shaft	147	
146610	Presser Bar and Feed Roll Lifting Lever Spring	147108	Oil Removing Wick (head end) Holder Body 146745 with 146698 and 147107	<del>147399-006</del>	Feed Roll Bracket Shaft Bushing	147	
146698	Oil Removing Wick (head end) Holder Body Spring	147111-001	Arm Shaft (upright) Bushing (upper)	<del>147399-007</del>	Feed Roll Bracket Pressure Spring	147	
146745	Oil Removing Wick (head end) Holder Body	147112-001	Arm Shaft (horizontal) Flanged Bushing (back)	<del>147399-008</del>	Feed Roll Bracket Pressure Spring Adjusting Nut	147	
146790	Arm Shaft (horizontal) Flanged Bushing (back) Oil Sump Tube	147114	Needle Bar Bushing (lower) Thread Eyelet	<del>147399-009</del>	Feed Roll Bracket Shaft Guide Bracket Holder	147	
147005-001	Arm Shaft (horizontal) Flanged Bushing (front)	147131	Rotating Hook Shaft Oil Retaining Collar with two 50429(830)	<del>147399-010</del>	Feed Roll Clutch (brake)		
147008	Feed Roll Bracket Shaft Oil Retaining Wick	147139	Machine Pulley small rim diameter (disc power) "V" belt groove 2.9 in. diam., with two 51283(830)	<del>147399-011</del>	Feed Roll Clutch (brake) Bushing with two 453(830)		
147011	Arm Top Cover (back) for 147013			<del>147399-012</del>	Feed Roll Clutch (brake) Member Spring(3)		
147013	Arm Top Cover (back) with Stitch Regulator Plunger complete, Nos. 13288, 64519, 147011 and 147105			<del>147399-013</del>	Feed Roll Clutch (drive)	147	
147015	Arm Top Cover (back) Gasket						
<del>147017</del>	Feed Bar Carrier Oil Wick Holder with 143031						