

**SINGER**  
**195K**

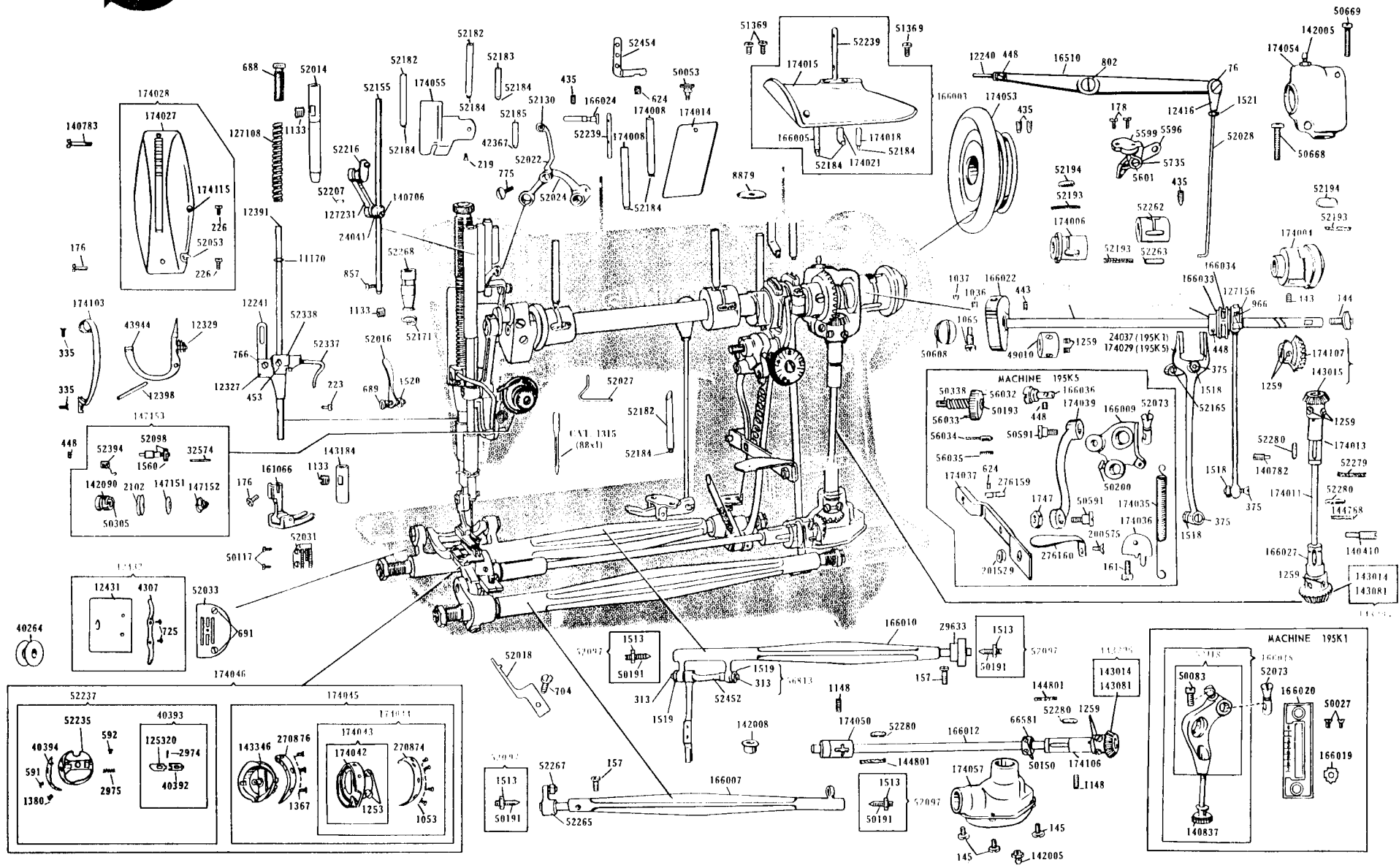

# SINGER 195k



\*A Trademark of THE SINGER MANUFACTURING COMPANY

THE SINGER MANUFACTURING COMPANY  
Copyright Under International Copyright Union

Form K6455 (861)  
Printed in Great Britain

## NUMERICAL LIST OF PARTS FOR 195K MACHINES

PART No.	DESCRIPTION	PART No.	DESCRIPTION	PART No.	DESCRIPTION	PART No.	DESCRIPTION
52280	Arm Shaft (upright) Bushing (lower) Oil Pad (felt)	166005	Arm Top Cover Oil Tube (long)	174107	Arm Shaft (horizontal) Bevel Gear	201529	Feed Reversing Lever Handle Screw Nut
52280	Arm Shaft (upright) Bushing (back) Oil Pad (felt)	166007	Feed Lifting Rock Shaft	174115	Face Plate Thread Guard (upper)	276159	Feed Reversing Lever Hinge Pin
52280	Arm Shaft (upright) Bushing (upper) Oil Pad (felt)	166010	Feed Rock Shaft	270874	Rotating Hook Thread Guard	276160	Feed Reversing Lever Handle
52280	Rotating Hook Shaft Bushing (front) Oil Pad (felt)	166012	Rotating Hook Shaft	270876	Rotating Hook Section		
52337	Slack Thread Regulator	166022	Needle Bar Crank				
52338	Presser Bar Guide Bracket	166024	Thread Take-up Lever Link Hinge Pin				
52394	Thread Take-up Spring	166027	Arm Shaft (upright) Bushing (lower)	SPECIAL TO 195K1 MACHINE			
52452	Feed Bar	166033	Feed and Feed Lifting Eccentric Retaining Ring	24037	Feed Forked Connection		
52454	Thread Retainer	166034	Feed and Feed Lifting Eccentric Sleeve	50027	Stitch Indicator Plate Screw		
56813	Feed Bar Screw Centre	174004	Arm Shaft (horizontal) Flanged Bushing (back)	50083	Feed Connecting Link Hinge Stud Set Screw		
66581	Rotating Hook Shaft Collar	174005	Arm Shaft (horizontal) Flanged Bushing (front)	52118	Feed Regulator		
125320	Rotating Hook Bobbin Case Latch Lever	174006	Arm Shaft (horizontal) Flanged Bushing (front)	140837	Feed Regulator Thumb Screw		
127108	Presser Bar Spring	174006	Arm Shaft (horizontal) Flanged Bushing (front)	166014	Arm Shaft (horizontal)		
127166	Feed Lifting Rock Shaft Connecting Rod	174008	Arm Shaft (horizontal) Bushing (intermediate) Oil Tube	166018	Feed Regulator		
127231	Needle Bar Connecting Link	174008	Arm Shaft (horizontal) Flanged Bushing (front) Oil Tube	166019	Stitch Indicator		
140410	Arm Shaft (upright) Bushing (lower) Set Screw	174008	Arm Shaft (horizontal) Flanged Bushing (front) Oil Tube	166020	Stitch Indicator Plate		
140708	Needle Bar Connecting Stud Clamping Screw	174011	Arm Shaft (upright)	166028	Feed and Feed Lifting Eccentric		
140782	Arm Shaft (upright) Bushing (upper) Set Screw	174012	Arm Shaft (upright) Bushing (upper)	SPECIAL TO 195K5 MACHINE			
140783	Face Plate Screw (upper)	174013	Arm Shaft (upright) Bushing (upper)	161	Feed Regulator Spring Bracket Screw		
142005	Arm Shaft (horizontal) Bevel Gear Case (upper) Grease Fitting	174014	Arm Side Cover	448	Feed Regulator Hinge Stud Set Screw		
142005	Rotating Hook Shaft Bevel Gear Case (lower) Grease Fitting	174015	Arm Top Cover	624	Feed Reversing Lever Hinge Pin Set Screw		
142008	Rotating Hook Shaft Bushing (front) Oil Cup	174018	Arm Top Cover Oil Tube (short)	1747	Feed Reversing Lever Connection Screw (lower) Nut		
142090	Thread Take-up Spring Regulator	174021	Arm Top Cover Oil Tube (bent)	50193	Feed Regulating Stud Head Cap Screw		
143014	Arm Shaft (upright) Bevel Gear (lower)	174027	Face Plate	50200	Feed Connecting Link Hinge Stud Set Screw		
143015	Arm Shaft (upright) Bevel Gear (upper)	174028	Face Plate, complete	50338	Feed Regulator Stud		
143081	Rotating Hook Shaft Bevel Gear	174042	Rotating Hook	50591	Feed Reversing Lever Connection Screw (lower)		
143184	Presser Bar Bushing (lower)	174043	Rotating Hook 174042 with two 1253	50591	Feed Reversing Lever Connection Screw (upper)		
143295	Set of Mated Gears (lower shaft) complete	174044	Rotating Hook 174043 with 270874 and four 1053	56032	Feed Regulating Stud Head		
143346	Rotating Hook Bobbin Case Holder	174045	Rotating Hook 174044 with 143346, 270876 and three 1367	56033	Feed Regulating Stud Head Stop Pin		
144768	Arm Shaft (upright) Bushing (lower) Oil Wick (braided cotton)	174046	Rotating Hook 174045 with 52237	56034	Feed Regulating Stud Lock Pin		
144801	Rotating Hook Shaft Bushing (back) Wick (braided cotton)	174050	Rotating Hook Shaft Bushing (front)	56035	Feed Regulating Stud Lock Pin Spring		
144801	Rotating Hook Shaft Bushing (front) Wick (braided cotton)	174051	Set of Mated Gears (upper shaft) (complete)	166002	Arm Shaft (horizontal)		
147151	Tension Releasing Disc	174053	Machine Pulley, "V" belt groove, (outside diam. of belt groove 2.9")	166009	Feed Regulator		
147152	Tension Spring	174054	Arm Shaft (horizontal) Bevel Gear Case (upper) (two pieces)	166030	Feed and Feed Lifting Eccentric		
147153	Tension, complete	174055	Arm Side Shield	166036	Feed Regulator Hinge Stud		
161066	Presser Foot (spring hinged) complete	174057	Rotating Hook Shaft Bevel Gear Case (lower) (two pieces)	174029	Feed Forked Connection		
166003	Arm Top Cover, complete	174103	Thread Take-up Lever Guard	174035	Feed Regulator Spring		
		174106	Rotating Hook Shaft Bushing (back)	174036	Feed Regulator Spring Bracket Hook		
				174037	Feed Reversing Lever		
				174039	Feed Reversing Lever Connection		
				200575	Feed Reversing Lever Handle Screw		

**NUMERICAL LIST OF PARTS FOR 195K MACHINES**

<b>PART No.</b>	<b>DESCRIPTION</b>	<b>PART No.</b>	<b>DESCRIPTION</b>	<b>PART No.</b>	<b>DESCRIPTION</b>	<b>PART No.</b>	<b>DESCRIPTION</b>
76	Knee Lifter Lifting Lever Connecting Rod Joint Hinge Screw	802	Knee Lifter Lifting Lever Hinge Screw	5601	Knee Lifter Bell Crank Hinge Pin	52097	Feed Lifting Rock Shaft Screw Centre
144	Arm Shaft (horizontal) Screw	857	Needle Set Screw	5735	Knee Lifter Bell Crank Spring	52097	Feed Rock Shaft Screw Centre Tension Stud
145	Rotating Hook Shaft Bevel Gear Case (lower) Screw	966	Feed Lifting Rock Shaft Connecting Rod Cap Screw	8879	Arm Spool Pin Washer (cloth)	52098	Thread Take-up Lever Thread Eyelet Bushing
157	Feed Lifting Rock Shaft Crank Clamping Screw	1036	Thread Take-up Crank Set Screw	11170	Presser Bar Spring Washer	52130	Needle Bar (hollow)
157	Feed Rock Shaft Crank Clamping Screw	1037	Thread Take-up Crank Position Screw	12240	Knee Lifter Lifting Lever Pin	52155	Feed Connecting Link
176	Presser Foot Screw	1053	Rotating Hook Thread Guard Screw	12241	Knee Lifter Lifting Lever Link	52165	Needle Bar Bushing (lower) Thread Eyelet
176	Face Plate Screw (lower)	1065	Needle Bar Crank Position Screw	12327	Presser Bar Lifting and Releasing Lever Bracket	52171	Arm Oil Tube
178	Knee Lifter Bell Crank Bracket Screw	1133	Needle Bar Bushing (lower) Set Screw	12329	Tension Releasing Lever Spring	52182	Arm Oil Tube
219	Arm Side Shield Screw	1133	Needle Bar Bushing (upper) Set Screw	12391	Presser Bar (hollow)	52183	Arm Oil Tube Packing (wick)
223	Slack Thread Regulator Set Screw	1133	Presser Bar Bushing (lower) Set Screw	12398	Tension Releasing Lever Hinge Pin	52184	Arm Shaft (horizontal) Bushing (intermediate) Oil Tube Packing (wick)
226	Face Plate Thread Guard (lower) Screw	1148	Rotating Hook Shaft Bushing (back) Set Screw	12416	Knee Lifter Lifting Lever Connecting Rod Joint	52184	Arm Shaft (horizontal) Flanged Bushing (front) Oil Tube Packing (wick)
226	Face Plate Thread Guard (upper) Screw	1148	Rotating Hook Shaft Bushing (front) Set Screw	12431	Bed Slide	52184	Arm Top Cover Oil Tube (bent) Packing (wick)
313	Feed Bar Screw Centre	1148	Rotating Hook Shaft Bushing (front) Set Screw	12432	Bed Slide, complete	52184	Arm Top Cover Oil Tube (long) Packing (wick)
335	Thread Take-up Lever Guard Screw	1253	Rotating Hook Set Screw	16510	Knee Lifter Lifting Lever	52184	Arm Top Cover Oil Tube (short) Packing (wick)
375	Feed Connecting Link Hinge Screw	1259	Arm Shaft (horizontal) Bevel Gear Set Screw	24041	Needle Bar Connecting Stud	52184	Arm Oil Tube (short)
375	Feed Forked Connection Hinge Screw	1259	Arm Shaft (horizontal) Collar Set Screw	29633	Feed Rock Shaft Crank Tension Releasing Pin	52185	Arm Shaft (horizontal) Bushing (intermediate) Oil Pad (braided cotton)
375	Feed Lifting Rock Shaft Connecting Rod Hinge Screw	1259	Arm Shaft (upright) Bevel Gear (lower) Set Screw	32574	Rotating Hook Bobbin	52193	Arm Shaft (horizontal) Flanged Bushing (back) Oil Pad (braided cotton)
435	Arm Shaft (horizontal) Bushing (intermediate) Set Screw	1259	Arm Shaft (upright) Bevel Gear (upper) Set Screw	40264	Rotating Hook Bobbin Case Latch	52193	Arm Shaft (horizontal) Flanged Bushing (front) Oil Pad (braided cotton)
435	Machine Pulley Set Screw	1259	Rotating Hook Shaft Bevel Gear Set Screw	40392	Rotating Hook Bobbin Case	52194	Arm Shaft (horizontal) Flanged Bushing (back) Oil Pad (felt)
435	Thread Take-up Lever Hinge Pin Set Screw	1367	Rotating Hook Section Screw	40393	Rotating Hook Bobbin Case Hinge, complete	52194	Arm Shaft (horizontal) Flanged Bushing (front) Oil Pad (felt)
443	Arm Shaft (horizontal) Flanged Bushing (back) Set Screw	1380	Rotating Hook Bobbin Case Tension Spring Screw	40394	Rotating Hook Bobbin Case Tension Spring	52207	Needle Bar Connecting Link Lubricating Pad (wood)
443	Arm Shaft (horizontal) Flanged Bushing (front) Set Screw	1513	Feed Lifting Rock Shaft Screw Centre Nut	42367	Arm Oil Tube Packing (braided cotton)	52216	Thread Take-up Crank
448	Feed and Feed Lifting Eccentric Set Screw	1513	Feed Rock Shaft Screw Centre Nut	43944	Tension Releasing Lever	52235	Rotating Hook Bobbin Case
448	Thread Take-up Spring Regulator Set Screw	1518	Feed Connecting Link Hinge Screw Nut	49010	Arm Shaft (horizontal) Collar	52237	Rotating Hook Bobbin Case, complete
448	Knee Lifter Lifting Lever Pin Set Screw	1518	Feed Forked Connection Hinge Screw Nut	50053	Arm Side Cover Thumb Screw	52239	Arm Spool Pin and Thread Eyelet
453	Presser Bar Guide Bracket Set Screw	1518	Feed Lifting Rock Shaft Connecting Rod Hinge Screw Nut	50117	Feed Dog Screw	52239	Arm Top Cover Spool Pin and Thread Eyelet
591	Rotating Hook Bobbin Case Tension Regulating Screw	1519	Feed Bar Screw Centre Nut	50150	Rotating Hook Shaft Collar Screw	52262	Arm Shaft (horizontal) Bushing (intermediate)
592	Rotating Hook Bobbin Case Latch Stop Screw	1520	Presser Bar Lifter Screw Nut	50191	Feed Lifting Rock Shaft Screw Centre	52263	Arm Shaft (horizontal) Bushing (intermediate) Oil Pad (felt)
624	Thread Retainer Set Screw	1521	Knee Lifter Lifting Lever Connecting Rod Lock Nut	50191	Feed Rock Shaft Screw Centre	52265	Feed Lifting Rock Shaft Crank
688	Pressure Regulating Thumb Screw	1560	Tension Regulating Thumb Nut	50305	Tension Stud Set Screw	52267	Feed Lifting Rock Shaft Crank Slide Block
689	Presser Bar Lifter Screw	2102	Tension Disc	50608	Arm Pin Plug Screw (back)	52268	Needle Bar Bushing (lower)
691	Throat Plate Screw	2974	Rotating Hook Bobbin Case Latch Lever Fulcrum Pin	50668	Arm Shaft (horizontal) Bevel Gear Case (upper) Screw	52279	Arm Shaft (upright) Bushing (upper) Oil Wick (braided cotton)
704	Rotating Hook Bobbin Case Holder Position Bracket Screw	2975	Rotating Hook Bobbin Case Latch Spring	51369	Arm Top Cover Screw		
725	Bed Slide Spring Screw	4307	Bed Slide Spring	52014	Needle Bar Bushing (upper)		
768	Knee Lifter Lifting Lever Link Hinge Screw	5596	Knee Lifter Bell Crank	52016	Presser Bar Lifter		
775	Needle Bar Connecting Link Cap Screw	5599	Knee Lifter Bell Crank Bracket	52018	Rotating Hook Bobbin Case Holder Position Bracket		
				52022	Thread Take-up Lever		
				52024	Thread Take-up Lever Link		
				52027	Thread Guard (side of arm)		
				52028	Knee Lifter Lifting Lever Connecting Rod		
				52031	Feed Dog		
				52033	Throat Plate (small needle hole)		
				52053	Face Plate Thread Guard (lower)		
				52073	Feed Connecting Link Hinge Stud		