

SINGER

421W301BA,303BA,307BA,311BA

Parts
List

Odellene

SINGER
INDUSTRIAL PRODUCTS

*Spring to take out plug
on button sewer clamp
136961 spring
1241 screw*

421W301BA

421W303BA

421W307BA

421W311BA

**LIST OF PARTS COMPLETE
FOR
MACHINE NO. 421W307BA**

For sewing two- or four-hole flat buttons (size 13 ligne through 50 ligne) and snap fasteners (size 0 through 000) with 16 stitches. The work clamp moves alternately back and forth lengthwise of the cylinder.

| No. | Plate | Description | No. | Plate | Description |
|-------------|---------|--|-------------|---------|---|
| | | | 175065 | 7201-2 | Arm Cover (front) Thread Guide Roller Pin..... |
| | | | 223710 | 7201-2 | Arm Cover (front) Thread Retainer with 200397(833)..... |
| | | | 185(809) | 7201-2 | Arm Cover (front) Thread Retainer Screw (2)..... |
| | | | 136818 | 7201-2 | Arm Cover (front) Thread Retainer Screw Washer (2)..... |
| | | | 210993 | 7201-2 | Arm Cover (front) Thread Retainer Sleeve..... |
| | | | 223844 | 7201-2 | Arm Cover (front) Thread Retainer Spring..... |
| | | | 210957 | 7201-2 | Arm Cover (front) Thread Retainer Stud..... |
| | | | 210958 | 7201-2 | Arm Cover (front) Thread Retainer Stud Collar..... |
| | | | 200397(833) | 7201-2 | Arm Cover (front) Thread Retainer Stud Set Screw..... |
| | | | 223711 | 7201-2 | Arm Cover (front) Thread Retainer complete, Nos. 210957, 210958, 210993, 223710 and 223844 |
| | | | 239223-451 | 7201-1 | Arm Cover (side)..... |
| | | | 141060(819) | 7201-1 | Arm Cover (side) Screw (4)..... |
| | | | 136846 | ----- | Arm Plug (right)..... |
| | | | 998(830) | ----- | Arm Plug (right) Set Screw..... |
| | | | 16532 | 7201-19 | Arm Position Pin (2)..... |
| | | | 141069(869) | 7201-19 | Arm Screw (3)..... |
| | | | 136861 | ----- | Arm Shaft (horizontal) with 23477 |
| | | | 136792 | 7201-3 | Arm Shaft (horizontal) Bevel Gear with two 141469(869)..... |
| | | | 141469(869) | 7201-3 | Arm Shaft (horizontal) Bevel Gear Set Screw (2)..... |
| | | | 167012 | 7201-3 | Arm Shaft (horizontal) Bushing (back)..... |
| | | | 167013 | 7201-3 | Arm Shaft (horizontal) Bushing (back) 167012 with 53618(805), 141128(833), 202299, 239374 and two 239383..... |
| | | | 202299 | 7201-3 | Arm Shaft (horizontal) Bushing (back) Oil Packing (wick)..... |
| | | | 141061(803) | 7201-3 | Arm Shaft (horizontal) Bushing (back) Set Screw..... |
| | | | 141128(833) | 7201-3 | Arm Shaft (horizontal) Bushing (back) Support Screw..... |
| | | | 53618(805) | 7201-3 | Arm Shaft (horizontal) Bushing (back) Support Screw Lock Nut.... |
| | | | 167049 | 7201-3 | Arm Shaft (horizontal) Bushing (center)..... |
| | | | 223847 | 7201-3 | Arm Shaft (horizontal) Bushing (center) Oil Packing (wick)..... |
| | | | 141076(830) | 7201-3 | Arm Shaft (horizontal) Bushing (center) Set Screw..... |
| 167330 | 7201-12 | Adjusting Device complete, Nos. 1654(803), 2018, 141550(803), 167329, 239533, 239534, 239536, two each 1620(905), 53626(803), 141545(803), 167335, 167449, 350812-869, and three each 167459 and 202622..... | | | |
| 239221 | 7201-1 | Arm Cover (center)..... | | | |
| 140082(819) | 7201-1 | Arm Cover (center) Screw (2)..... | | | |
| 136806 | 7201-2 | Arm Cover (front)..... | | | |
| 136858 | 7201-2 | Arm Cover (front) complete, Nos. 230(805), 136806, 136888, 140438(819), 175062, 175063, 175065, 202098, 223711, 228739, two each 185(809) and 136818..... | | | |
| 792(819) | 7201-2 | Arm Cover (front) Screw (2)..... | | | |
| 228739 | 7201-2 | Arm Cover (front) Thread Eyelet.. | | | |
| 136888 | 7201-2 | Arm Cover (front) Thread Guide (wire)..... | | | |
| 140438(819) | 7201-2 | Arm Cover (front) Thread Guide (wire) Screw..... | | | |
| 175062 | 7201-2 | Arm Cover (front) Thread Guide Plate..... | | | |
| 230(805) | 7201-2 | Arm Cover (front) Thread Guide Plate Screw..... | | | |
| 175063 | 7201-2 | Arm Cover (front) Thread Guide Plate Screw Spacing Collar..... | | | |
| 202098 | 7201-2 | Arm Cover (front) Thread Guide Roller..... | | | |

| No. | Plate | Description | No. | Plate | Description |
|-----------|--------|---|-------------|--------|--|
| 239228 | 7201-3 | Arm Shaft (horizontal) Bushing (front)..... | 650(803) | 7201-7 | Button Clamp Guiding Screw (2 Hole Buttons)..... |
| 223847 | 7201-3 | Arm Shaft (horizontal) Bushing (front) Oil Packing (wick)..... | 136802 | 7201-7 | Button Clamp Guiding Screw (2 Hole Buttons) Drag Spring..... |
| 59704 | 7201-3 | Arm Shaft (upright)..... | 136898 | 7201-7 | Button Clamp Guiding Screw (2 Hole Buttons) Guide Block..... |
| 136719 | 7201-3 | Arm Shaft (upright) 59704 with 59707 and 59708..... | 792(819) | 7201-7 | Button Clamp Guiding Screw (2 Hole Buttons) Guide Block Fastening Screw (2)..... |
| 59707 | 7201-3 | Arm Shaft (upright) Bevel Gear (lower) with two 1253(830)..... | 136827 | 7201-7 | Button Clamp Guiding Screw (2 Hole Buttons) Holder..... |
| 1253(830) | 7201-3 | Arm Shaft (upright) Bevel Gear (lower) Set Screw (2)..... | 136828 | 7201-7 | Button Clamp Guiding Screw (2 Hole Buttons) Stop..... |
| 59708 | 7201-3 | Arm Shaft (upright) Bevel Gear (upper) with two 1253(830)..... | 1175(850) | 7201-7 | Button Clamp Hinge Screw (2)..... |
| 1253(830) | 7201-3 | Arm Shaft (upright) Bevel Gear (upper) Set Screw (2)..... | 239211 | 7201-4 | Clamp Lifting Bar with 176(819)... |
| 136793 | 7201-3 | Arm Shaft (upright) Bushing (lower)..... | 239212 | 7201-4 | Clamp Lifting Bar Bushing (lower). |
| 136794 | 7201-3 | Arm Shaft (upright) Bushing (upper)..... | 239213 | 7201-4 | Clamp Lifting Bar Position Guide with 167007, 200072(803) and 239515..... |
| 167017 | 7201-3 | Arm Shaft (upright) Hole Cover... | 200072(803) | 7201-4 | Clamp Lifting Bar Position Guide Clamping Screw..... |
| 136598 | 7201-5 | Button Clamp (left) with 17723, 45329 and three 36696..... | 350799(819) | 7201-4 | Clamp Lifting Bar Pressure Regulating Screw..... |
| 167317 | 7201-5 | Button Clamp (left) Adjusting Spring..... | 239214 | 7201-4 | Clamp Lifting Bar Spring..... |
| 36696 | 7201-5 | Button Clamp (left) Pad Pin (3).. | 141061(803) | 7201-4 | Clamp Lifting Bar Stop Screw..... |
| 17723 | 7201-5 | Button Clamp (left) Screw Stud... | 1662(805) | 7201-4 | Clamp Lifting Bar Stop Screw Nut.. |
| 136600 | 7201-5 | Button Clamp (left) Spring..... | 167004 | 7201-4 | Clamp Lifting Rock Shaft with 141059(830)..... |
| 45329 | 7201-5 | Button Clamp (left) Spring Position Pin..... | 259470 | 7201-4 | Clamp Lifting Rock Shaft Collar with 201188(803)..... |
| 230(819) | 7201-5 | Button Clamp (left) Spring Screw. | 201188(803) | 7201-4 | Clamp Lifting Rock Shaft Collar Set Screw..... |
| 136601 | 7201-5 | Button Clamp (right) with 17723, 45329 and three 36696..... | 167277 | 7201-4 | Clamp Lifting Rock Shaft Collar (knurled) with 465(830)..... |
| 167319 | 7201-5 | Button Clamp (right) Adjusting Spring..... | 465(830) | 7201-4 | Clamp Lifting Rock Shaft Collar (knurled) Set Screw..... |
| 36696 | 7201-5 | Button Clamp (right) Pad Pin (3). | 167278 | 7201-4 | Clamp Lifting Rock Shaft Collar (knurled) Spring..... |
| 17723 | 7201-5 | Button Clamp (right) Screw Stud.. | 167006 | 7201-4 | Clamp Lifting Rock Shaft Lifting Arm with 350604(869)..... |
| 136603 | 7201-5 | Button Clamp (right) Spring..... | 350604(869) | 7201-4 | Clamp Lifting Rock Shaft Lifting Arm Clamping Screw..... |
| 45329 | 7201-5 | Button Clamp (right) Spring Position Pin..... | 167007 | 7201-4 | Clamp Lifting Rock Shaft Lifting Link..... |
| 230(819) | 7201-5 | Button Clamp (right) Spring Screw | 239218 | 7201-4 | Clamp Lifting Rock Shaft Lifting Link Connection..... |
| 167320 | 7201-5 | Button Clamp Arm with 17714..... | 141059(830) | 7201-4 | Clamp Lifting Rock Shaft Lifting Link Connection Screw..... |
| 167321 | 7201-5 | Button Clamp Arm complete, Nos. 202(819), 1182(819), 167320 and 167322..... | 239515 | 7201-4 | Clamp Lifting Rock Shaft Lifting Link Hinge Pin..... |
| 17710 | 7201-7 | Clamp Arm Hinge Plate..... | 124733 | 7201-5 | Button Clamp Opening Lever..... |
| 1176(819) | 7201-7 | Clamp Arm Hinge Plate Screw..... | 167323 | 7201-5 | Button Clamp Opening Lever Bracket |
| 167322 | 7201-5 | Clamp Arm Hook with 63825..... | | | |
| 202(819) | 7201-5 | Clamp Arm Hook Screw (left)..... | | | |
| 1182(819) | 7201-5 | Clamp Arm Hook Screw (right)..... | | | |
| 63825 | 7201-5 | Clamp Arm Hook Stud..... | | | |
| 136890 | 7201-4 | Clamp Foot Lifter..... | | | |
| 176(819) | 7201-4 | Clamp Foot Lifter Screw..... | | | |

| No. | Plate | Description | No. | Plate | Description |
|-------------|--------|---|-------------|---------|---|
| 1182(819) | 7201-5 | Button Clamp Opening Lever Bracket Screw (2)..... | 167325 | 7201-5 | Button Clamp complete, Nos. 99(819), 202(819), 1181(819), 1183(819), 1199(819), 39242, 50237(833), 63741, 124733, 124737, 124738, 124739, 136598, 136600, 136601, 136603, 136608, 167317, 167319, 167320, 167322, 167323, 167324, two each 230(819), 1175(850), 17718 and four 1184(819)..... |
| 124735 | 7201-4 | Clamp Opening Lever Contact Piece | 127470 | ----- | Button Clamp complete for 13 to 50 Ligne Thin Buttons (Optional Equip.) |
| 239123 | 7201-4 | Clamp Opening Lever Contact Piece Arm..... | 141066(803) | 7201-19 | Cylinder Base Locating Screw (4)... |
| 50117(833) | 7201-4 | Clamp Opening Lever Contact Piece Arm Screw..... | 141067(805) | 7201-19 | Cylinder Base Locking Screw..... |
| 1484(809) | 7201-4 | Clamp Opening Lever Contact Piece Screw..... | 136854 | 7201-1 | Cylinder Cover (bottom)..... |
| 17718 | 7201-4 | Clamp Opening Lever Contact Piece Screw Washer..... | 141140(819) | 7201-1 | Cylinder Cover (bottom) Screw (2)... |
| 99(819) | 7201-5 | Button Clamp Opening Lever Hinge Screw..... | 239533 | 7201-12 | Cylinder Cover (side)..... |
| 39241 | 7201-7 | Button Clamp Pressure Spring..... | 1454(830) | 7201-12 | Cylinder Cover (side) Screw (2)... |
| 239572 | 7201-7 | Clamp Pressure Spring Bracket..... | 136899 | 7201-7 | Cylinder Cover Plate (top)..... |
| 1177(819) | 7201-7 | Clamp Pressure Spring Bracket Screw..... | 691(819) | 7201-7 | Cylinder Cover Plate (top) Screw (5)..... |
| 17714 | 7201-5 | Clamp Pressure Spring Guide Block | 16532 | 7201-19 | Cylinder Position Pin (2)..... |
| 141211(869) | 7201-7 | Clamp Pressure Spring Screw..... | 141069(869) | 7201-19 | Cylinder Screw (2)..... |
| 39242 | 7201-5 | Button Clamp Spreader..... | 136863 | 7201-18 | Feed Cam with two 167234 and four each 140352(830) and 167235..... |
| 124737 | 7201-5 | Button Clamp Spreader Lever..... | 350600(869) | 7201-18 | Feed Cam Mounting Screw (3)..... |
| 124738 | 7201-5 | Button Clamp Spreader Lever Adjusting Plate..... | 210805 | 7201-18 | Feed Cam Mounting Screw Washer (3) |
| 1182(819) | 7201-5 | Button Clamp Spreader Lever Adjusting Plate Screw..... | 239522 | 7201-17 | Feed Cam Supporting Gear with 239245..... |
| 17718 | 7201-5 | Button Clamp Spreader Lever Adjusting Plate Screw Washer..... | 167050 | 7201-17 | Feed Cam Supporting Gear Bracket.. |
| 124739 | 7201-5 | Button Clamp Spreader Lever Stop.. | 141069(869) | 7201-17 | Feed Cam Supporting Gear Bracket Screw..... |
| 50237(833) | 7201-5 | Button Clamp Spreader Lever Stop Position Screw..... | 202005 | 7201-17 | Feed Cam Supporting Gear Bracket Washer..... |
| 1182(819) | 7201-5 | Button Clamp Spreader Lever Stop Screw..... | 239245 | 7201-17 | Feed Cam Supporting Gear Cam Locating Pin..... |
| 17718 | 7201-5 | Button Clamp Spreader Lever Stop Screw Washer..... | 141070(803) | 7201-17 | Feed Cam Supporting Gear Screw.... |
| 167324 | 7201-5 | Button Clamp Spreader Spring..... | 167234 | 7201-18 | Feed Cam Tripping Point (2) (NOTE: For 421W301 (4)..... |
| 1181(819) | 7201-5 | Button Clamp Spreader Spring Screw Stud..... | 140352(830) | 7201-18 | Feed Cam Tripping Point Screw (4) (NOTE: For 421W301 (8)..... |
| 63742 | 7201-5 | Button Clamp Spreader Steady Pin (long)..... | 167235 | 7201-18 | Feed Cam Tripping Point Screw Washer (4) (NOTE: For 421W301 (8)... |
| 17720 | 7201-5 | Button Clamp Spreader Steady Pin (short)..... | 136893 | 7201-7 | Feed Plate..... |
| 63741 | 7201-5 | Button Clamp Spreader Thumb Plate | 167029 | 7201-7 | Feed Plate Carrier Bar..... |
| 1199(819) | 7201-5 | Button Clamp Spreader Thumb Plate Screw..... | 136904 | 7201-7 | Feed Plate Carrier Bar 167029 with 136899, 141071(819), and 167055... |
| 136608 | 7201-5 | Button Clamp Stop with 17720 and 63742..... | 167054 | 7201-7 | Feed Plate Carrier Bar Driving Block with 239501..... |
| 1183(819) | 7201-5 | Button Clamp Stop Screw..... | 167055 | 7201-7 | Feed Plate Carrier Bar Driving Block complete, Nos. 167054 and 167056..... |
| | | | 239250 | 7201-7 | Feed Plate Carrier Bar Driving Block Oscillating Slide Stud..... |

| No. | Plate | Description | No. | Plate | Description |
|-------------|--------|---|-------------|---------|--|
| 239501 | 7201-7 | Feed Plate Carrier Bar Driving Block Pin..... | 190(805) | 7201-8 | Knife Driving Bar Stop (in bracket) Screw (2)..... |
| 141071(819) | 7201-7 | Feed Plate Carrier Bar Driving Block Screw..... | 136892 | 7201-8 | Knife Driving Bar Stop (nylon)... |
| 167056 | 7201-7 | Feed Plate Carrier Bar Driving Block Spacer..... | 140049(805) | 7201-8 | Knife Driving Bar Stop Screw..... |
| 239448 | 7201-7 | Feed Plate Carrier Bar Driving Block Spacer Position Pin (2).... | 136823 | 7201-8 | Knife Holder..... |
| 136907 | 7201-8 | Knife (thread cutting)..... | 50018(806) | 7201-8 | Knife Holder Screw..... |
| 136908 | 7201-8 | Knife (thread cutting) Mounting Fork..... | 1547(803) | 7201-8 | Knife Holder Screw Nut..... |
| 1034(805) | 7201-8 | Knife (thread cutting) Screw.... | 59739 | 7201-8 | Knife Holder Stud..... |
| 136820 | 7201-8 | Knife Cocking Lever with 769(850) and 1698(805)..... | 239534 | 7201-12 | Lateral Adjusting Lever..... |
| 136815 | 7201-8 | Knife Cocking Lever Multiplier with 1226(803)..... | 141545(803) | 7201-12 | Lateral Adjusting Lever Hinge Screw..... |
| 350805(803) | 7201-8 | Knife Cocking Lever Multiplier Hinge Screw..... | 167459 | 7201-12 | Lateral Adjusting Lever Hinge Screw Friction Washer..... |
| 140159(830) | 7201-8 | Knife Cocking Lever Screw (2).... | 1620(805) | 7201-12 | Lateral Adjusting Lever Hinge Screw Nut..... |
| 175175 | 7201-8 | Knife Cocking Lever Screw Washer (2)..... | 202622 | 7201-12 | Lateral Adjusting Lever Hinge Screw Nut Washer |
| 136821 | 7201-8 | Knife Driver (adjustable)..... | 2018 | 7201-12 | Lateral Adjusting Lever Spacing Washer..... |
| 207(805) | 7201-8 | Knife Driver (adjustable) Screw (2)..... | 136824 | 7201-10 | Lateral Pivot and Feed Plate Carrier Bar Connecting Arm..... |
| 136857 | 7201-8 | Knife Driving Bar..... | 136826 | 7201-10 | Lateral Feed Throw-out Collar.... |
| 136894 | 7201-8 | Knife Driving Bar Bumper (Nylon). | 350800(869) | 7201-10 | Lateral Feed Throw-out Collar Positioning Screw (3)..... |
| 1289(819) | 7201-8 | Knife Driving Bar Bumper Screw... | 149797 | 7201-10 | Lateral Feed Throw-out Collar Retaining Ring..... |
| 136895 | 7201-8 | Knife Driving Bar Bumper Screw Nut..... | 350802(830) | 7201-10 | Lateral Feed Throw-out Screw.... |
| 7071 | 7201-8 | Knife Driving Bar Bumper Screw washer..... | 214529 | 7201-10 | Lateral Feed Throw-out Screw Drag Spring..... |
| 136896 | 7201-8 | Knife Driving Bar Bumper Complete, Nos. 1289(819), 7071, 136894 and 136895..... | 136829 | 7201-10 | Lateral Pivot Driving Arm..... |
| 136816 | 7201-8 | Knife Driving Bar Latch with 171(819) and 51701(819)..... | 136830 | 7201-10 | Lateral Pivot Driving Arm 136829 with 1519(805), 136826, 141075(803), 214529, 239266, 350802(830) and three 350800(869). |
| 350805(803) | 7201-8 | Knife Driving Bar Latch Hinge Screw..... | 239264 | 7201-11 | Lateral Rock Shaft..... |
| 136868 | 7201-8 | Knife Driving Bar Latch Spring... | 239160 | 7201-11 | Lateral Rock Shaft 239264 with 51951..... |
| 1226(803) | 7201-8 | Knife Driving Bar Latch Spring Stud Screw (lower)..... | 51951 | 7201-11 | Lateral Rock Shaft Cam Follower |
| 171(819) | 7201-8 | Knife Driving Bar Latch Spring Stud Screw (upper)..... | 1655(803) | 7201-21 | Roller and Screw Stud, Nos. 1655(803), 5968 and 37310..... |
| 51701(819) | 7201-8 | Knife Driving Bar Latch Spring Stud Screw (upper) Lock Nut..... | 37310 | 7201-11 | Lateral Rock Shaft Cam Follower |
| 769(850) | 7201-8 | Knife Driving Bar Latch Tripping Screw..... | 5968 | 7201-21 | Roller Screw Stud Nut..... |
| 1698(805) | 7201-8 | Knife Driving Bar Latch Tripping Screw Nut..... | 167416 | 7201-11 | Lateral Rock Shaft Cam Follower Roller Screw Stud Nut Washer.... |
| 136801 | 7201-8 | Knife Driving Bar Spring..... | 140321(830) | 7201-11 | Lateral Rock Shaft Cam Follower Roller Washer..... |
| 1226(803) | 7201-8 | Knife Driving Bar Spring Stud Screw (2)..... | 239265 | 7201-11 | Lateral Rock Shaft Collar with two 140321(830)..... |
| 136856 | 7201-8 | Knife Driving Bar Stop (in bracket)..... | 239266 | 7201-10 | Lateral Rock Shaft Collar Set Screw (2)..... |
| | | | 239266 | 7201-10 | Lateral Rock Shaft Driven Arm.... |
| | | | | 7201-21 | Lateral Rock Shaft Driven Arm Driving Link..... |

350820
New #

| No. | Plate | Description | No. | Plate | Description |
|-------------|---------|---|-------------|---------|--|
| 141075(803) | 7201-10 | Lateral Rock Shaft Driven Arm | 1655(803) | 7201-11 | Longitudinal Rock Shaft Cam Follower Roller Screw Stud Nut..... |
| | 7201-21 | Driving Link Screw..... | 37310 | 7201-11 | Longitudinal Rock Shaft Cam Follower Roller Screw Stud Nut Washer..... |
| 1519(805) | 7201-10 | Lateral Rock Shaft Driven Arm | | | |
| | 7201-21 | Driving Link Screw Nut..... | | | |
| 239267 | 7201-11 | Lateral Rock Shaft Driven Arm Hinge Stud with 202423..... | 167416 | 7201-11 | Longitudinal Rock Shaft Collar with two 140321(830) |
| 202423 | 7201-11 | Lateral Rock Shaft Driven Arm Hinge Stud Oil Packing (wick).... | 140321(830) | 7201-11 | Longitudinal Rock Shaft Collar Set Screw (2)..... |
| 141076(830) | 7201-11 | Lateral Rock Shaft Driven Arm Hinge Stud Set Screw..... | 239265 | 7201-11 | Longitudinal Rock Shaft Driven Arm |
| 239623 | 7201-11 | Lateral Rock Shaft Driving Arm with 350604(869)..... | 239267 | 7201-11 | Longitudinal Rock Shaft Driven Arm Hinge Stud with 202423..... |
| 350604(869) | 7201-11 | Lateral Rock Shaft Driving Arm Clamping Screw..... | 202423 | 7201-11 | Longitudinal Rock Shaft Driven Arm Hinge Stud Oil Packing (wick) |
| 167335 | 7201-12 | Lateral Rock Shaft Driving Arm Screw Stud..... | 141076(830) | 7201-11 | Longitudinal Rock Shaft Driven Arm Hinge Stud Set Screw..... |
| 239574 | 7201-11 | Lateral Rock Shaft Driving Arm Screw Stud Guide Block..... | 239623 | 7201-11 | Longitudinal Rock Shaft Driving Arm with 350604(869)..... |
| 350812(869) | 7201-12 | Lateral Rock Shaft Driving Arm Screw Stud Locking Screw..... | 350604(869) | 7201-11 | Longitudinal Rock Shaft Driving Arm Clamping Screw..... |
| 53626(803) | 7201-12 | Lateral Rock Shaft Driving Arm Screw Stud Nut..... | 167335 | 7201-12 | Longitudinal Rock Shaft Driving Arm Screw Stud..... |
| 167449 | 7201-12 | Lateral Rock Shaft Driving Arm Screw Stud Nut Washer..... | 239574 | 7201-11 | Longitudinal Rock Shaft Driving Arm Screw Stud Guide Block..... |
| 167329 | 7201-12 | Longitudinal Adjusting Lever.... | 350812(869) | 7201-12 | Longitudinal Rock Shaft Driving Arm Screw Stud Locking Screw..... |
| 239536 | 7201-12 | Longitudinal Adjusting Lever Handle..... | 53626(803) | 7201-12 | Longitudinal Rock Shaft Driving Arm Screw Stud Nut..... |
| 141545(803) | 7201-12 | Longitudinal Adjusting Lever Handle Hinge Screw..... | 167449 | 7201-12 | Longitudinal Rock Shaft Driving Arm Screw Stud Nut Washer..... |
| 167459 | 7201-12 | Longitudinal Adjusting Lever Handle Hinge Screw Friction Washer..... | 136618 | 7201-3 | Looper..... |
| 1620(805) | 7201-12 | Longitudinal Adjusting Lever Handle Hinge Screw Nut..... | 50150(830) | 7201-3 | Looper Set Screw..... |
| 202622 | 7201-12 | Longitudinal Adjusting Lever Handle Hinge Screw Nut Washer.... | 136831 | 7201-3 | Looper Shaft with 50150(830)..... |
| 202622 | 7201-12 | Longitudinal Adjusting Lever Handle Spacing Washer..... | 59707 | 7201-3 | Looper Shaft Bevel Gear with two... 1253(830)..... |
| 141550(803) | 7201-12 | Longitudinal Adjusting Lever Hinge Screw..... | 1253(830) | 7201-3 | Looper Shaft Bevel Gear Set Screw . (2)..... |
| 167459 | 7201-12 | Longitudinal Adjusting Lever Hinge Screw Friction Washer..... | 124764 | 7201-3 | Looper Shaft Bushing (front)..... |
| 1654(803) | 7201-12 | Longitudinal Adjusting Lever Hinge Screw Nut..... | 440(830) | 7201-3 | Looper Shaft Bushing (front) Set Screw..... |
| 239384 | 7201-11 | Longitudinal Rock Shaft (driving) | 136807 | 7201-3 | Looper Shaft Bushing (rear)..... |
| 239144 | 7201-11 | Longitudinal Rock Shaft (driving) 239384 with 51951..... | 440(830) | 7201-3 | Looper Shaft Bushing (rear) Set Screw..... |
| 51951 | 7201-11 | Longitudinal Rock Shaft Cam Follower Roller and Stud. Nos. 1655(803), 5968 and 37310..... | 239317 | 7201-15 | Machine Pulley (loose)..... |
| 5968 | 7201-11 | Longitudinal Rock Shaft Cam Follower Roller Washer..... | 239318 | 7201-15 | Machine Pulley (loose) 239317 with 239322..... |
| | | | 239379 | 7201-15 | Machine Pulley (loose) Engaging Arm with 239320, 239321 and 350600(869) |
| | | | 350600(869) | 7201-15 | Machine Pulley (loose) Engaging Arm Clamping Screw..... |
| | | | 167084 | 7201-15 | Machine Pulley (loose) Engaging Arm Stud..... |

| No. | Plate | Description | No. | Plate | Description |
|-------------|---------|---|--------------|---------|---|
| 1513(819) | 7201-15 | Machine Pulley (loose) Engaging Arm Stud Lock Nut..... | 160(805) | 7201-6 | Needle Bar Take-up Clamping Screw.. |
| 239320 | 7201-15 | Machine Pulley (loose) Engaging Arm Wear Block..... | 136847 | 7201-6 | Needle Bar Take-up complete, Nos. 1492(819), 136848, 175100 and 175101..... |
| 239321 | 7201-15 | Machine Pulley (loose) Engaging Arm Wear Block Pin..... | 175100 | 7201-6 | Needle Bar Take-up Thread Guide Plate..... |
| 239322 | 7201-15 | Machine Pulley (loose) Needle Bearing..... | 175101 | 7201-6 | Needle Bar Take-up Thread Guide Plate Roller..... |
| 239315 | 7201-3 | Machine Pulley (loose) Retaining Ring..... | 1492(819) | 7201-6 | Needle Bar Take-up Thread Guide Plate Screw..... |
| 239524 | 7201-15 | Machine Pulley (loose) Starting Cap..... | 239376 | 7201-6 | Needle Bar Thread Guide..... |
| 239525 | 7201-15 | Machine Pulley (loose) Starting Cap Needle Button..... | 50169(819) | 7201-6 | Needle Bar Thread Guide Screw..... |
| 239526 | 7201-15 | Machine Pulley (loose) Starting Cap Needle Thrust Bearing..... | 136842 | 7201-3 | Needle Guide complete with Thread Finger, Nos. 136889, 175131 and two 218(804)..... |
| 239382 | 7201-15 | Machine Pulley (loose) Starting Cap Needle Plate..... | 136622 | 7201-3 | Needle Guide Cam with two 195(803). |
| 239486-001 | 7201-15 | Machine Pulley (tight)..... | 195(803) | 7201-3 | Needle Guide Cam Set Screw (2).... |
| 239314 | 7201-3 | Machine Pulley (tight) Key..... | 136909 | 7201-3 | Needle Guide Oscillating Crank with 1057(830) and 51933..... |
| 239374 | 7201-3 | Machine Pulley (tight) Needle Thrust Bearing..... | 1057(830) | 7201-3 | Needle Guide Oscillating Crank Clamping Screw..... |
| 239383 | 7201-3 | Machine Pulley (tight) Needle Thrust Bearing Washer (2)..... | 51933 | 7201-3 | Needle Guide Oscillating Crank Roller and Stud..... |
| 239315 | 7201-3 | Machine Pulley (tight) Retaining Ring..... | 175131 | 7201-3 | Needle Guide Pin..... |
| 167086 | 7201-6 | Needle Bar..... | 136808 | 7201-3 | Needle Guide Shaft Bushing..... |
| 167087 | 7201-6 | Needle Bar 167086 with 209(833), 50169(819) and 239376..... | 440(830) | 7201-3 | Needle Guide Shaft Bushing Set Screw..... |
| 239273 | 7201-6 | Needle Bar Bushing (lower)..... | 136889 | 7201-3 | Needle Guide Thread Finger..... |
| 136795 | 7201-6 | Needle Bar Bushing (upper)..... | 218(804) | 7201-3 | Needle Guide Thread Finger Screw (2)..... |
| 271597 | 7201-6 | Needle Bar Connecting Link..... | 209(833) | 7201-6 | Needle Set Screw..... |
| 167088 | 7201-6 | Needle Bar Connecting Link 271597 with 50650(803), 167089-001 and 239385..... | 136809 | -- | Pair of Gears, for upper Shaft, Nos. 59708 and 136792..... |
| 50650(803) | 7201-6 | Needle Bar Connecting Link Cap Screw..... | 167143 | 7201-9 | Starting Bell Crank..... |
| 239385 | 7201-6 | Needle Bar Connecting Link Crank... | 167144 | 7201-9 | Starting Bell Crank 167143 with 51657(803), 53617(805), 167154 and 167155..... |
| 350812(869) | 7201-3 | Needle Bar Connecting Link Crank Set Screw (2)..... | 141450(803)) | 7201-9 | Starting Bell Crank Hinge Screw.... |
| 167089-001 | 7201-6 | Needle Bar Connecting Stud with 175(830) and 239277..... | 1662(805) | 7201-9 | Starting Bell Crank Hinge Screw Nut |
| 175(830) | 7201-6 | Needle Bar Connecting Stud Clamping Screw..... | 167415 | 7201-9 | Starting Bell Crank Hinge Screw 141450(803) with 1662(805)..... |
| 239277 | 7201-6 | Needle Bar Connecting Stud Oil Packing (wick)..... | 239294 | 7201-9 | Starting Bell Crank Pawl..... |
| 23477 | 7201-3 | Needle Bar Crank with 858(830), 1065(830) and two 350812(869)..... | 141449(803) | 7201-9 | Starting Bell Crank Pawl Hinge Screw..... |
| 203172 | 7201-3 | Needle Bar Crank Friction Washer... | 1662(805) | 7201-9 | Starting Bell Crank Pawl Hinge Screw Nut..... |
| 1065(830) | 7201-3 | Needle Bar Crank Position Screw.... | 167414 | 7201-9 | Starting Bell Crank Pawl Hinge Screw 141449(803) with 1662(805)... |
| 858(830) | 7201-3 | Needle Bar Crank Set Screw..... | 239295 | 7201-9 | Starting Bell Crank Pawl Hinge Screw Return Spring..... |
| 136848 | 7201-6 | Needle Bar Take-up with 160(805)... | 167145 | 7201-14 | Starting Lever with 141077(830).... |
| | | | 167146 | 7201-14 | Starting Lever 167145 with 239159, 239307 and two each 141099(805) and 214053..... |

| No. | Plate | Description |
|-------------|---------|--|
| 167458 | 7201-14 | Starting Lever with Starting Lever Stop Cam Interlocking Arm Stop Rod Complete, Nos. 167145, 167157, 167160, 167445, 202342, 239159, 239307, 239518, 239519, two each 1518(805) 141099(805), 214053, three 131022 and four 2807..... |
| 136903 | 7201-16 | Starting Lever Arm (operated) with 350600(869)..... |
| 140427(830) | 7201-16 | Starting Lever Arm and Rock Shaft Stop Screw..... |
| 1664(803) | 7201-16 | Starting Lever Arm and Rock Shaft Stop Screw Lock Nut..... |
| 239299 | 7201-9 | Starting Lever Arm Lifting Rod..... |
| 167148 | 7201-16 | Starting Lever Arm (operated) Key.. |
| 350600(869) | 7201-16 | Starting Lever Arm (operated) Key Clamping Screw..... |
| 239301 | 7201-14 | Starting Lever Bushing..... |
| 136902 | 7201-16 | Starting Lever Arm and Rock Shaft with 170(850), 1664(803) and 140427(830)..... |
| 141077(830) | 7201-14 | Starting Lever Bushing Set Screw... |
| 239487 | 7201-4 | Starting Lever Lifting Rod..... |
| 239303 | 7201-4 | Starting Lever Lifting Rod Operating Lever Arm..... |
| 201356(805) | 7201-4 | Starting Lever Lifting Rod Operating Lever Arm Screw Stud..... |
| 214053 | 7201-14 | Starting Lever Return Spring (2) .. |
| 170(805) | 7201-16 | Starting Lever Return Spring Screw Stud (lower)..... |
| 141099(805) | 7201-14 | Starting Lever Return Spring Screw Stud (upper) (2)..... |
| 167154 | 7201-9 | Starting Lever Starting Rod..... |
| 167155 | 7201-9 | Starting Lever Starting Rod Adjuster..... |
| 141100(850) | 7201-16 | Starting Lever Starting Rod Adjuster Hinge Screw..... |
| 51657(803) | 7201-9 | Starting Lever Starting Rod Lock Nut..... |
| 53617(805) | 7201-9 | Starting Lever Starting Rod Swivel Stud Lock Nut..... |
| 239159 | 7201-14 | Starting Lever Stop Cam Interlocking Arm..... |
| 239307 | 7201-14 | Starting Lever Stop Cam Interlocking Arm Retaining Ring..... |
| 167445 | 7201-14 | Starting Lever Stop Cam Interlocking Arm Stop Rod..... |
| 167447 | 7201-14 | Starting Lever Stop Cam Interlocking Arm Stop Rod complete, Nos. 167157, 167445, 202342, 239518, 239519, two 1518(805) three 131022 and four 2807..... |

| No. | Plate | Description |
|-------------|---------|--|
| 131022 | 7201-14 | Starting Lever Stop Cam Interlocking Arm Stop Rod Bumper (rubber) (3)..... |
| 2807 | 7201-14 | Starting Lever Stop Cam Interlocking Arm Stop Rod Bumper Separating Washer (4)..... |
| 239518 | 7201-14 | Starting Lever Stop Cam Interlocking Arm Stop Rod Hinge Pin..... |
| 239519 | 7201-14 | Starting Lever Stop Cam Interlocking Arm Stop Rod Hinge Pin Retainer..... |
| 202342 | 7201-14 | Starting Lever Stop Cam Interlocking Arm Stop Rod Hinge Pin Tension Spring..... |
| 1518(805) | 7201-14 | Starting Lever Stop Cam Interlocking Arm Stop Rod Nut (2)..... |
| 167157 | 7201-14 | Starting Lever Stop Cam Interlocking Arm Stop Rod Swivel..... |
| 167160 | 7201-14 | Starting Lever Stop Cam Interlocking Arm Stop Rod Swivel Retaining Ring..... |
| 167446 | 7201-14 | Starting Lever Stop Cam Interlocking Arm Stop Rod complete, Nos. 167445, 202342, 239518 and 239519.. |
| 239554 | 7201-16 | Stop Motion Brake Shoe (leather)... |
| 239555 | 7201-16 | Stop Motion Brake Shoe Rivet (2)... |
| 239556 | 7201-16 | Stop Motion Brake Shoe Support..... |
| 239557 | 7201-16 | Stop Motion Brake Shoe Support complete, Nos. 239554, 239556 and two 239555..... |
| 167159 | 7201-16 | Stop Motion Brake Shoe Support Bracket with 171(830) and 201(804) |
| 167161 | 7201-16 | Stop Motion Brake Shoe Support Bracket 167159 with 50446(803), 141101(803), 223812, 239513 and 239557..... |
| 167229 | 7201-16 | Stop Motion Brake Shoe Support Bracket Pressure Spring..... |
| 141101(803) | 7201-16 | Stop Motion Brake Shoe Support Bracket Pressure Spring Adjusting Screw..... |
| 171(830) | 7201-16 | Stop Motion Brake Shoe Support Bracket Pressure Spring Adjusting Screw Clamping Screw..... |
| 239512 | 7201-16 | Stop Motion Brake Shoe Support Bracket Pressure Spring Sleeve.... |
| 239513 | 7201-16 | Stop Motion Brake Shoe Support Bracket Stud (eccentric)..... |
| 201(804) | 7201-16 | Stop Motion Brake Shoe Support Bracket Stud Screw..... |
| 50446(803) | 7201-16 | Stop Motion Brake Shoe Support Hinge Screw..... |
| 223812 | 7201-16 | Stop Motion Brake Shoe Support Spring..... |

| No. | Plate | Description |
|------------|---------|--|
| 239549 | 7201-16 | Stop Motion Brake Complete, Nos. 141100(850), 167161, 167229 and 239512..... |
| 2102 | 7201-13 | Tension Disc (2)..... |
| 1560(803) | 7201-13 | Tension Regulating Thumb Nut..... |
| 1110(803) | 7201-13 | Tension Screw Stud..... |
| 20972 | 7201-13 | Tension Screw Stud 1110(803) with 1560(803)..... |
| 156376 | 7201-13 | Tension Spring..... |
| 156316 | 7201-13 | Tension Thread Guide..... |
| 136810 | 7201-6 | Thread Nipper (back) Adapter Block with 1454(830)..... |
| 1454(830) | 7201-6 | Thread Nipper (back) Adapter Block Screw (2)..... |
| 1743(809) | 7201-6 | Thread Nipper (back) Adjusting Thumb Nut..... |
| 136849 | 7201-6 | Thread Nipper (back) Body..... |
| 1454(830) | 7201-6 | Thread Nipper (back) Body Set Screw..... |
| 136811 | 7201-3 | Thread Nipper (back) Cam with two 50150(830)..... |
| 167017 | 7201-3 | Thread Nipper (back) Cam Access Hole Cover..... |
| 50150(830) | 7201-3 | Thread Nipper (back) Cam Set Screw (2)..... |
| 2921 | 7201-6 | Thread Nipper (back) Disc (2)..... |
| 12162 | 7201-6 | Thread Nipper (back) Disc Guide Pin..... |
| 136701 | 7201-6 | Thread Nipper (back) Eyelet..... |
| 1654(809) | 7201-6 | Thread Nipper (back) Lock Nut..... |
| 59776 | 7201-6 | Thread Nipper (back) Stud with 13538..... |
| 13538 | 7201-6 | Thread Nipper (back) Stud Position Pin..... |
| 13539 | 7201-6 | Thread Nipper (back) Stud Roller.. |
| 13540 | 7201-6 | Thread Nipper (back) Stud Roller Pin..... |
| 2026 | 7201-6 | Thread Nipper (back) Stud Spring.. |
| 59777 | 7201-6 | Thread Nipper (back) Stud complete, Nos. 13539, 13540 and 59776 |
| 136850 | 7201-6 | Thread Nipper (back) complete, Nos. 1654(809), 1743(809), 2026, 12162, 59777, 136701, 136810, and 136849, and two 2921..... |
| 136864 | 7201-13 | Thread Nipper (front) and Thread Pull-off complete, Nos. 176(819), 846(803), 1282(803), 1454(830), 1747(809), 20972, 50087(830), 136677, 136778, 136791, 136796, 136799, 136800, 136803, 136804, 136805, 136812, 136842, 136870, 136871, 136872, 140431(803), 156316, 156376, 175032, 175179, 175182 and two 2102..... |

| No. | Plate | Description |
|-------------|---------|--|
| 136870 | 7201-13 | Thread Nipper (front) Lever..... |
| 136871 | 7201-13 | Thread Nipper (front) Lever Block.. |
| 136872 | 7201-13 | Thread Nipper (front) Lever Block Pivot Pin..... |
| 846(803) | 7201-13 | Thread Nipper (front) Lever Hinge Screw (left)..... |
| 50087(830) | 7201-13 | Thread Nipper (front) Lever Hinge Screw (right)..... |
| 136852 | 7201-13 | Thread Nipper (front) Lever Rod.... |
| 136799 | 7201-13 | Thread Nipper (front) Lever Rod Cam (driven) with 202(805)..... |
| 202(805) | 7201-13 | Thread Nipper (front) Lever Rod Cam (driven) Set Screw..... |
| 136803 | 7201-13 | Thread Nipper (front) Lever Rod Cam (driving) with 237(830)..... |
| 176(819) | 7201-13 | Thread Nipper (front) Lever Rod Cam (driving) Screw..... |
| 175179 | 7201-13 | Thread Nipper (front) Lever Rod Spring..... |
| 175182 | 7201-13 | Thread Nipper (front) Lever Rod Spring Collar with 465(830)..... |
| 465(830) | 7201-13 | Thread Nipper (front) Lever Rod Spring Collar Set Screw..... |
| 175032 | 7201-13 | Thread Nipper (front) Lever Rod Spring Washer..... |
| 136778 | 7201-13 | Thread Nipper (front) Thread Guide.. |
| 140431(803) | 7201-13 | Thread Nipper (front) Thread Guide Screw..... |
| 1747(809) | 7201-13 | Thread Nipper (front) Thread Guide Screw Nut..... |
| 136780 | 7201-13 | Thread Pull-off (front)..... |
| 237(830) | 7201-13 | Thread Pull-off (front) Set Screw... |
| 136677 | 7201-13 | Thread Pull-off (rear)..... |
| 624(830) | 7201-13 | Thread Pull-off (rear) Set Screw.... |
| 136804 | 7201-13 | Thread Pull-off Bell Crank with 624(830)..... |
| 136800 | 7201-13 | Thread Pull-off Bell Crank Bracket.. |
| 140220(819) | 7201-13 | Thread Pull-off Bell Crank Bracket Mounting Screw..... |
| 136813 | 7201-13 | Thread Pull-off Bell Crank Bracket Mounting Screw Spacer..... |
| 136839 | 7201-13 | Thread Pull-off Bell Crank Bracket Stabilizing Pin..... |
| 136812 | 7201-13 | Thread Pull-off Bell Crank Connection..... |
| 194(803) | 7201-4 | Thread Pull-off Bell Crank Connection Screw (lower)..... |
| 1282(803) | 7201-13 | Thread Pull-off Bell Crank Connection Screw (upper)..... |
| 136805 | 7201-13 | Thread Pull-off Bell Crank Extension..... |
| 1454(830) | 7201-13 | Thread Pull-off Bell Crank Extension Screw..... |

| No. | Plate | Description | No. | Plate | Description |
|-------------|---------|---|-------------|---------|---|
| 136796 | 7201-13 | Thread Pull-off Bell Crank Hinge Stud..... | 460(830) | 7201-9 | Tripping Rock Shaft Collar Set Screw (2)..... |
| 136859 | 7201-4 | Thread Pull-off Driving Lever with 208(830) and two 140321(830) (NOTE: Screw 208(830) has no application for this machine.).... | 239341 | 7201-9 | Tripping Rock Shaft Connection with 350606(869)..... |
| 140321(830) | 7201-4 | Thread Pull-off Driving Lever Set Screw (2)..... | 350606(869) | 7201-9 | Tripping Rock Shaft Connection Pinch Screw..... |
| 167168 | 7201-6 | Thread Retainer (back)..... | 239342 | 7201-9 | Tripping Rock Shaft Connection Rod |
| 853(830) | 7201-6 | Thread Retainer (back) Set Screw.. | 239343 | 7201-9 | Tripping Rock Shaft Lever Arm..... |
| 167292 | 7201-19 | Thread Unwinder Mounting Bracket with 462(830) (NOTE: Screw 462(830) has no application for this machine.)..... | 51119(805) | 7201-9 | Tripping Rock Shaft Lever Arm Screw..... |
| 136911 | 7201-8 | Thread Separator..... | 136797 | 7201-9 | Tripping Rock Shaft Spacer..... |
| 1034(805) | 7201-8 | Thread Separator Screw..... | 239344 | 7201-9 | Tripping Rock Shaft Support..... |
| 136912 | 7201-8 | Thread Separator Screw Washer..... | 141093(830) | 7201-9 | Tripping Rock Shaft Support Screw. |
| 641(850) | 7201-19 | Thread Unwinder Mounting Bracket Set Screw..... | 239345 | 7201-17 | Vertical Drive Shaft..... |
| 239387 | 7201-4 | Thread Wiper Body..... | 239346 | 7201-17 | Vertical Drive Shaft Bushing (lower)..... |
| 39453 | 7201-4 | Thread Wiper Body Finger..... | 239346 | 7201-17 | Vertical Drive Shaft Bushing (upper)..... |
| 330(809) | 7201-4 | Thread Wiper Body Finger Screw.... | 167044 | 7201-3 | Vertical Drive Shaft Worm with 141407(869) and 141408(869)..... |
| 141084(803) | 7201-4 | Thread Wiper Body Hinge Screw..... | 167073 | 7201-17 | Vertical Drive Shaft Worm Gear with 141407(869) and 141408(869).. |
| 167174 | 7201-4 | Thread Wiper Body Support..... | 141407(869) | 7201-17 | Vertical Drive Shaft Worm Gear Position Screw..... |
| 167038 | 7201-4 | Thread Wiper Body Support 167174 with 141084(803), 141574(803), 167354, 239336 and 239387..... | 141408(869) | 7201-17 | Vertical Drive Shaft Worm Gear Set Screw..... |
| 141406(830) | 7201-4 | Thread Wiper Body Support Set Screw..... | 141407(869) | 7201-3 | Vertical Drive Shaft Worm Position Screw..... |
| 167354 | 7201-4 | Thread Wiper Body Wire (adjustable)..... | 141408(869) | 7201-3 | Vertical Drive Shaft Worm Set Screw..... |
| 239336 | 7201-4 | Thread Wiper Body Wire Clamping Plate..... | | | |
| 141574(803) | 7201-4 | Thread Wiper Body Wire Clamping Plate Screw..... | | | |
| 136891 | 7201-4 | Thread Wiper complete, Nos. 330(809), 39453, 136890, 141084(803), 141574(803), 167174, 167354, 239336 and 239387..... | | | |
| 136886 | 7201-8 | Throat Plate..... | | | |
| 136910 | 7201-8 | Throat Plate complete, Nos. 1547(803), 50018(806), 59739, 136823, 136886, 136907, 136908, 136911, 136912, and two 1034(805).. | | | |
| 51369(805) | 7201-8 | Throat Plate Screw (4)..... | | | |
| 167181 | 7201-9 | Tripping Rock Shaft..... | | | |
| 136855 | 7201-8 | Tripping Rock Shaft Bracket..... | | | |
| 1177(803) | 7201-8 | Tripping Rock Shaft Bracket Screw (2)..... | | | |
| 167182 | 7201-9 | Tripping Rock Shaft Collar with two 460(830)..... | | | |

**LIST OF PARTS
FOR
MACHINE NO. 421W301BA**

For tacking paper tickets on clothing, spot tacking, and tacking trouser cuffs. Machine produces a tack up to 3/16" (4.763 mm) in length consisting of 7 stitches.

NOTE: Parts for this machine are the same as Machine 421W307BA, with the following exceptions:

| No. | Plate | Description |
|------------|---------|--|
| 239223-452 | 7201-1 | Arm Cover (side) in place of 239223-451..... |
| 32803 | 7201-20 | Clamp complete, Nos. 202(819), 1182(819), 1656(819), 124646, 136873 and 167322 in place of 167325..... |
| 202(819) | 7201-20 | Clamp Arm Hook Screw (left)..... |
| 1182(819) | 7201-20 | Clamp Arm Hook Screw (right)..... |
| 1656(819) | 7201-20 | Clamp Screw Stud Nut..... |
| 124646 | 7201-20 | Clamp with 1220(805) and 17928..... |
| 136873 | 7201-20 | Clamp Arm with 17714..... |
| 167322 | 7201-20 | Clamp Arm Hook with 63825 (NOTE: 63825 has no application for this machine.)..... |
| 1220(805) | 7201-20 | Clamp Screw Stud..... |
| 17928 | 7201-20 | Clamp Position Stud..... |
| 17712 | 7201-20 | Clamp Pressure Spring in place of 39241..... |
| 1178(819) | 7201-20 | Clamp Pressure Spring Screw in place of 141211(869)..... |
| 39335 | 7201-20 | Clamp Pressure Spring Screw Plate in place of 136827..... |
| 167426 | ----- | Clamp complete 32803 with 1176(819), 1177(819), 1178(819), 17710, 17712, 39335, 136875 and 239572..... |
| 239234 | 7201-20 | Cylinder Cover (side) in place of 239533..... |
| 167041 | 7201-20 | Cylinder Cover (top) in place of 136899..... |

| No. | Plate | Description |
|-------------|---------|---|
| 136876 | ----- | Feed Cam with four 167234 and eight each 140352(830) and 167235 in place of 136863..... |
| 167234 | 7201-18 | Feed Cam Tripping Point (4)..... |
| 140352(830) | 7201-18 | Feed Cam Tripping Point Screw (8)..... |
| 167235 | 7201-18 | Feed Cam Tripping Point Screw Washer (8)..... |
| 136874 | 7201-20 | Feed Plate in place of 136893..... |
| 136875 | ----- | Feed Plate Carrier Bar 167029 with 136874, 141071(819), 167041 and 167055 in place of 136904..... |
| 167029 | 7201-7 | Feed Plate Carrier Bar..... |
| 141071(819) | 7201-7 | Feed Plate Carrier Bar Driving Block Screw..... |
| 167055 | 7201-7 | Feed Plate Carrier Bar Driving Block complete, Nos. 167054 and 167056..... |
| 167076 | 7201-21 | Lateral Pivot Driving Arm 167075 with 1519(805), 141075(803) and 239266 in place of 136830..... |
| 167075 | 7201-21 | Lateral Pivot Driving Arm with 350600(869) in place of 136829..... |
| 350600(869) | 7201-21 | Lateral Pivot Driving Arm Clamping Screw..... |
| 239266 | 7201-21 | Lateral Rock Shaft Driven Arm Driving Link..... |
| 239268 | 7201-11 | Lateral Rock Shaft Driving Arm with 350604(869) in place of 239623..... |
| 167048 | 7201-20 | Lateral Rock Shaft Driving Arm Screw Stud in place of 167335..... |
| 210805 | 7201-20 | Lateral Rock Shaft Driving Arm Screw Stud Nut Washer in place of 167449..... |
| 53612(805) | 7201-20 | Lateral Rock Shaft Driving Arm Screw Stud Nut in place of 53626(803)..... |
| 167048 | 7201-20 | Longitudinal Rock Shaft Driving Arm Screw Stud in place of 167335..... |
| 210805 | 7201-20 | Longitudinal Rock Shaft Driving Arm Screw Stud Nut Washer in place of 167449..... |
| 53612(805) | 7201-20 | Longitudinal Rock Shaft Driving Arm Screw Stud Nut in place of 53626(803)..... |
| 239268 | 7201-11 | Longitudinal Rock Shaft Driving Arm with 350604(869) in place of 239623..... |
| 167077 | 7201-19 | Vertical Drive Shaft Worm with 141407(869) and 141408(869) in place of 167044..... |

| No. | Plate | Description |
|--------|---------|---|
| 167079 | 7201-19 | Vertical Drive Shaft Worm Gear with 141407(869) and 141408(869) in place of 167073..... |

PARTS REMOVED

| | | |
|-------------|---------|--|
| 167330 | 7201-12 | Adjusting Device complete..... |
| 650(803) | 7201-7 | Button Clamp Guiding Screw (2 hole buttons)..... |
| 136802 | 7201-7 | Button Clamp Guiding Screw (2 hole buttons) Drag Spring..... |
| 136898 | 7201-7 | Button Clamp Guiding Screw (2 hole buttons) Guide Block..... |
| 792(819) | 7201-7 | Button Clamp Guiding Screw (2 hole buttons) Guide Block Fastening Screw (2)..... |
| 136827 | 7201-7 | Button Clamp Guiding Screw (2 hole buttons) Holder..... |
| 136828 | 7201-7 | Button Clamp Guiding Screw (2 hole buttons) Stop..... |
| 136826 | 7201-10 | Lateral Feed Throw-out Collar..... |
| 350800(869) | 7201-10 | Lateral Feed Throw-out Collar Positioning Screw (3)..... |
| 149797 | 7201-10 | Lateral Feed Throw-out Collar Retaining Ring..... |
| 350802(830) | 7201-10 | Lateral Feed Throw-out Screw..... |
| 214529 | 7201-10 | Lateral Feed Throw-out Screw Drag Spring..... |
| 350812(869) | 7201-12 | Lateral Rock Shaft Driving Arm Screw Stud Locking Screw..... |
| 350812(869) | 7201-12 | Longitudinal Rock Shaft Driving Arm Screw Stud Locking Screw..... |

LIST OF PARTS
FOR
MACHINE NO. 421W303BA

For sewing two- or four-hole flat buttons (size 13 ligne through 50 ligne) and snap fasteners (size 0 through 000) with 14 stitches. The work clamp moves alternately back and forth lengthwise of the cylinder.

NOTE: Parts for this machine are the same as Machine 421W307BA, with the following exceptions:

| No. | Plate | Description |
|------------|---------|---|
| 239223-453 | 7201-1 | Arm Cover (side) in place of 239223-451..... |
| 136877 | ----- | Feed Cam with two 167234 and four each 140352(830) and 167235 in place of 136863..... |
| 167077 | 7201-19 | Vertical Drive Shaft Worm with 141407(869) and 141408(869) in place of 167044..... |
| 167079 | 7201-19 | Vertical Drive Shaft Worm Gear with 141407(869) and 141408(869) in place of 167073..... |

**LIST OF PARTS
FOR
MACHINE NO. 421W311BA**

For sewing two- or four-hole flat buttons (size 13 ligne through 50 ligne) and snap fasteners (size 0 through 000) with 16 stitches. The work clamp moves alternately across the cylinder.

NOTE: Parts for this machine are the same as Machine 421W307BA, with the following exceptions:

| No. | Plate | Description |
|-------------|---------|--|
| 239223-454 | 7201-1 | Arm Cover (side) in place of 239223-451..... |
| 136913 | 7201-21 | Button Clamp Guiding Screw (2 hole buttons) Guide Block in place of 136898..... |
| 1485(833) | 7201-21 | Button Clamp Guiding Screw (2 hole buttons) Guide Block Fastening Screw (2) in place of 792(819).... |
| 136897 | ----- | Feed Cam with two 167234 and four each 140352(830) and 167235 in place of 136863..... |
| 167075 | 7201-21 | Lateral Pivot Driving Arm with 350600(869) in place of 136829.... |
| 167076 | 7201-21 | Lateral Pivot Driving Arm 167075 with 1519(805), 141075(803) and 239266 in place of 136830..... |
| 350600(869) | 7201-21 | Lateral Pivot Driving Arm Clamping Screw..... |
| 350802(830) | 7201-21 | Longitudinal Feed Throw-out Screw. |
| 214529 | 7201-21 | Longitudinal Feed Throw-out Screw Drag Spring..... |
| 136879 | 7201-21 | Longitudinal Rock Shaft (driving) in place of 239384..... |
| 136880 | ----- | Longitudinal Rock Shaft (driving) 136879 with 51951 in place of 239144..... |

| No. | Plate | Description |
|-------------|---------|---|
| 136881 | 7201-21 | Longitudinal Rock Shaft (driven).. |
| 136882 | 7201-21 | Longitudinal Rock Shaft (driven) Coupling with 140409(869)..... |
| 140409(869) | 7201-21 | Longitudinal Rock Shaft (driven) Coupling Set Screw..... |

PARTS REMOVED

| | | |
|-------------|---------|--|
| 136826 | 7201-10 | Lateral Feed Throw-out Collar..... |
| 350800(869) | 7201-10 | Lateral Feed Throw-out Collar Positioning Screw (3)..... |
| 149797 | 7201-10 | Lateral Feed Throw-out Collar Retaining Ring..... |
| 350802(830) | 7201-10 | Lateral Feed Throw-out Screw..... |
| 214529 | 7201-10 | Lateral Feed Throw-out Screw Drag Spring..... |
| 167416 | 7201-11 | Longitudinal Rock Shaft Collar with two 140321(830)..... |
| 140321(830) | 7201-11 | Longitudinal Rock Shaft Collar Set Screw (2)..... |

ACCESSORIES
for
Machines 421W301BA, 421W303BA
421W307BA and 421W311BA

| No. | Plate | Description |
|-------------|---------|---|
| 120342 | 7201-29 | Oiler with 120343..... |
| 120343 | 7201-29 | Oiler Spout (3-1/2 in. long)..... |
| 167448 | 7201-26 | Machine Base Oil Drain Jar (plastic)..... |
| 228444 | 7201-26 | Machine Cushion (4)..... |
| 12361-001 | 7201-23 | Machine Hinge Connection (2)..... |
| 228786 | 7201-26 | Machine Support (left)..... |
| 228865 | 7201-26 | Machine Support (left) 228786 with two wood screws 1-1/4 in. No. 12 F.H..... |
| 228809 | 7201-26 | Machine Support (right) with two wood screws 1-1/4 in. No. 12 F.H... Machine Tilting Latch Lever com- plete..... |
| 228788 | 7201-26 | Machine Tilting Latch Lever com- plete..... |
| 200246(803) | 7201-26 | Machine Tilting Latch Lever Screw.. |
| 228789 | 7201-26 | Machine Tilting Latch Lever Spring. |
| 239350 | 7201-29 | Pliers..... |
| 225498 | 7201-29 | Screwdriver..... |
| 228476 | 7201-29 | Screwdriver..... |
| 23308 | 7201-29 | Screwdriver (8 in. blade)..... |
| 149426 | 7201-22 | Starting Lever Return Spring (not for 421W301 Machine)..... |
| 239371 | 7201-29 | Wrench..... |
| 23535 | 7201-29 | Wrench..... |
| 225554 | 7201-29 | Wrench..... |
| 239353 | 7201-29 | Wrench..... |
| 255540 | 7201-29 | Wrench..... |
| 10875 | 7201-29 | Wrench..... |
| 17905 | 7201-29 | Wrench..... |
| 167260 | 7201-29 | Wrench..... |
| 154308 | 7201-22 | Set of Gauges for Centralizing Feed Mechanism, Nos. 154306, 154307 and 154354 (furnished upon request only) |
| 154305 | 7201-22 | Gauge Pin..... |
| 154354 | 7201-22 | Gauge Pin 154305 with 154355..... |
| 154306 | 7201-22 | Gauge Pin Extension..... |
| 154307 | 7201-22 | Gauge Pin Setting Cam..... |
| 154355 | 7201-22 | Gauge Pin Spring Plunger..... |
| 239394 | ----- | Work Plate complete (furnished upon request only)..... |

Belt Guard

| No. | Plate | Description |
|-------------|---------|---|
| 167187 | 7201-23 | Belt Guard with 141093(830)..... |
| 239355 | 7201-23 | Belt Guard Base..... |
| 239444-001 | 7201-23 | Belt Guard Base 239355 with wood screws 1-1/4 in. No. 12 R.H..... |
| 239356 | 7201-23 | Belt Guard Hinge Pin..... |
| 141093(830) | 7201-23 | Belt Guard Hinge Pin Set Screw.... |
| 239357 | 7201-23 | Belt Guard Lock Spring..... |
| 167188 | 7201-23 | Belt Guard Lock Spring Plate..... |
| 141103(850) | 7201-23 | Belt Guard Lock Spring Plate Screw (2)..... |
| 167189 | 7201-23 | Belt Guard complete, Nos. 167187, 167188, 239356, 239357 and two 141103(850)..... |

Drip Pan

| No. | Plate | Description |
|-------------|---------|---|
| 228785 | 7201-26 | Drip Pan..... |
| 201308(805) | 7201-26 | Drip Pan Screw (4)..... |
| 203637 | 7201-26 | Drip Pan Screw Washer (4)..... |
| 52843 | 7201-26 | Drip Pan Screw Washer (leather) (4)..... |

Eye Guard

| No. | Plate | Description |
|-------------|---------|---|
| 259830 | 7201-22 | Eye Guard Deflector..... |
| 259831 | 7201-22 | Eye Guard Bracket..... |
| 200273(819) | 7201-22 | Eye Guard Bracket Hinge Screw..... |
| 200184(819) | 7201-22 | Eye Guard Bracket Screw (2)..... |
| 226467 | 7201-22 | Eye Guard Bracket Spring Washer... |
| 259832 | 7201-22 | Eye Guard complete, Nos. 200273(819), 226467, 259830, 259831 and two 200184(819)..... |

Driving Accessories for Head-on Installation

| No. | Plate | Description |
|------------|---------|--|
| 151223 | 7201-27 | Belt Tightener complete, Nos. 51655(819), 150783, 151066, 151219, 151220, 151221, 151222, two each 9281, 151068, four each 50807(819), 151369 and eight each 1778(819), 9842 and 126150..... |
| 150701 | 7201-27 | Belt Tightener Hinge Plate Adjusting Screw..... |
| 150783 | 7201-27 | Belt Tightener Hinge Plate Adjusting Screw 150701 with 51655(819)... |
| 151220 | 7201-27 | Belt Tightener Hinge Plate Adjusting Screw Hinge Bracket..... |
| 151066 | 7201-27 | Belt Tightener Hinge Plate Adjusting Screw Hinge Pin..... |
| 151068 | 7201-27 | Belt Tightener Hinge Plate Adjusting Screw Hinge Pin Retaining Ring (2)..... |
| 51655(819) | 7201-27 | Belt Tightener Hinge Plate Adjusting Screw Nut (2)..... |
| 9281 | 7201-27 | Belt Tightener Hinge Plate Adjusting Screw Nut Washer (2)..... |
| 151219 | 7201-27 | Belt Tightener Motor Plate..... |
| 151221 | 7201-27 | Belt Tightener Motor Plate Hinge Bracket..... |
| 151222 | 7201-27 | Belt Tightener Motor Plate Hinge Bracket Pin..... |
| 50807(819) | 7201-27 | Motor Bolt (4)..... |
| 1778(819) | 7201-27 | Motor Bolt Nut (4)..... |
| 126150 | 7201-27 | Motor Bolt Nut Lock Washer (4)..... |
| 9842 | 7201-27 | Motor Bolt Washer..... |
| 151369 | 7201-27 | Table Screw Stud (4)..... |
| 1778(819) | 7201-27 | Table Screw Stud Nut (4)..... |
| 126150 | 7201-27 | Table Screw Stud Nut Lock Washer (4)..... |
| 9842 | 7201-27 | Table Screw Stud Washer (4)..... |
| 228822 | 7201-25 | Treadle complete, Nos. 2718(819), 14372, 14373, 14375, 22666, 50581(819) and two each 13288, 23180, 51074(819) and 67425 (2).... |
| 14372 | 7201-25 | Treadle (2)..... |
| 14373 | 7201-25 | Treadle Extension (2)..... |
| 50581(819) | 7201-25 | Treadle Extension Screw (2)..... |
| 2718(819) | 7201-25 | Treadle Extension Screw Washer (2)..... |
| 22666 | 7201-25 | Treadle Shaft (2)..... |
| 13288 | 7201-25 | Treadle Shaft Retaining Ring (4).... |
| 14375 | 7201-25 | Treadle Stand (2)..... |
| 51074(819) | 7201-25 | Treadle Stand Bolt (4)..... |

| No. | Plate | Description |
|--------|---------|--|
| 67425 | 7201-25 | Treadle Stand Bolt Lock Washer (4). |
| 23180 | 7201-25 | Treadle Stand Bolt Washer..... |
| 150750 | ----- | Machine Driving Belt 50 inch outside length for "V" Drive Machine Pulleys..... |

OPERATING EQUIPMENT

| | | |
|-------------|---------|--|
| 228807 | 7201-24 | Operating Equipment complete, Nos. two each 2770, 32134, 167416, 228802, 228811, 228861 and four each 228805 and 228806..... |
| 167226-001 | 7201-24 | Operating Equipment Cable (long) (2)..... |
| 228861 | 7201-24 | Operating Equipment Cable (adjustable) complete, Nos. 1521(819), 151633, 167226-001 and 228858 (2). |
| 1521(819) | 7201-24 | Operating Equipment Cable Lock Nut (2)..... |
| 228858 | 7201-24 | Operating Equipment Cable Yoke End (2)..... |
| 151633 | 7201-24 | Operating Equipment Cable Yoke End Pin (2)..... |
| 228910 | 7201-24 | Operating Equipment Chain (24 in. long) (2)..... |
| 228802 | 7201-24 | Operating Equipment Chain with two 202784 (2)..... |
| 202784 | 7201-24 | Operating Equipment Chain Hook (4) |
| 228811 | 7201-24 | Operating Equipment Rock Shaft (2) |
| 167416 | 7201-24 | Operating Equipment Rock Shaft Collar with two 140321(830) (2).... |
| 140321(830) | 7201-24 | Operating Equipment Rock Shaft Collar Set Screw (4)..... |
| 228805 | 7201-24 | Operating Equipment Rock Shaft Lever Arm (4)..... |
| 228806 | 7201-24 | Operating Equipment Rock Shaft Lever Arm Bracket with two 356(803) (4)..... |
| 356(803) | 7201-24 | Operating Equipment Rock Shaft Lever Arm Bracket Set Screw (8).... |
| 32134 | 7201-24 | Operating Equipment Rock Shaft Spring (2)..... |
| 2270 | 7201-24 | Operating Equipment Rock Shaft Stop Dog with 140219(803) (2)..... |
| 140219(803) | 7201-24 | Operating Equipment Rock Shaft Stop Dog Set Screw (2)..... |

THREAD UNWINDER

| No. | Plate | Description |
|-------------|---------|---|
| 167261 | 7201-28 | Thread Unwinder (for one spool) complete, Nos. 150203, 167186, 228764, 228765, 228767, 228768, 228770, 228774 and three wood screws 7/8 in. No. 12 R.H.B..... |
| 228764 | 7201-28 | Thread Unwinder Spool Pin..... |
| 228765 | 7201-28 | Thread Unwinder Spool Rest with 201254(830)..... |
| 150203 | 7201-28 | Thread Unwinder Spool Rest Cushion (felt)..... |
| 228767 | 7201-28 | Thread Unwinder Spool Rest Rod.... |
| 201254(830) | 7201-28 | Thread Unwinder Spool Rest Set Screw..... |
| 228768 | 7201-28 | Thread Unwinder Spool Stand..... |
| 167186 | 7201-28 | Thread Unwinder Thread Guide..... |
| 228770 | 7201-28 | Thread Unwinder Thread Guide Holder (for one or two guides).... |
| 228774 | 7201-28 | Thread Unwinder Thread Guide Rod.. |

NUMERICAL LIST OF PARTS

| No. | Plate | Description |
|----------|---------|--|
| 99(819) | 7201-5 | Button Clamp Opening Lever Hinge Screw (For 421W303BA, 421W307BA and 421W311BA)..... |
| 160(805) | 7201-6 | Needle Bar Take-up Clamping Screw..... |
| 170(805) | 7201-16 | Starting Lever Return Spring Stud (lower)..... |
| 171(819) | 7201-8 | Knife Driving Bar Latch Spring Stud Screw (upper)..... |
| 171(830) | 7201-16 | Stop Motion Brake Shoe Support Bracket Pressure Spring Adjusting Screw Clamping Screw..... |
| 175(830) | 7201-6 | Needle Bar Connecting Stud Clamping Screw..... |
| 176(819) | 7201-4 | Clamp Foot Lifter Screw..... |
| 176(819) | 7201-13 | Thread Nipper (front) Lever Rod Cam (driving) Screw..... |
| 185(809) | 7201-2 | Arm Cover (front) Thread Retainer Screw (2)..... |
| 190(805) | 7201-8 | Knife Driving Bar Stop (in bracket) Screw (2)..... |
| 194(803) | 7201-4 | Thread Pull-off Bell Crank Connection Screw (lower)..... |
| 195(803) | 7201-3 | Needle Guide Cam Set Screw (2)..... |
| 201(804) | 7201-16 | Stop Motion Brake Shoe Support Bracket Stud Screw..... |
| 202(805) | 7201-13 | Thread Nipper (front) Lever Rod Cam (driven) Set Screw..... |
| 202(819) | 7201-5 | Clamp Arm Hook Screw (left)..... |
| 207(805) | 7201-8 | Knife Driver (adjustable) Screw (2)..... |
| 209(833) | 7201-6 | Needle Set Screw..... |
| 218(804) | 7201-3 | Needle Guide Thread Finger Screw (2)..... |
| 230(805) | 7201-2 | Arm Cover (front) Thread Guide Plate Screw..... |
| 230(819) | 7201-5 | Button Clamp (left) Spring Screw (For 421W303BA, 421W307BA and 421W311BA)..... |
| 230(819) | 7201-5 | Button Clamp (right) Spring Screw (For 421W303BA, 421W307BA and 421W311BA)..... |
| 237(830) | 7201-13 | Thread Pull-off (front) Set Screw.. |
| 330(809) | 7201-4 | Thread Wiper Body Finger Screw.... |
| 356(803) | 7201-24 | Operating Equipment Rock Shaft Lever Arm Bracket Set Screw (8).... |
| 440(830) | 7201-3 | Looper Shaft Bushing (front) Set Screw..... |
| 440(830) | 7201-3 | Looper Shaft Bushing (rear) Set Screw..... |
| 440(830) | 7201-3 | Needle Guide Shaft Bushing Set Screw..... |
| 460(830) | 7201-9 | Tripping Rock Shaft Collar Set Screw (2)..... |

| No. | Plate | Description |
|-----------|---------|--|
| 465(830) | 7201-4 | Clamp Lifting Rock Shaft Collar (knurled) Set Screw..... |
| 465(830) | 7201-13 | Thread Nipper (front) Lever Rod Spring Collar Set Screw..... |
| 624(830) | 7201-13 | Thread Pull-off (rear) Set Screw... |
| 641(850) | 7201-19 | Thread Unwinder Mounting Bracket Set Screw..... |
| 650(803) | 7201-7 | Button Clamp Guiding Screw (2 Hole buttons) (For 421W303BA, 421W307BA and 421W311BA)..... |
| 691(819) | 7201-7 | Cylinder Cover Plate (top) Screw (5)..... |
| 769(850) | 7201-8 | Knife Driving Bar Latch Tripping Screw..... |
| 792(819) | 7201-2 | Arm Cover (front) Screw (2)..... |
| 792(819) | 7201-7 | Button Clamp Guiding Screw (2 hole buttons) Guide Block Fastening Screw (2) (For 421W303BA and 421W307BA)..... |
| 846(803) | 7201-13 | Thread Nipper (front) Lever Hinge Screw (left)..... |
| 853(830) | 7201-6 | Thread Retainer (back) Set Screw... |
| 858(830) | 7201-3 | Needle Bar Crank Set Screw..... |
| 998(830) | ----- | Arm Plug (right) Set Screw..... |
| 1034(805) | 7201-8 | Knife (thread cutter) Screw..... |
| 1034(805) | 7201-8 | Thread Separator Screw..... |
| 1057(830) | 7201-3 | Needle Guide Oscillating Crank Clamping Screw..... |
| 1065(830) | 7201-3 | Needle Bar Crank Position Screw.... |
| 1110(803) | 7201-13 | Tension Screw Stud..... |
| 1175(850) | 7201-7 | Button Clamp Hinge Screw (2)..... |
| 1176(819) | 7201-7 | Clamp Arm Hinge Plate Screw..... |
| 1177(803) | 7201-8 | Tripping Rock Shaft Bracket Screw (2)..... |
| 1177(819) | 7201-7 | Clamp Pressure Spring Bracket Screw..... |
| 1178(819) | 7201-20 | Clamp Pressure Spring Screw (For 421W301BA)..... |
| 1181(819) | 7201-5 | Button Clamp Spreader Spring Screw Stud (For 421W303BA, 421W307BA and 421W311BA)..... |
| 1182(819) | 7201-5 | Button Clamp Opening Lever Bracket Screw (2) (For 421W303BA, 421W307BA and 421W311BA)..... |
| 1182(819) | 7201-5 | Button Clamp Spreader Lever Adjusting Plate Screw (For 421W303BA, 421W307BA and 421W311BA)..... |
| 1182(819) | 7201-5 | Button Clamp Spreader Lever Stop Screw (For 421W303BA, 421W307BA and 421W311BA)..... |
| 1182(819) | 7201-5 | Clamp Arm Hook Screw (right)..... |
| 1182(819) | 7201-20 | Clamp Arm Hook Screw (right) (For 421W301BA)..... |

| No. | Plate | Description | No. | Plate | Description |
|-----------|---------|---|-----------|---------|--|
| 1183(819) | 7201-5 | Button Clamp Stop Screw (For 421W303BA, 421W307BA and 421W311BA)..... | 1654(809) | 7201-6 | Thread Nipper (back) Lock Nut..... |
| 1199(819) | 7201-5 | Button Clamp Spreader Thrust Plate Screw (For 421W303BA, 421W307BA and 421W311BA)..... | 1655(803) | 7201-11 | Lateral Rock Shaft Cam Follower |
| 1220(805) | 7201-20 | Clamp Screw Stud (For 421W301BA).... | 1655(803) | 7201-21 | Roller Screw Stud Nut..... |
| 1226(803) | 7201-8 | Knife Driving Bar Latch Spring Stud Screw (lower)..... | 1656(819) | 7201-11 | Longitudinal Rock Shaft Cam Follower Roller Screw Stud Nut..... |
| 1226(803) | 7201-8 | Knife Driving Bar Spring Stud Screw (2)..... | 1662(805) | 7201-20 | Clamp Screw Stud Nut (For 421W301BA)..... |
| 1253(830) | 7201-3 | Arm Shaft (upright) Bevel Gear (lower) Set Screw (2)..... | 1662(805) | 7201-4 | Clamp Lifting Bar Stop Screw Nut... |
| 1253(830) | 7201-3 | Arm Shaft (upright) Bevel Gear (upper) Set Screw (2)..... | 1662(805) | 7201-9 | Starting Bell Crank Hinge Screw Nut..... |
| 1253(830) | 7201-3 | Looper Shaft Bevel Gear Set Screw (2)..... | 1662(805) | 7201-9 | Starting Bell Crank Pawl Hinge Screw Nut..... |
| 1282(803) | 7201-13 | Thread Pull-off Bell Crank Connection Screw (upper)..... | 1664(803) | 7201-16 | Starting Lever Arm and Rock Shaft Stop Screw Lock Nut..... |
| 1289(819) | 7201-8 | Knife Driving Bar Bumper Screw..... | 1698(805) | 7201-8 | Knife Driving Bar Latch Tripping Screw Nut..... |
| 1454(830) | 7201-12 | Cylinder Cover (side) Screw (2).... | 1743(809) | 7201-6 | Thread Nipper (back) Adjusting Thumb Nut..... |
| 1454(830) | 7201-6 | Thread Nipper (back) Adapter Block Screw (2)..... | 1747(809) | 7201-13 | Thread Nipper (front) Thread Guide Screw Nut..... |
| 1454(830) | 7201-6 | Thread Nipper (back) Body Set Screw..... | 1778(819) | 7201-27 | Motor Bolt Nut (4)..... |
| 1454(830) | 7201-13 | Thread Pull-off Bell Crank Extension Screw..... | 1778(819) | 7201-27 | Table Screw Stud Nut (4)..... |
| 1484(809) | 7201-4 | Clamp Opening Lever Contact Piece Screw..... | 2018 | 1201-12 | Lateral Adjusting Lever Spacing Washer (For 421W303BA, 421W307BA and 421W311BA)..... |
| 1485(833) | 7201-21 | Button Clamp Guiding Screw (2 hole buttons) Guide Block Fastening Screw (2) (For 421W311BA)..... | 2026 | 7201-6 | Thread Nipper (back) Stud Spring.. |
| 1492(819) | 7201-6 | Needle Bar Take-up Thread Guide Plate Screw..... | 2102 | 7201-13 | Tension Disc (2)..... |
| 1513(819) | 7201-15 | Machine Pulley (loose) Encasing Arm Stud Lock Nut..... | 2270 | 7201-24 | Operating Equipment Rock Shaft Stop Dog with 140219(803) (2)..... |
| 1518(805) | 7201-14 | Starting Lever Stop Cam Interlocking Arm Stop Rod Nut (2)..... | 2718(819) | 7201-25 | Treadle Extension Screw Washer (2) |
| 1519(805) | 7201-10 | Lateral Rock Shaft Driven Arm Driving Link Screw Nut..... | 2807 | 7201-14 | Starting Lever Stop Cam Interlocking Arm Stop Rod Bumper Separating Washer (4)..... |
| 1521(819) | 7201-24 | Operating Equipment Cable Lock Nut (2)..... | 2921 | 7201-6 | Thread Nipper (back) Disc (2)..... |
| 1547(803) | 7201-8 | Knife Holder Screw Nut..... | 5968 | 7201-11 | Lateral Rock Shaft Cam Follower Roller Washer..... |
| 1560(803) | 7201-13 | Tension Regulating Thumb Nut..... | 5968 | 7201-11 | Longitudinal Rock Shaft Cam Follower Roller Washer..... |
| 1620(805) | 7201-12 | Lateral Adjusting Lever Hinge Screw Nut (For 421W303BA, 421W307BA and 421W311BA)..... | 7071 | 7201-8 | Knife Driving Bar Bumper Screw Washer..... |
| 1620(805) | 7201-12 | Longitudinal Adjusting Lever Handle Hinge Screw Nut (For 421W303BA, 421W307BA and 421W311BA)..... | 9281 | 7201-27 | Belt Tightener Hinge Plate Adjusting Screw Nut Washer (2)..... |
| 1654(803) | 7201-12 | Longitudinal Adjusting Lever Hinge Screw Nut (For 421W303BA, 421W307BA and 421W311BA)..... | 9842 | 7201-27 | Motor Bolt Washer..... |
| | | | 9842 | 7201-27 | Table Screw Stud Washer (4)..... |
| | | | 9875 | 7201-29 | Wrench..... |
| | | | 2162 | 7201-6 | Thread Nipper (back) Disc Guide Pin..... |
| | | | 2361-001 | 7201-23 | Machine Hinge Connection (2)..... |
| | | | 3288 | 7201-25 | Treadle Shaft Retaining Ring (4).. |
| | | | 3538 | 7201-6 | Thread Nipper (back) Stud Position Pin..... |
| | | | 3539 | 7201-6 | Thread Nipper (back) Stud Roller.. |
| | | | 3540 | 7201-6 | Thread Nipper (back) Stud Roller Pin..... |

| No. | Plate | Description | No. | Plate | Description |
|-------|---------|--|------------|---------|---|
| | | | 39241 | 7201-7 | Button Clamp Pressure Spring (For 421W303BA, 421W307BA and 421W311BA)..... |
| 14372 | 7201-25 | Treadle (2)..... | | | |
| 14373 | 7201-25 | Treadle Extension (2)..... | | | |
| 14375 | 7201-25 | Treadle Stand (2)..... | 39242 | 7201-5 | Button Clamp Spreader (For 421W303BA, 421W307BA and 421W311BA)..... |
| 16532 | 7201-19 | Arm Position Pin (2)..... | | | |
| 16532 | 7201-19 | Cylinder Position Pin (2)..... | | | |
| 17710 | 7201-7 | Clamp Arm Hinge Plate..... | 39335 | 7201-20 | Clamp Pressure Spring Screw Plate (For 421W301BA)..... |
| 17712 | 7201-20 | Clamp Pressure Spring (For 421W301BA)..... | 39453 | 7201-4 | Thread Wiper Body Finger..... |
| 17714 | 7201-5 | Clamp Pressure Spring Guide Block. | 45329 | 7201-5 | Button Clamp (left) Spring Position Pin (For 421W303BA, 421W307BA and 421W311BA)..... |
| 17718 | 7201-5 | Button Clamp Spreader Lever Adjusting Plate Screw Washer (For 421W303BA, 421W307BA and 421W311BA)..... | 45329 | 7201-5 | Button Clamp (right) Spring Position Pin (For 421W303BA, 421W307BA and 421W311BA)..... |
| 17718 | 7201-5 | Button Clamp Spreader Lever Stop Screw Washer (For 421W303BA, 421W307BA and 421W311BA)..... | 50018(806) | 7201-8 | Knife Holder Screw..... |
| 17718 | 7201-4 | Clamp Opening Lever Contact Piece Screw Washer..... | 50087(830) | 7201-13 | Thread Nipper (front) Lever Hinge Screw (right)..... |
| 17720 | 7201-5 | Button Clamp Spreader Steady Pin (short) (For 421W303BA, 421W307BA and 421W311BA)..... | 50117(833) | 7201-4 | Clamp Opening Lever Contact Piece Arm Screw..... |
| 17723 | 7201-5 | Button Clamp (left) Screw Stud (For 421W303BA, 421W307BA and 421W311BA)..... | 50150(830) | 7201-3 | Looper Set Screw..... |
| 17723 | 7201-5 | Button Clamp (right) Screw Stud (For 421W303BA, 421W307BA and 421W311BA)..... | 50150(830) | 7201-3 | Thread Nipper (back) Cam Set Screw (2)..... |
| 17905 | 7201-29 | Wrench..... | 50169(819) | 7201-6 | Needle Bar Thread Guide Screw..... |
| 17928 | 7201-20 | Clamp Position Stud (For 421W301BA)..... | 50237(833) | 7201-5 | Button Clamp Spreader Lever Stop Position Screw (For 421W303BA, 421W307BA and 421W311BA)..... |
| 20972 | 7201-13 | Tension Screw Stud 1110(803) with 1560(803)..... | 50446(803) | 7201-16 | Stop Motion Brake Shoe Support Hinge Screw..... |
| 22666 | 7201-25 | Treadle Shaft (2)..... | 50581(819) | 7201-25 | Treadle Extension Screw (2)..... |
| 23180 | 7201-25 | Treadle Stand Bolt Washer..... | 50650(803) | 7201-6 | Needle Bar Connecting Link Cap Screw..... |
| 23308 | 7201-29 | Screwdriver (8 in. blade)..... | 50807(819) | 7201-27 | Motor Bolt (4)..... |
| 23477 | 7201-3 | Needle Bar Crank with 858(830), 1065(830) and two 350812(869)..... | 51074(819) | 7201-25 | Treadle Stand Bolt (4)..... |
| 23535 | 7201-29 | Wrench..... | 51119(805) | 7201-9 | Tripping Rock Shaft Lever Arm Screw..... |
| 32134 | 7201-24 | Operating Equipment Rock Shaft Spring (2)..... | 51369(805) | 7201-8 | Throat Plate Screw (4)..... |
| 32803 | 7201-20 | Clamp complete, Nos. 202(819), 1182(819), 1656(819), 124646, 136873 and 167322 (For 421W301BA)..... | 51655(819) | 7201-27 | Belt Tightener Hinge Plate Adjusting Screw Nut (2)..... |
| 36696 | 7201-5 | Button Clamp (left) Pad Pin (3) (For 421W303BA, 421W307BA and 421W311BA)..... | 51657(803) | 7201-9 | Starting Lever Starting Rod Lock Nut..... |
| 36696 | 7201-5 | Button Clamp (right) Pad Pin (3) (For 421W303BA, 421W307BA and 421W311BA)..... | 51701(819) | 7201-8 | Knife Driving Bar Latch Spring Stud Screw (upper) Lock Nut..... |
| 37310 | 7201-11 | Lateral Rock Shaft Cam Follower | 51933 | 7201-3 | Needle Guide Oscillating Crank Roller and Stud..... |
| 37310 | 7201-21 | Roller Screw Stud Nut Washer..... | 51951 | 7201-11 | Lateral Rock Shaft Cam Follower Roller and Screw Stud, Nos. 1655(803), 5968 and 37310..... |
| 37310 | 7201-11 | Longitudinal Rock Shaft Cam Follower Roller Screw Stud Nut Washer..... | 51951 | 7201-11 | Longitudinal Rock Shaft Cam Follower Roller and Stud, Nos. 1655(803), 5968 and 37310..... |
| | | | 52843 | 7201-26 | Drip Pan Screw Washer (leather) (4)..... |
| | | | 53612(805) | 7201-20 | Lateral Rock Shaft Driving Arm Screw Stud Nut (For 421W301BA)..... |

| No. | Plate | Description | No. | Plate | Description |
|------------|---------|--|--------|---------|---|
| 53612(805) | 7201-20 | Longitudinal Rook Shaft Driving Arm Screw Stud Nut (For 421W303PA) | 131022 | 7201-14 | Starting Lever Stop Cam Interlocking Arm Stop Rod Bumper (rubber) (3)..... |
| 53617(805) | 7201-9 | Starting Lever Starting Rod Swivel Stud Lock Nut..... | 136598 | 7201-5 | Button Clamp (left) with 17723, 45329 and three 36696 (For 421W303BA, 421W307BA and 421W311BA)..... |
| 53618(805) | 7201-3 | Arm Shaft (horizontal) Bushing (back) Support Screw Lock Nut..... | | 7201-5 | Button Clamp (left) Spring (For 421W303BA, 421W307BA and 421W311BA)..... |
| 53626(803) | 7201-12 | Lateral Rook Shaft Driving Arm Screw Stud Nut (For 421W303PA, 421W307BA and 421W311BA)..... | 136600 | 7201-5 | Button Clamp (right) with 17723, 45329 and three 36696 (For 421W303BA, 421W307BA and 421W311BA)..... |
| 53626(803) | 7201-12 | Longitudinal Rook Shaft Driving Arm Screw Stud Nut (For 421W303PA, 421W307BA and 421W311BA)..... | 136601 | 7201-5 | Button Clamp (right) Spring (For 421W303BA, 421W307BA and 421W311BA)..... |
| 59704 | 7201-3 | Arm Shaft (upright)..... | | 7201-5 | Button Clamp (right) Spring (For 421W303BA, 421W307BA and 421W311BA)..... |
| 59707 | 7201-3 | Arm Shaft (upright) Bevel Gear (lower) with two 1253(830)..... | 136603 | 7201-5 | Button Clamp (right) Spring (For 421W303BA, 421W307BA and 421W311BA)..... |
| 59707 | 7201-3 | Looper Shaft Bevel Gear with two 1253(830)..... | | 7201-5 | Button Clamp Stop with 17720 and 63742 (For 421W303BA, 421W307BA and 421W311BA)..... |
| 59708 | 7201-3 | Arm Shaft (upright) Bevel Gear (upper) with two 1253(830)..... | 136608 | 7201-3 | Looper..... |
| 59739 | 7201-8 | Knife Holder Stud..... | 136618 | 7201-3 | Needle Guide Cam with two 195(803) |
| 59776 | 7201-6 | Thread Nipper (back) Stud with 13538..... | 136622 | 7201-3 | Thread Pull-off (rear)..... |
| 59777 | 7201-6 | Thread Nipper (back) Stud complete, Nos. 13539, 13540 and 59776 | 136677 | 7201-13 | Thread Nipper (back) Eyelet..... |
| 63741 | 7201-5 | Button Clamp Spreader Thumb Plate (For 421W303BA, 421W307BA and 421W311BA)..... | 136701 | 7201-3 | Arm Shaft (upright) 59704 with 59707 and 59708..... |
| 63742 | 7201-5 | Button Clamp Spreader Steady Pin (long) (For 421W303BA, 421W307BA and 421W311BA)..... | 136719 | 7201-13 | Thread Nipper (front) Thread Guide |
| 63825 | 7201-5 | Clamp Arm Hook Stud..... | 136778 | 7201-13 | Thread Pull-off (front)..... |
| 67425 | 7201-25 | Treadle Stand Bolt Lock Washer (4) | 136780 | 7201-3 | Arm Shaft (horizontal) Bevel Gear with two 141469(869)..... |
| 120342 | 7201-29 | Oiler with 120343..... | 136792 | 7201-3 | Arm Shaft (upright) Bushing (lower)..... |
| 120343 | 7201-29 | Oiler Spout (3-1/2 in. long)..... | 136793 | 7201-3 | Arm Shaft (upright) Bushing (upper) |
| 124646 | 7201-20 | Clamp with 1220(805) and 17928 (For 421W301BA)..... | 136794 | 7201-6 | Needle Bar Bushing (upper)..... |
| 124733 | 7201-5 | Button Clamp Opening Lever (For 421W303BA, 421W307BA and 421W311BA)..... | 136795 | 7201-13 | Thread Pull-off Bell Crank Hinge Stud..... |
| 124735 | 7201-4 | Clamp Opening Lever Contact Piece. | 136796 | 7201-9 | Tripping Rock Shaft Spacer..... |
| 124737 | 7201-5 | Button Clamp Spreader Lever (For 421W303BA, 421W307BA and 421W311BA)..... | 136797 | 7201-13 | Thread Nipper (front) Lever Rod Cam (driven with 202(805)..... |
| 124738 | 7201-5 | Button Clamp Spreader Lever Adjusting Plate (For 421W303BA, 421W307BA and 421W311BA)..... | 136799 | 7201-13 | Thread Pull-off Bell Crank Bracket |
| 124739 | 7201-5 | Button Clamp Spreader Lever Stop (For 421W303BA, 421W307BA and 421W311BA)..... | 136800 | 7201-8 | Knife Driving Bar Spring..... |
| 124740 | ----- | Button Clamp complete for 13 to 50 Ligne Thin Buttons (Optional Equip. for 421W303BA, 307BA and 311BA) | 136801 | 7201-7 | Button Clamp Guiding Screw (2 hole buttons) Drag Spring (For 421W303BA, 421W307BA and 421W311BA)..... |
| 124764 | 7201-3 | Looper Shaft Bushing (front)..... | 136802 | 7201-13 | Thread Nipper (front) Lever Rod Cam (driving) with 237(830)..... |
| 126150 | 7201-27 | Motor Bolt Nut Lock Washer (4).... | 136805 | 7201-13 | Thread Pull-off Bell Crank with 624(830)..... |
| 126150 | 7201-27 | Table Screw Stud Nut Lock Washer (4)..... | 136806 | 7201-13 | Thread Pull-off Bell Crank Extension..... |
| | | | 136807 | 7201-2 | Arm Cover (front)..... |
| | | | 136808 | 7201-3 | Looper Shaft Bushing (rear)..... |
| | | | | 7201-3 | Needle Guide Shaft Bushing..... |

| No. | Plate | Description | No. | Plate | Description |
|--------|---------|--|--------|---------|---|
| 136809 | ----- | Pair of Gears, for upper shaft, Nos. 59708 and 136792..... | 136855 | 7201-8 | Tripping Rock Shaft Bracket..... |
| 136810 | 7201-6 | Thread Nipper (back) Adapter Block with 1454(830)..... | 136856 | 7201-8 | Knife Driving Bar Stop (in bracket)..... |
| 136811 | 7201-3 | Thread Nipper (back) Cam with two 50150(830)..... | 136857 | 7201-8 | Knife Driving Bar..... |
| 136812 | 7201-13 | Thread Pull-off Bell Crank Connection..... | 136858 | 7201-2 | Arm Cover (front) complete, Nos. 230(805), 136806, 136888, 140438(819), 175062, 175063, 175065, 202098, 223711, 228739, two each 185(809) and 136818..... |
| 136813 | 7201-13 | Thread Pull-off Bell Crank Bracket Mounting Screw Spacer..... | 136859 | 7201-4 | Thread Pull-off Driving Lever with 208(830) and two 140321(830) (NOTE: Screw 208(830) has no application for this machine.).... |
| 136815 | 7201-8 | Knife Cocking Lever Multiplier with 1226(803)..... | 136861 | ----- | Arm Shaft (horizontal) with 23477. |
| 136816 | 7201-8 | Knife Driving Bar Latch with 171(819) and 51701(819)..... | 136863 | 7201-18 | Feed Cam with two 167234 and four each 140352(830) and 167235 (For 421W307BA)..... |
| 136818 | 7201-2 | Arm Cover (front) Thread Retainer Screw Washer (2)..... | 136864 | 7201-13 | Thread Nipper (front) and Thread Pull-off complete, Nos. 176(819), 846(803), 1282(803), 1454(830), 1747(809), 20972, 50087(830), 136677, 136778, 136780, 136796, 136799, 136800, 136803, 136804, 136805, 136812, 136852, 136870, 136871, 136872, 140431(803), 156316, 156376, 175032, 175179, 175182 and two 2102..... |
| 136820 | 7201-8 | Knife Cocking Lever with 769(850) and 1698(805)..... | 136868 | 7201-8 | Knife Driving Bar Latch Spring.... |
| 136821 | 7201-8 | Knife Driver (adjustable)..... | 136870 | 7201-13 | Thread Nipper (front) Lever..... |
| 136823 | 7201-8 | Knife Holder..... | 136871 | 7201-13 | Thread Nipper (front) Lever Block. |
| 136824 | 7201-10 | Lateral Pivot and Feed Plate..... | 136872 | 7201-13 | Thread Nipper (front) Lever Block Pivot Pin..... |
| 136826 | 7201-10 | Carrier Bar Connecting Arm..... | 136873 | 7201-20 | Clamp Arm with 17714 (For 421W301BA)..... |
| 136827 | 7201-7 | Lateral Feed Throw-out Collar (For 421W303BA and 421W307BA)..... | 136874 | 7201-20 | Feed Plate (for 421W301BA)..... |
| 136828 | 7201-7 | Button Clamp Guiding Screw (2 hole buttons) Holder (For 421W303BA, 421W307BA and 421W311BA)..... | 136875 | ----- | Feed Plate Carrier Bar 167029 with 136874, 141071(819), 167041 and 167055 (For 421W301BA)..... |
| 136829 | 7201-10 | Button Clamp Guiding Screw (2 hole buttons) Stop (For 421W303BA, 421W307BA and 421W311BA)..... | 136876 | ----- | Feed Cam with four 167234 and eight each 140352(830) and 167235 (For 421W301BA)..... |
| 136829 | 7201-10 | Lateral Pivot Driving Arm (For 421W303BA and 421W307BA)..... | 136877 | ----- | Feed Cam with two 167234 and four each 140352(830) and 167235 (For 421W303BA)..... |
| 136830 | 7201-10 | Lateral Pivot Driving Arm 136829 with 1519(805), 136826, 141075(803), 214529, 239266, 350802(830) and three 350800(869) (For 421W303BA and 421W307BA)..... | 136879 | 7201-21 | Longitudinal Rock Shaft (driving) (For 421W311BA)..... |
| 136831 | 7201-3 | Looper Shaft with 50150(830)..... | 136880 | ----- | Longitudinal Rock Shaft (driving) 136879 with 51951 (For 421W311BA). |
| 136839 | 7201-13 | Thread Pull-off Bell Crank Bracket Stabilizing Pin..... | 136881 | 7201-21 | Longitudinal Rock Shaft (driven) (For 421W311BA)..... |
| 136842 | 7201-3 | Needle Guide complete with Thread Finger, Nos. 136889, 175131 and two 218(804)..... | 136882 | 7201-21 | Longitudinal Rock Shaft (driven) Coupling with 140409(869) (For 421W311BA)..... |
| 136846 | ----- | Arm Plug (right)..... | | | |
| 136847 | 7201-6 | Needle Bar Take-up complete, Nos. 1492(819), 136848, 175100 and 175101..... | | | |
| 136848 | 7201-6 | Needle Bar Take-up with 160(805).. | | | |
| 136849 | 7201-6 | Thread Nipper (back) Body..... | | | |
| 136850 | 7201-6 | Thread Nipper (back) complete, Nos. 1654(809), 1743(809), 2026, 12162, 59777, 136701, 136810, 136849 and two 2921..... | | | |
| 136852 | 7201-13 | Thread Nipper (front) Lever Rod... | | | |
| 136854 | 7201-1 | Cylinder Cover (bottom) | | | |

| No. | Plate | Description | No. | Plate | Description |
|-------------|---------|---|-------------|---------|--|
| 136886 | 7201-8 | Throat Plate..... | | | |
| 136888 | 7201-2 | Arm Cover (front) Thread Guide (wire)..... | 140321(830) | 7201-11 | Longitudinal Rock Shaft Collar Set Screw (2) (For 421W301BA, 421W303BA and 421W307BA)..... |
| 136889 | 7201-3 | Needle Guide Thread Finger..... | | | |
| 136890 | 7201-4 | Clamp Foot Lifter..... | 140321(830) | 7201-24 | Operating Equipment Rock Shaft Collar Set Screw (4)..... |
| 136891 | 7201-4 | Thread Wiper complete, Nos. 330(809), 39453, 136890, 141084(803), 141574(803), 167174, 167354, 239336 and 239387..... | 140321(830) | 7201-4 | Thread Pull-off Driving Lever Set Screw (2)..... |
| 136892 | 7201-8 | Knife Driving Bar Stop (nylon).... | 140352(830) | 7201-18 | Feed Cam Tripping Point Screw (4) (NOTE: For 421W301BA (8)..... |
| 136893 | 7201-7 | Feed Plate..... | 140409(869) | 7201-21 | Longitudinal Rock Shaft (driven) Coupling Set Screw (For 421W311BA) |
| 136894 | 7201-8 | Knife Driving Bar Bumper (nylon).. | | | |
| 136895 | 7201-8 | Knife Driving Bar Bumper Screw Nut | 140427(830) | 7201-16 | Starting Lever Arm and Rock Shaft Stop Screw..... |
| 136896 | 7201-8 | Knife Driving Bar Bumper complete, Nos. 1289(819), 7071, 136894 and 136895..... | 140431(803) | 7201-13 | Thread Nipper (front) Thread Guide Screw..... |
| 136897 | ----- | Feed Cam with two 167234 and four each 140352(830) and 167235 (For 421W311BA)..... | 140438(819) | 7201-2 | Arm Cover (front) Thread Guide (wire) Screw..... |
| 136898 | 7201-7 | Button Clamp Guiding Screw (2 hole button) Guide Block..... | 141059(830) | 7201-4 | Clamp Lifting Rock Shaft Lifting Link Connection Screw..... |
| 136899 | 7201-7 | Cylinder Cover Plate (top) | 141060(819) | 7201-1 | Arm Cover (side) Screw (4)..... |
| 136902 | 7201-16 | Starting Lever Arm and Rock Shaft with 170(805), 1664(803) and 140427(830)..... | 141061(803) | 7201-3 | Arm Shaft (horizontal) Bushing (back) Set Screw..... |
| 136903 | 7201-16 | Starting Lever Arm (operated) with 350600(869)..... | 141061(803) | 7201-4 | Clamp Lifting Bar Stop Screw..... |
| 136904 | 7201-7 | Feed Plate Carrier Bar 167029 with 136899, 141071(819) and 167055 (For 421W303BA, 421W307BA and 421W311BA)..... | 141066(803) | 7201-19 | Cylinder Base Locating Screw (4).. |
| 136907 | 7201-8 | Knife (thread cutting)..... | 141067(805) | 7201-19 | Cylinder Base Locking Screw..... |
| 136908 | 7201-8 | Knife (thread cutting) Mounting Fork..... | 141069(869) | 7201-19 | Arm Screw (3)..... |
| 136909 | 7201-3 | Needle Guide Oscillating Crank with 1057(830) and 51933..... | 141069(869) | 7201-19 | Cylinder Screw (2)..... |
| 136910 | 7201-8 | Throat Plate Complete, Nos. 1547(803), 50018(806), 59739, 136823, 136886, 136907, 136908 136911, 136912 and two 1034(805).. | 141069(869) | 7201-17 | Feed Cam Supporting Gear Bracket Screw..... |
| 136911 | 7201-8 | Thread Separator..... | 141070(803) | 7201-17 | Feed Cam Supporting Gear Screw.... |
| 136912 | 7201-8 | Thread Separator Screw Washer.... | 141071(819) | 7201-7 | Feed Plate Carrier Bar Driving Block Screw..... |
| 136913 | 7201-21 | Button Clamp Guiding Screw (2 hole buttons) Guide Block (For 421W311BA)..... | 141075(803) | 7201-10 | Lateral Rock Shaft Driven Arm Driving Link Screw..... |
| 140049(805) | 7201-8 | Knife Driving Bar Stop Screw..... | 141076(830) | 7201-3 | Arm Shaft (horizontal) Bushing (center) Set Screw..... |
| 140082(819) | 7201-1 | Arm Cover (center) Screw (2)..... | 141076(830) | 7201-11 | Lateral Rock Shaft Driven Arm Hinge Stud Set Screw..... |
| 140159(830) | 7201-8 | Knife Cooking Lever Screw (2)..... | 141076(830) | 7201-11 | Longitudinal Rock Shaft Driven Arm Hinge Stud Set Screw..... |
| 140219(803) | 7201-24 | Operating Equipment Rock Shaft Stop Dog Set Screw (2)..... | 141077(830) | 7201-14 | Starting Lever Pushing Set Screw.. |
| 140220(819) | 7201-13 | Thread Pull-off Bell Crank Bracket Mounting Screw..... | 141084(803) | 7201-4 | Thread Wiper Body Hinge Screw..... |
| 140321(830) | 7201-11 | Lateral Rock Shaft Collar Set Screw (2)..... | 141093(830) | 7201-23 | Belt Guard Hinge Pin Set Screw.... |
| | | | 141093(830) | 7201-9 | Tripping Rock Shaft Support Screw. |
| | | | 141099(805) | 7201-14 | Starting Lever Return Spring Screw Stud (upper) (2)..... |
| | | | 41100(850) | 7201-16 | Starting Lever Starting Rod Adjuster Hinge Screw..... |
| | | | 41101(803) | 7201-16 | Stop Motion Brake Shoe Support Bracket Pressure Spring Adjusting Screw..... |
| | | | 41103(850) | 7201-23 | Belt Guard Lock Spring Plate Screw (2)..... |

350819
7201-8

| No. | Plate | Description | No. | Plate | Description |
|-------------|---------|---|--------|---------|--|
| 141128(833) | 7201-3 | Arm Shaft (horizontal) Bushing (back) Support Screw..... | 151220 | 7201-27 | Belt Tightener Hinge Plate Adjusting Screw Hinge Bracket..... |
| 141140(819) | 7201-1 | Cylinder Cover (bottom) Screw (?) | 151221 | 7201-27 | Belt Tightener Motor Plate Hinge Bracket..... |
| 141211(869) | 7201-7 | Clamp Pressure Spring Screw (For 421W303BA, 421W307BA and 421W311BA)..... | 151222 | 7201-27 | Belt Tightener Motor Plate Hinge Bracket Pin..... |
| 141406(830) | 7201-4 | Thread Wiper Body Support Set Screw..... | 151223 | 7201-27 | Belt Tightener complete, Nos. 51655(819), 150783, 151066, 151219, 151220, 151221, 151222, two each 9281, 151068, four each 50807(819), 151369 and eight each 1778(819), 9842 and 126150..... |
| 141407(869) | 7201-3 | Vertical Drive Shaft Worm Position Screw..... | 151369 | 7201-27 | Table Screw Stud (4)..... |
| 141407(869) | 7201-17 | Vertical Drive Shaft Worm Gear Position Screw..... | 151633 | 7201-24 | Operating Equipment Cable Yoke End Pin (2)..... |
| 141408(869) | 7201-3 | Vertical Drive Shaft Worm Set Screw..... | 154305 | 7201-22 | Gauge Pin..... |
| 141408(869) | 7201-17 | Vertical Drive Shaft Worm Gear Set Screw..... | 154308 | 7201-22 | Set of Gauges for Centralizing Feed Mechanism (furnished upon request only)..... |
| 141449(803) | 7201-9 | Starting Bell Crank Pawl Hinge Screw..... | 154355 | 7201-22 | Gauge Pin Spring Plunger..... |
| 141450(803) | 7201-9 | Starting Bell Crank Hinge Screw... | 156316 | 7201-13 | Tension Thread Guide..... |
| 141469(869) | 7201-3 | Arm Shaft (horizontal) Bevel Gear Set Screw (2)..... | 156376 | 7201-13 | Tension Spring..... |
| 141545(803) | 7201-12 | Lateral Adjusting Lever Hinge Screw (For 421W303BA, 421W307BA and 421W311BA)..... | 167004 | 7201-4 | Clamp Lifting Rock Shaft with 141059(830)..... |
| 141545(803) | 7201-12 | Longitudinal Adjusting Lever Handle Hinge Screw (For 421W303BA, 421W307BA and 421W311BA)..... | 167006 | 7201-4 | Clamp Lifting Rock Shaft Lifting Arm with 350604(869)..... |
| 141550(803) | 7201-12 | Longitudinal Adjusting Lever Hinge Screw (For 421W303BA, 421W307BA and 421W311BA)..... | 167007 | 7201-4 | Clamp Lifting Rock Shaft Lifting Link..... |
| 141574(803) | 7201-4 | Thread Wiper Body Wire Clamping Plate Screw..... | 167012 | 7201-3 | Arm Shaft (horizontal) Bushing (back)..... |
| 149426 | 7201-22 | Starting Lever Return Spring (Not for 421W301BA Machine)..... | 167013 | 7201-3 | Arm Shaft (Horizontal) Bushing back) 167012 with 53618(805), 141128(833), 202299, 239374 and two 239383..... |
| 149797 | 7201-10 | Lateral Feed Throw-out Collar Retaining Ring (For 421W303BA and 421W307BA)..... | 167017 | 7201-3 | Arm Shaft (upright) Hole Cover.... |
| 150203 | 7201-28 | Thread Unwinder Spool Rest Cushion (felt)..... | 167017 | 7201-3 | Thread Nipper (back) Cam Access Hole Cover..... |
| 150701 | 7201-27 | Belt Tightener Hinge Plate Adjusting Screw..... | 167029 | 7201-7 | Feed Plate Carrier Bar..... |
| 150750 | ----- | Machine Driving Bolt 50 inch outside length for "V" Drive Machine Pulleys..... | 167038 | 7201-4 | Thread Wiper Body Support 167174 with 141084(803), 141574(803), 167354, 239336 and 239387..... |
| 150783 | 7201-27 | Belt Tightener Hinge Plate Adjusting Screw 150701 with 51655(819).. | 167041 | 7201-20 | Cylinder Cover (top) (For 421W301BA)..... |
| 151066 | 7201-27 | Belt Tightener Hinge Plate Adjusting Screw Hinge Pin..... | 167044 | 7201-3 | Vertical Drive Shaft Worm with 141407(869) and 141408(869) (For 421W307BA and 421W311BA)..... |
| 151068 | 7201-27 | Belt Tightener Hinge Plate Adjusting Screw Hinge Pin Retaining Ring (2)..... | 167048 | 7201-20 | Lateral Rock Shaft Driving Arm Screw Stud (For 421W301BA)..... |
| 151219 | 7201-27 | Belt Tightener Motor Plate..... | 167048 | 7201-20 | Longitudinal Rock Shaft Driving Arm Screw Stud (For 421W301BA).... |
| | | | 167049 | 7201-3 | Arm Shaft (horizontal) Bushing (Center)..... |
| | | | 167050 | 7201-17 | Feed Cam Supporting Gear Bracket.. |

| No. | Plate | Description | No. | Plate | Description |
|------------|---------|--|------------|---------|---|
| 167054 | 7201-7 | Feed Plate Carrier Bar Driving Block with 239501..... | 167161 | 7201-16 | Stop Motion Brake Shoe Support Bracket 167159 with 50446(803), 141101(803), 223812, 239513 and 239557..... |
| 167055 | 7201-7 | Feed Plate Carrier Bar Driving Block complete, Nos. 167054 and 167056..... | 167168 | 7201-6 | Thread Retainer (back)..... |
| 167056 | 7201-7 | Feed Plate Carrier Bar Driving Block Spacer..... | 167174 | 7201-4 | Thread Wiper Body Support..... |
| 167073 | 7201-17 | Vertical Drive Shaft Worm Gear with 141407(869) and 141408(869) (For 421W307BA and 421W311BA)..... | 167181 | 7201-9 | Tripping Rock Shaft..... |
| 167075 | 7201-21 | Lateral Pivot Driving Arm with 350600(869) (For 421W301BA and 421W311BA)..... | 167182 | 7201-9 | Tripping Rock Shaft Collar with two 460(830)..... |
| 167076 | 7201-21 | Lateral Pivot Driving Arm 167055 with 1519(805), 141075(803) and 239266 (For 421W301BA and 421W311BA)..... | 167186 | 7201-28 | Thread Unwinder Thread Guide..... |
| 167077 | 7201-19 | Vertical Drive Shaft Worm with 141407(869) and 141408(869) (For 421W301BA and 421W303BA)..... | 167187 | 7201-23 | Belt Guard with 141093(830)..... |
| 167079 | 7201-19 | Vertical Drive Shaft Worm Gear with 141407(869) and 141408(869) (For 421W301BA and 421W303BA)..... | 167188 | 7201-23 | Belt Guard Lock Spring Plate..... |
| 167084 | 7201-15 | Machine Pulley (loose) Engaging Arm Stud..... | 167189 | 7201-23 | Belt Guard complete, Nos. 167187, 167188, 239356, 239357 and two 141103(850)..... |
| 167086 | 7201-6 | Needle Bar..... | 167226-001 | 7201-24 | Operating Equipment Cable (long) (2)..... |
| 167087 | 7201-6 | Needle Bar 167086 with 209(833), 50169(819) and 239376..... | 167229 | 7201-16 | Stop Motion Brake Shoe Support Bracket Pressure Spring..... |
| 167088 | 7201-6 | Needle Bar Connecting Link 271597 with 50650(803), 167089-001 and 239385..... | 167234 | 7201-18 | Feed Cam Tripping Point (2) (NOTE: For 421W301BA (4)..... |
| 167089-001 | 7201-6 | Needle Bar Connecting Stud with 175(830) and 239277..... | 167235 | 7201-18 | Feed Cam Tripping Point Screw Washer (4) (NOTE: For 421W301BA (8)..... |
| 167143 | 7201-9 | Starting Bell Crank..... | 167260 | 7201-29 | Wrench..... |
| 167144 | 7201-9 | Starting Bell Crank 167143 with 51657(803), 53617(805), 167154 and 167155..... | 167261 | 7201-28 | Thread Unwinder (for one spool) complete, Nos. 150203, 167186, 228764, 228765, 228767, 228768, 228770, 228774 and three wood screws 7/8 in. No. 12 R.H.B..... |
| 167145 | 7201-14 | Starting Lever with 141077(830).... | 167277 | 7201-4 | Clamp Lifting Rock Shaft Collar (knurled) with 465(830)..... |
| 167146 | 7201-14 | Starting Lever 167145 with 239159, 239307 and two each 141099(805) and 214053..... | 167278 | 7201-4 | Clamp Lifting Rock Shaft Collar (knurled) Spring..... |
| 167148 | 7201-16 | Starting Lever Arm (operated) Key. | 167292 | 7201-19 | Thread Unwinder Mounting Bracket with 462(830) (NOTE: Screw 462(830) has no application for this machine.)..... |
| 167154 | 7201-9 | Starting Lever Starting Rod..... | 167317 | 7201-5 | Button Clamp (left) Adjusting Spring (For 421W303BA, 421W307BA and 421W311BA)..... |
| 167155 | 7201-9 | Starting Lever Starting Rod Adjuster..... | 167319 | 7201-5 | Button Clamp (right) Adjusting Spring (For 421W303BA, 421W307BA and 421W311BA)..... |
| 167157 | 7201-14 | Starting Lever Stop Cam Interlocking Arm Stop Rod Swivel..... | 167320 | 7201-5 | Button Clamp Arm with 17714 (For 421W303BA, 421W307BA and 421W311BA)..... |
| 167159 | 7201-16 | Stop Motion Brake Shoe Support Bracket with 171(830) and 201(804) | 167321 | 7201-5 | Button Clamp Arm complete, Nos. 202(819), 1182(819), 167320 and 167322 (For 421W303BA, 421W307BA and 421W311BA)..... |
| 167160 | 7201-14 | Starting Lever Stop Cam Interlocking Arm Stop Rod Swivel Retaining Ring..... | 167322 | 7201-5 | Clamp Arm Hook with 63825..... |
| | | | | 7201-20 | |

| No. | Plate | Description | No. | Plate | Description |
|--------|---------|--|--------|---------|---|
| 167323 | 7201-5 | Button Clamp Opening Lever Bracket (For 421W303BA, 421W307BA and 421W311BA)..... | 167446 | 7201-14 | Starting Lever Stop Cam Interlocking Arm Stop Rod complete, Nos. 167445, 202342, 239518 and 239519. |
| 167324 | 7201-5 | Button Clamp Spreader Spring (For 421W303BA, 421W307BA and 421W311BA)..... | 167447 | 7201-14 | Starting Lever Stop Cam Interlocking Arm Stop Rod complete, Nos. 167157, 167445, 202342, 239518, 239519, two 1518(805), three 131022 and four 2807..... |
| 167325 | 7201-5 | Button Clamp complete, Nos. 99(819), 202(819), 1181(819), 1183(819), 1199(819), 39242, 50237(833), 63741, 124733, 124737, 124738, 124739, 136598, 136600, 136601, 136603, 136608, 167317, 167319, 167320, 167322, 167323, 167324, two each 230(819), 1175(850), 17718 and four 1182(819) (For 421W303BA, 421W307BA and 421W311BA)..... | 167448 | 7201-26 | Machine Base Oil Drain Jar (plastic)..... |
| | | | 167449 | 7201-12 | Lateral Rock Shaft Driving Arm Screw Stud Nut Washer (For 421W303BA, 421W307BA and 421W311BA)..... |
| 167329 | 7201-12 | Longitudinal Adjusting Lever (For 421W303BA, 421W307BA and 421W311BA)..... | 167449 | 7201-12 | Longitudinal Rock Shaft Driving Arm Screw Stud Nut Washer (For 421W303BA, 421W307BA and 421W311BA)..... |
| 167330 | 7201-12 | Adjusting Device complete Nos. 1654(803), 2018, 141550(803), 167329, 239533, 239534, 239536, two each 1620(805), 53626(803), 141545(803), 167335, 167449, 350812(869) and three each 167459 and 202622 (For 421W303BA, 421W307BA and 421W311BA)..... | 167458 | 7201-14 | Starting Lever with Starting Lever Stop Cam Interlocking Arm Stop Rod complete, Nos. 167145, 167157, 167160, 167445, 202342, 239159, 239307, 239518, 239519, two each 1518(805), 141099(805), 214053, three 131022 and four 2807..... |
| 167335 | 7201-12 | Lateral Rock Shaft Driving Arm Screw Stud (For 421W303BA, 421W307BA and 421W311BA)..... | 167459 | 7201-12 | Lateral Adjusting Lever Hinge Screw Friction Washer (For 421W303BA, 421W307BA and 421W311BA)..... |
| 167335 | 7201-12 | Longitudinal Rock Shaft Driving Arm Screw Stud (For 421W303BA, 421W307BA and 421W311BA)..... | 167459 | 7201-12 | Longitudinal Adjusting Lever Handle Hinge Screw Friction Washer (For 421W303BA, 421W307BA and 421W311BA)..... |
| 167354 | 7201-4 | Thread Wiper Body Wire (adjustable)..... | 167459 | 7201-12 | Longitudinal Adjusting Lever Hinge Screw Friction Washer (For 421W303BA, 421W307BA and 421W311BA)..... |
| 167414 | 7201-9 | Starting Bell Crank Pawl Hinge Screw 141449(803) with 1662(805).... | 175032 | 7201-13 | Thread Nipper (front) Lever Rod Spring Washer..... |
| 167415 | 7201-9 | Starting Bell Crank Hinge Screw 141450(803) with 1662(805)..... | 175062 | 7201-2 | Arm Cover (front) Thread Guide Plate..... |
| 167416 | 7201-11 | Lateral Rock Shaft Collar with two 140321(830)..... | 175063 | 7201-2 | Arm Cover (front) Thread Guide Plate Screw Spacing Collar..... |
| 167416 | 7201-11 | Longitudinal Rock Shaft Collar with two 140321(830) (For 421W301BA, 421W303BA and 421W307BA)..... | 175065 | 7201-2 | Arm Cover (front) Thread Guide Roller Pin..... |
| 167416 | 7201-24 | Operating Equipment Rock Shaft Collar with two 140321(830) (2)..... | 175100 | 7201-6 | Needle Bar Take-up Thread Guide Plate..... |
| 167426 | ----- | Clamp complete 32803 with 1176(819), 1177(819), 1178(819), 17710, 17712, 39335, 136875 and 239572 (For 421W301BA)..... | 175101 | 7201-6 | Needle Bar Take-up Thread Guide Plate Roller..... |
| | | | 175131 | 7201-3 | Needle Guide Pin..... |
| | | | 175175 | 7201-8 | Knife Cooking Lever Screw Washer (2)..... |
| 167445 | 7201-14 | Starting Lever Stop Cam Interlocking Arm Stop Rod..... | 175179 | 7201-13 | Thread Nipper (front) Lever Rod Spring..... |

| No. | Plate | Description | No. | Plate | Description |
|-------------|---------|--|--------|---------|--|
| 175182 | 7201-13 | Thread Nipper (front) Lever Rod | 210958 | 7201-2 | Arm Cover (front) Thread Retainer Stud Collar..... |
| 200072(803) | 7201-4 | Spring Collar with 465(R30)..... | 210993 | 7201-2 | Arm Cover (front) Thread Retainer Sleeve..... |
| 200184(819) | 7201-22 | Clamp Lifting Bar Position Guide Clamping Screw..... | 214053 | 7201-14 | Starting Lever Return Spring (2).. |
| 200246(803) | 7201-26 | Eye Guard Bracket Screw (2)..... | 214529 | 7201-10 | Lateral Feed Throw-out Screw Drag Spring (For 421W303BA and 421W307BA)..... |
| 200273(819) | 7201-22 | Machine Tilting Latch Lever Screw.. | | 7201-21 | Longitudinal Feed Throw-out Screw Drag Spring (For 421W311BA)..... |
| 200397(833) | 7201-2 | Eye Guard Bracket Hinge Screw..... | 214529 | 7201-2 | Arm Cover (front) Thread Retainer with 200397(833)..... |
| 201188(803) | 7201-4 | Arm Cover (front) Thread Retainer Stud Set Screw..... | 223710 | 7201-2 | Arm Cover (front) Thread Retainer complete, Nos. 210957, 210958, 210993, 223710 and 223844..... |
| 201254(830) | 7201-28 | Clamp Lifting Rock Shaft Collar Set Screw..... | 223711 | 7201-2 | Stop Motion Brake Shoe Support Spring..... |
| 201308(805) | 7201-26 | Thread Unwinder Spool Rest Set Screw..... | 223812 | 7201-2 | Arm Cover (front) Thread Retainer Spring..... |
| 201356(805) | 7201-4 | Starting Lever Lifting Rod Operating Lever Arm Screw Stud..... | 223844 | 7201-3 | Arm Shaft (horizontal) Bushing (center) Oil Packing (wick)..... |
| 202005 | 7201-17 | Feed Cam Supporting Gear Bracket Washer..... | 223847 | 7201-3 | Arm Shaft (horizontal) Bushing (front) Oil Packing (wick)..... |
| 202098 | 7201-2 | Arm Cover (front) Thread Guide Roller..... | 223847 | 7201-29 | Screwdriver..... |
| 202299 | 7201-3 | Arm Shaft (horizontal) Pushing (back) Oil Packing (wick)..... | 225498 | 7201-29 | Wrench..... |
| 202342 | 7201-14 | Starting Lever Stop Cam Interlocking Arm Stop Rod Hinge Pin Tension Spring..... | 225554 | 7201-22 | Eye Guard Bracket Spring Washer... |
| 202423 | 7201-11 | Lateral Rock Shaft Driven Arm Hinge Stud Oil Packing (wick)..... | 226467 | 7201-26 | Machine Cushion (4)..... |
| 202423 | 7201-11 | Longitudinal Rock Shaft Driven Arm Hinge Stud Oil Packing (wick)..... | 228444 | 7201-29 | Screwdriver..... |
| 202622 | 7201-12 | Lateral Adjusting Lever Hinge Screw Nut Washer (For 421W303BA, 421W307BA and 421W311BA)..... | 228476 | 7201-2 | Arm Cover (front) Thread Eyelet... |
| 202622 | 7201-12 | Longitudinal Adjusting Lever Handle Spacing Washer (For 421W303BA, 421W307BA and 421W311BA)..... | 228739 | 7201-28 | Thread Unwinder Spool Pin..... |
| 202622 | 7201-12 | Longitudinal Adjusting Lever Handle Hinge Screw Nut Washer (For 421W303BA, 421W307BA and 421W311BA)..... | 228764 | 7201-28 | Thread Unwinder Spool Rest with 201254(830)..... |
| 202784 | 7201-24 | Operating Equipment Chain Hook (4) | 228765 | 7201-28 | Thread Unwinder Spool Rest Rod.... |
| 203172 | 7201-3 | Needle Bar Crank Friction Washer.. | 228767 | 7201-28 | Thread Unwinder Spool Stand..... |
| 203637 | 7201-26 | Drip Pan Screw Washer (4)..... | 228768 | 7201-28 | Thread Unwinder Thread Guide Holder (for one or two guides).... |
| 210805 | 7201-18 | Feed Cam Mounting Screw Washer (3) | 228774 | 7201-28 | Thread Unwinder Thread Guide Rod.. |
| 210805 | 7201-20 | Lateral Rock Shaft Driving Arm Screw Stud Nut Washer (For 421W301BA)..... | 228785 | 7201-26 | Drip Pan..... |
| 210805 | 7201-20 | Longitudinal Rock Shaft Driving Arm Screw Stud Nut Washer (For 421W301BA)..... | 228786 | 7201-26 | Machine Support (left)..... |
| 210957 | 7201-2 | Arm Cover (front) Thread Retainer Stud..... | 228788 | 7201-26 | Machine Tilting Latch Lever complete..... |
| | | | 228789 | 7201-26 | Machine Tilting Latch Lever Spring |
| | | | 228802 | 7201-24 | Operating Equipment Chain with two 202784 (2)..... |
| | | | 228805 | 7201-24 | Operating Equipment Rock Shaft Lever Arm (4)..... |
| | | | 228806 | 7201-24 | Operating Equipment Rock Shaft Lever Arm Bracket with two 356(803) (4)..... |
| | | | 228807 | 7201-24 | Operating Equipment complete, Nos. two each 2770, 32134, 167416, 228802, 228811, 228861 and four each 228805 and 228806..... |

| No. | Plate | Description | No. | Plate | Description |
|------------|---------|---|--------|---------|---|
| 228809 | 7201-26 | Machine Support (right) with two wood screws 1-1/4 in. No. 12 F.H.. | 239267 | 7201-11 | Lateral Rock Shaft Driven Arm Hinge Stud with 202423..... |
| 228811 | 7201-24 | Operating Equipment Rock Shaft (2) | 239267 | 7201-11 | Longitudinal Rock Shaft Driven Arm Hinge Stud with 202423..... |
| 228822 | 7201-25 | Treadle complete, Nos. 2718(819), 14372, 14373, 14375, 22666, 50581(819) and two each 13288, 23180, 51074(819) and 67425 (2)... | 239268 | 7201-11 | Lateral Rock Shaft Driving Arm with 350604(869) (For 421W301BA).. |
| 228858 | 7201-24 | Operating Equipment Cable Yoke End. (2)..... | 239268 | 7201-11 | Longitudinal Rock Shaft Driving Arm with 350604(869) (For 421W301BA)..... |
| 228861 | 7201-24 | Operating Equipment Cable (adjustable) complete, Nos. 1521(819), 151633, 167226-001 and 228858 (2). | 239273 | 7201-6 | Needle Bar Pushing (lower)..... |
| 228865 | 7201-26 | Machine Support (left) 228786 with two wood screws 1-1/4 in. No. 12 F.H..... | 239277 | 7201-6 | Needle Bar Connecting Stud Oil Packing (wick)..... |
| 228910 | 7201-24 | Operating Equipment Chain (24 in. long) (2)..... | 239294 | 7201-9 | Starting Bell Crank Pawl..... |
| 239123 | 7201-4 | Clamp Opening Lever Contact Piece Arm..... | 239295 | 7201-9 | Starting Bell Crank Pawl Hinge Screw Return Spring..... |
| 239144 | 7201-11 | Longitudinal Rock Shaft (driving). 239384 with 51951 (For 421W301BA, 421W303BA and 421W307BA)..... | 239299 | 7201-9 | Starting Lever Arm Lifting Rod.... |
| 239159 | 7201-14 | Starting Lever Stop Cam Interlocking Arm..... | 239301 | 7201-14 | Starting Lever Bushing..... |
| 239160 | 7201-11 | Lateral Rock Shaft 239264 with 51951..... | 239303 | 7201-4 | Starting Lever Lifting Rod Operating Lever Arm..... |
| 239211 | 7201-4 | Clamp Lifting Bar with 176(819)... | 239307 | 7201-14 | Starting Lever Stop Cam Interlocking Arm Retaining Ring..... |
| 239212 | 7201-4 | Clamp Lifting Bar Bushing (lower). | 239314 | 7201-3 | Machine Pulley (tight) Key..... |
| 239213 | 7201-4 | Clamp Lifting Bar Position Guide with 167007, 200072(803) and 239515..... | 239315 | 7201-3 | Machine Pulley (loose) Retaining Ring..... |
| 239214 | 7201-4 | Clamp Lifting Bar Spring..... | 239315 | 7201-3 | Machine Pulley (tight) Retaining Ring..... |
| 239218 | 7201-4 | Clamp Lifting Rock Shaft Lifting Link Connection..... | 239317 | 7201-15 | Machine Pulley (loose)..... |
| 239221 | 7201-1 | Arm Cover (center)..... | 239318 | 7201-15 | Machine Pulley (loose) 239317 with 239322..... |
| 239223-451 | 7201-1 | Arm Cover (side) (For 421W307BA).. | 239320 | 7201-15 | Machine Pulley (loose) Engaging Arm Wear Block..... |
| 239223-452 | 7201-1 | Arm Cover (side) (For 421W301BA).. | 239321 | 7201-15 | Machine Pulley (loose) Engaging Arm Wear Block Pin..... |
| 239223-453 | 7201-1 | Arm Cover (side) (For 421W303BA).. | 239322 | 7201-15 | Machine Pulley (loose) Needle Bearing..... |
| 239223-454 | 7201-1 | Arm Cover (side) (For 421W311BA).. | 239336 | 7201-4 | Thread Wiper Body Wire Clamping Plate..... |
| 239228 | 7201-3 | Arm Shaft (horizontal) Bushing (front)..... | 239341 | 7201-9 | Tripping Rock Shaft Connection with 350606(869)..... |
| 239234 | 7201-20 | Cylinder Cover (side) (For 421W301BA)..... | 239342 | 7201-9 | Tripping Rock Shaft Connection Rod |
| 239245 | 7201-17 | Feed Cam Supporting Gear Cam Locating Pin..... | 239343 | 7201-9 | Tripping Rock Shaft Lever Arm.... |
| 239250 | 7201-7 | Feed Plate Carrier Bar Driving Block Oscillating Slide Stud..... | 239344 | 7201-9 | Tripping Rock Shaft Support..... |
| 239264 | 7201-11 | Lateral Rock Shaft..... | 239345 | 7201-17 | Vertical Drive Shaft..... |
| 239265 | 7201-11 | Lateral Rock Shaft Driven Arm.... | 239346 | 7201-17 | Vertical Drive Shaft Bushing (lower)..... |
| 239265 | 7201-11 | Longitudinal Rock Shaft Driven Arm | 239346 | 7201-17 | Vertical Drive Shaft Bushing (upper)..... |
| 239266 | 7201-10 | Lateral Rock Shaft Driven Arm | 239350 | 7201-29 | Pliers..... |
| | 7201-21 | Driving Link..... | 239353 | 7201-29 | Wrench..... |
| | | | 239355 | 7201-23 | Belt Guard Base..... |
| | | | 239356 | 7201-23 | Belt Guard Hinge Pin..... |
| | | | 239357 | 7201-23 | Belt Guard Lock Spring..... |

| No. | Plate | Description | No. | Plate | Description |
|------------|---------|---|-------------|---------|--|
| 239371 | 7201-29 | Wrench..... | 239536 | 7201-12 | Longitudinal Adjusting Lever |
| 239374 | 7201-3 | Machine Pulley (tight) Needle Thrust Bearing..... | | | Handle (For 421W303BA, 421W307BA and 421W311BA)..... |
| 239376 | 7201-6 | Needle Bar Thread Guide..... | 239549 | 7201-16 | Stop Motion Brake complete, Nos. 141100(850), 167161, 167229 and 239512..... |
| 239379 | 7201-15 | Machine Pulley (loose) Engaging Arm with 239320, 239321 and 350600(869)..... | 239554 | 7201-16 | Stop Motion Brake Shoe (leather).. |
| 239382 | 7201-15 | Machine Pulley (loose) Starting Cap Needle Plate..... | 239555 | 7201-16 | Stop Motion Brake Shoe Rivet (2).. |
| 239383 | 7201-3 | Machine Pulley (tight) Needle Thrust Bearing Washer (2)..... | 239556 | 7201-16 | Stop Motion Brake Shoe Support.... |
| 239384 | 7201-11 | Longitudinal Rock Shaft (driving) (For 421W301BA, 421W303BA and 421W307BA)..... | 239557 | 7201-16 | Stop Motion Brake Shoe Support complete, Nos. 239554, 239556 and two 239555..... |
| 239385 | 7201-6 | Needle Bar Connecting Link Crank.. | 239572 | 7201-7 | Clamp Pressure Spring Bracket..... |
| 239387 | 7201-4 | Thread Wiper Body..... | 239574 | 7201-11 | Lateral Rock Shaft Driving Arm Screw Stud Guide Block..... |
| 239394 | ----- | Work Plate complete (furnished upon request only)..... | 239574 | 7201-11 | Longitudinal Rock Shaft Driving Arm Screw Stud Guide Block..... |
| 239444-001 | 7201-23 | Belt Guard Base 239355 with wood screws 1-1/4 in. No. 12 R.H..... | 239623 | 7201-11 | Lateral Rock Shaft Driving Arm with 350604(869) (For 421W303BA, 421W307BA and 421W311BA)..... |
| 239448 | 7201-7 | Feed Plate Carrier Bar Driving Block Spacer Position Pin (2)..... | 239623 | 7201-11 | Longitudinal Rock Shaft Driving Arm with 350604(869) (For 421W303BA, 421W307BA and 421W311BA)..... |
| 239486-001 | 7201-15 | Machine Pulley (tight)..... | 255540 | 7201-29 | Wrench..... |
| 239487 | 7201-4 | Starting Lever Lifting Rod..... | 259470 | 7201-4 | Clamp Lifting Rock Shaft Collar with 201188(803)..... |
| 239501 | 7201-7 | Feed Plate Carrier Bar Driving Block Pin..... | 259830 | 7201-22 | Eye Guard Deflector..... |
| 239512 | 7201-16 | Stop Motion Brake Shoe Support Bracket Pressure Spring Sleeve.... | 259831 | 7201-22 | Eye Guard Bracket..... |
| 239513 | 7201-16 | Stop Motion Brake Shoe Support Bracket Stud (eccentric)..... | 259832 | 7201-22 | Eye Guard complete, Nos. 200273(819), 226467, 259830, 259831 and two 200184(819)..... |
| 239515 | 7201-4 | Clamp Lifting Rock Shaft Lifting Link Hinge Pin..... | 271597 | 7201-6 | Needle Bar Connecting Link..... |
| 239518 | 7201-14 | Starting Lever Stop Cam Interlocking Arm Stop Rod Hinge Pin..... | 350600(869) | 7201-18 | Feed Cam Mounting Screw (3)..... |
| 239519 | 7201-14 | Starting Lever Stop Cam Interlocking Arm Stop Rod Hinge Pin Retainer..... | 350600(869) | 7201-21 | Lateral Pivot Driving Arm Clamping Screw (For 421W301BA and 421W311BA)..... |
| 239522 | 7201-17 | Feed Cam Supporting Gear with 239245..... | 350600(869) | 7201-15 | Machine Pulley (loose) Engaging Arm Clamping Screw..... |
| 239524 | 7201-15 | Machine Pulley (loose) Starting Cap..... | 350600(869) | 7201-16 | Starting Lever Arm (operated) Key Clamping Screw..... |
| 239525 | 7201-15 | Machine Pulley (loose) Starting Cap Needle Button..... | 350604(869) | 7201-4 | Clamp Lifting Rock Shaft Lifting Arm Clamping Screw..... |
| 239526 | 7201-15 | Machine Pulley (loose) Starting Cap Needle Thrust Bearing..... | 350604(869) | 7201-11 | Lateral Rock Shaft Driving Arm Clamping Screw..... |
| 239533 | 7201-12 | Cylinder Cover (side) (For 421W303BA, 421W307BA and 421W311BA)..... | 350604(869) | 7201-11 | Longitudinal Rock Shaft Driving Arm Clamping Screw..... |
| 239534 | 7201-12 | Lateral Adjusting Lever (For 421W303BA, 421W307BA and 421W311BA)..... | 350606(869) | 7201-9 | Tripping Rock Shaft Connection Pinch Screw..... |
| | | | 350799(819) | 7201-4 | Clamp Lifting Bar Pressure Regulating Screw..... |

| No. | Plate | Description |
|-------------|---------|--|
| 350800(869) | 7201-10 | Lateral Feed Throw-out Collar Positioning Screw (3) (For 421W303BA and 421W307BA)..... |
| 350802(830) | 7201-10 | Lateral Feed Throw-out Screw (For 421W303BA and 421W307BA)..... |
| 350802(830) | 7201-21 | Longitudinal Feed Throw-out Screw (For 421W311BA)..... |
| 350805(803) | 7201-8 | Knife Cooking Lever Multiplier Hinge Screw..... |
| 350805(803) | 7201-8 | Knife Driving Bar Latch Hinge Screw..... |
| 350812(869) | 7201-12 | Lateral Rock Shaft Driving Arm Screw Stud Locking Screw..... |
| 350812(869) | 7201-12 | Longitudinal Rock Shaft Driving Arm Screw Stud Locking Screw..... |
| 350812(869) | 7201-3 | Needle Bar Connecting Link Crank Set Screw (2)..... |

ILLUSTRATIONS
OF
PARTS

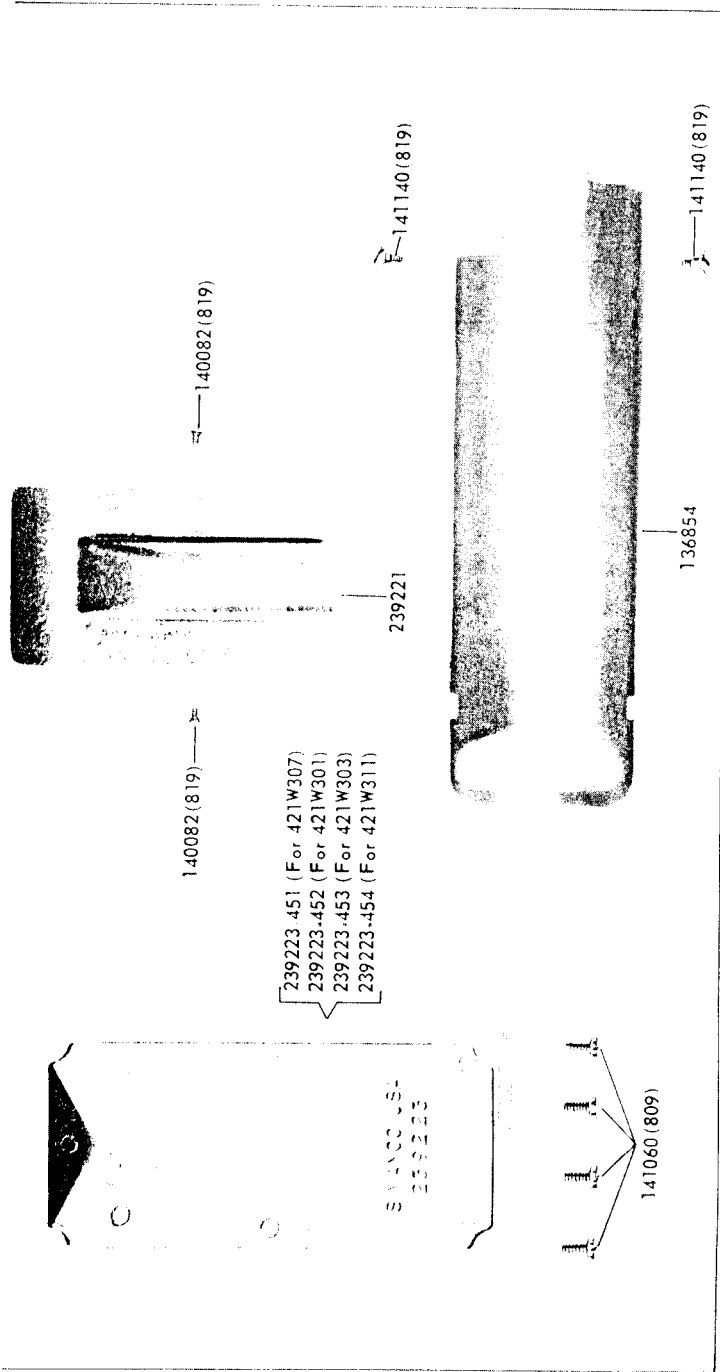

Memorandum

RECEIVED

SINGER

to: Mr. J. J. Kiernan
from: H. J. Howard
subject: Input - 421W Machines

1973
ELIZABETH IND.
PRODUCT LAB.

Walt Mendles

refer to: 390-M-45

date: 10-15-73

Referring to your conversation with Mr. Walt Mendles,
enclosed is input for a Service Newsletter (World Wide on
new 421W parts.

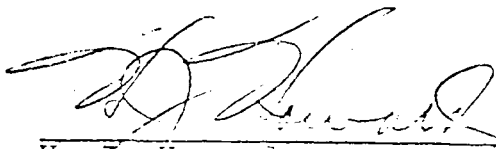

H. J. Howard
Technical Services - ISPD

HJH:jm

enc.

cc: Mr. W. Mendles ✓

P.S. Mr. Mendles indicated it's urgent that this
information be distributed as quickly as possible.

421W MACHINES - CHANGES IN KNIFE DRIVING SYSTEM PARTS

To eliminate field complaints on breakage improved parts have been adopted ofr 421W class machines as follows:

| <u>New Part</u> | <u>Description</u> | <u>Replacing</u> |
|-----------------|--|------------------|
| ✓ 136929 | Knife Driving Bar Stop (in Bracket) | 136856 |
| ✓ 136930 (3) | Knife Driving Bar Stop Screw Lock Washer | -- |
| ✓ 136931 | Knife Driving Bar Stop (Nylon) | 136892 |
| ✓ 350819 | Knife Driving Bar Stop Screw | 140049 |
| ✓ 1115 (2) | Knife Driving Bar Stop (in Bracket) Screw | (2) 51047 |
| ✓ 350820 | Knife Driving Bar Latch Tripping Screw | 769 |

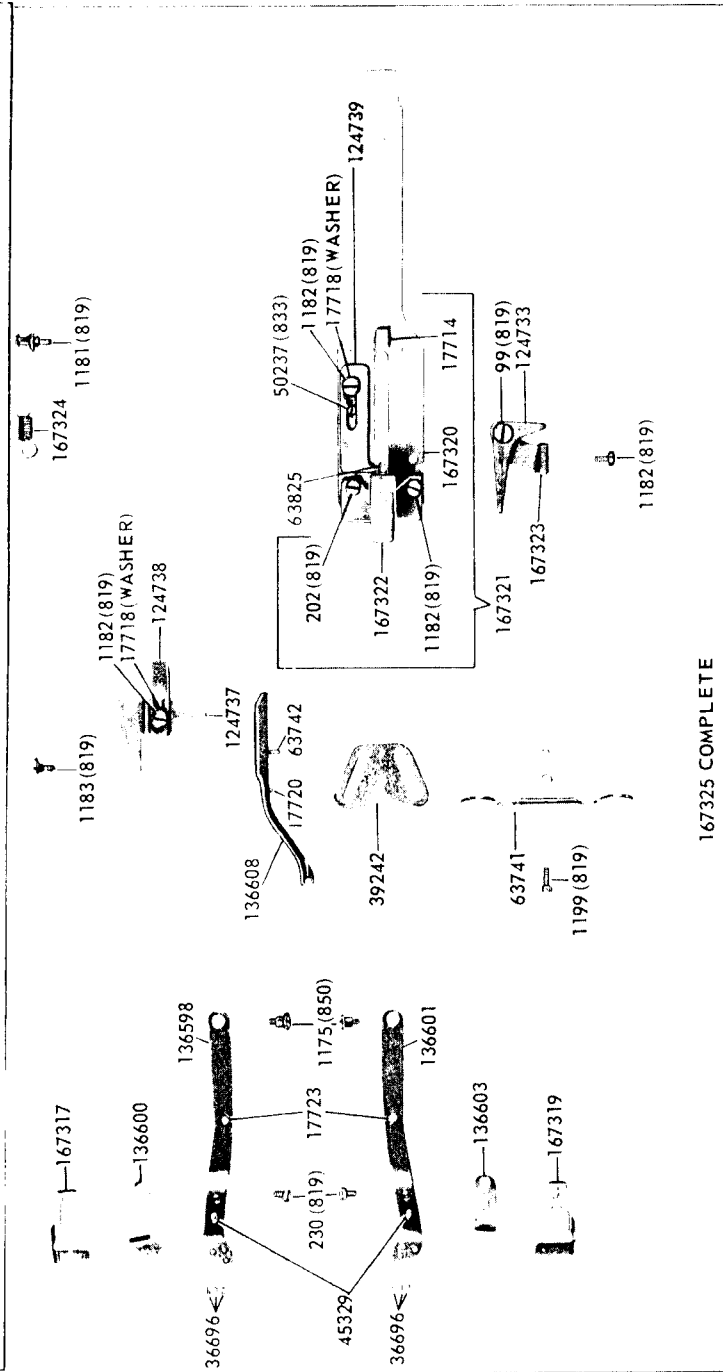
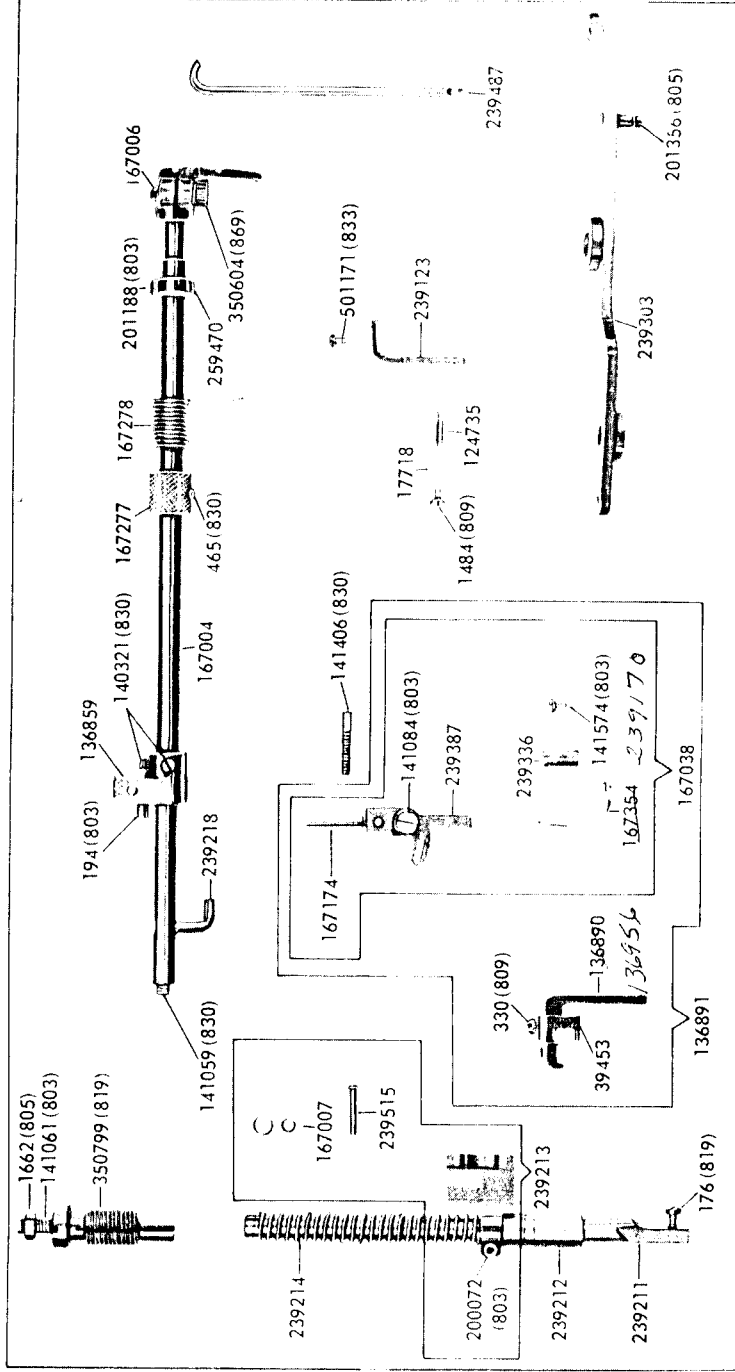

167325 COMPLETE

136926

ch
p
p
d
p
d
p
ac
re
RI

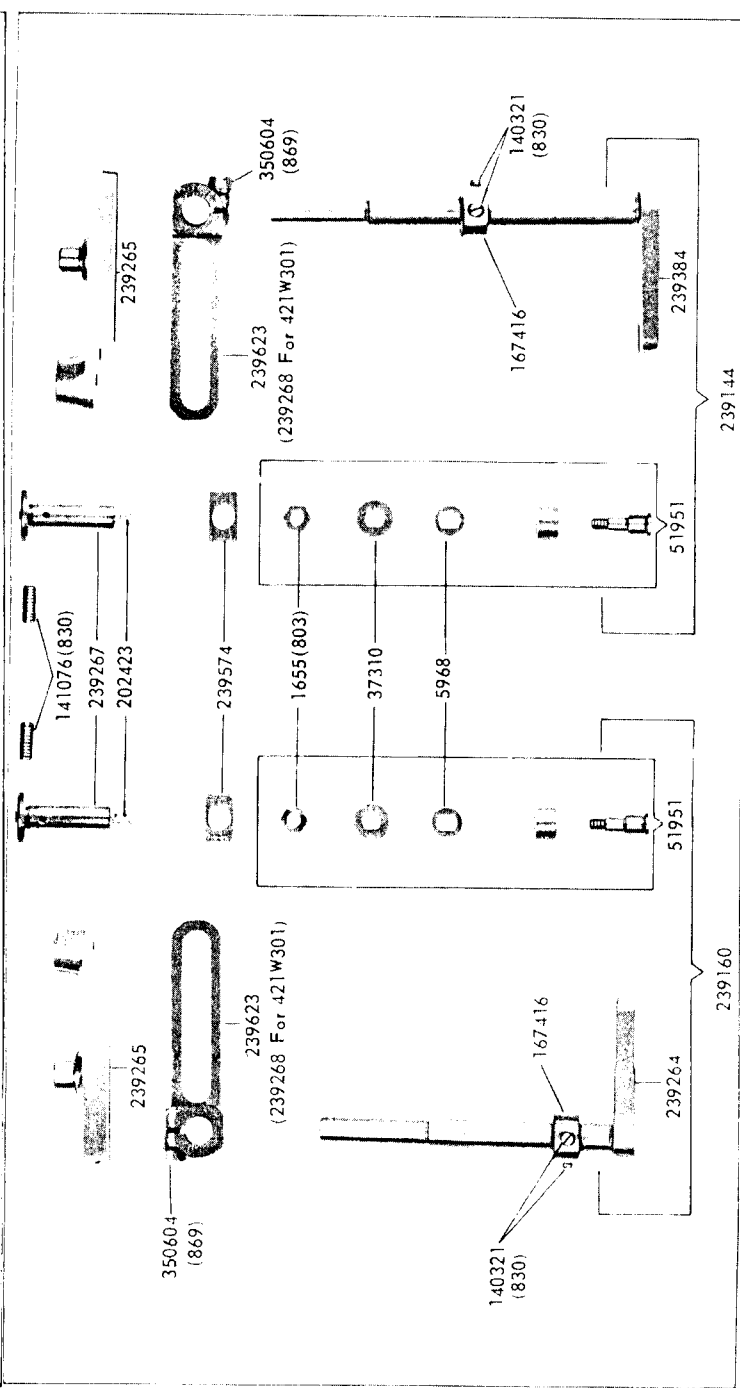
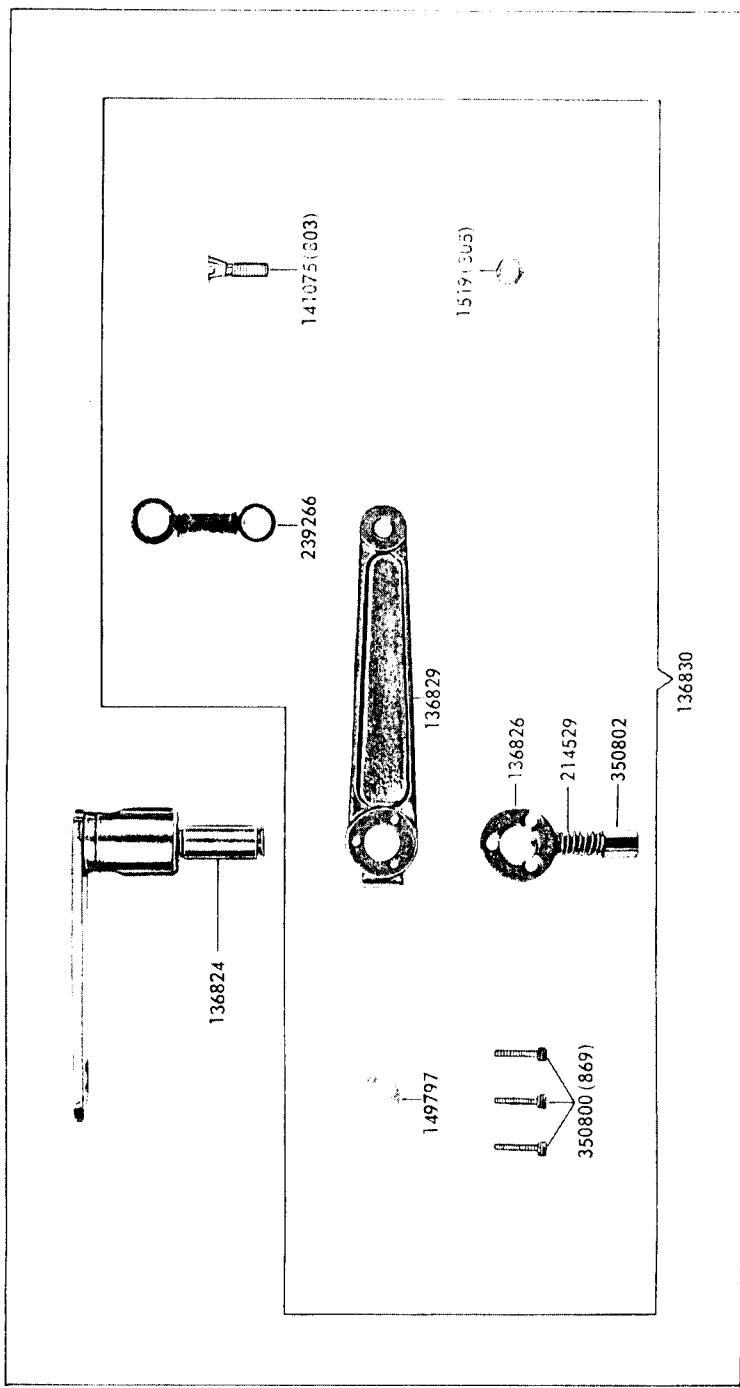

ch
d
d
p
p
lac
re
R:

7201-12

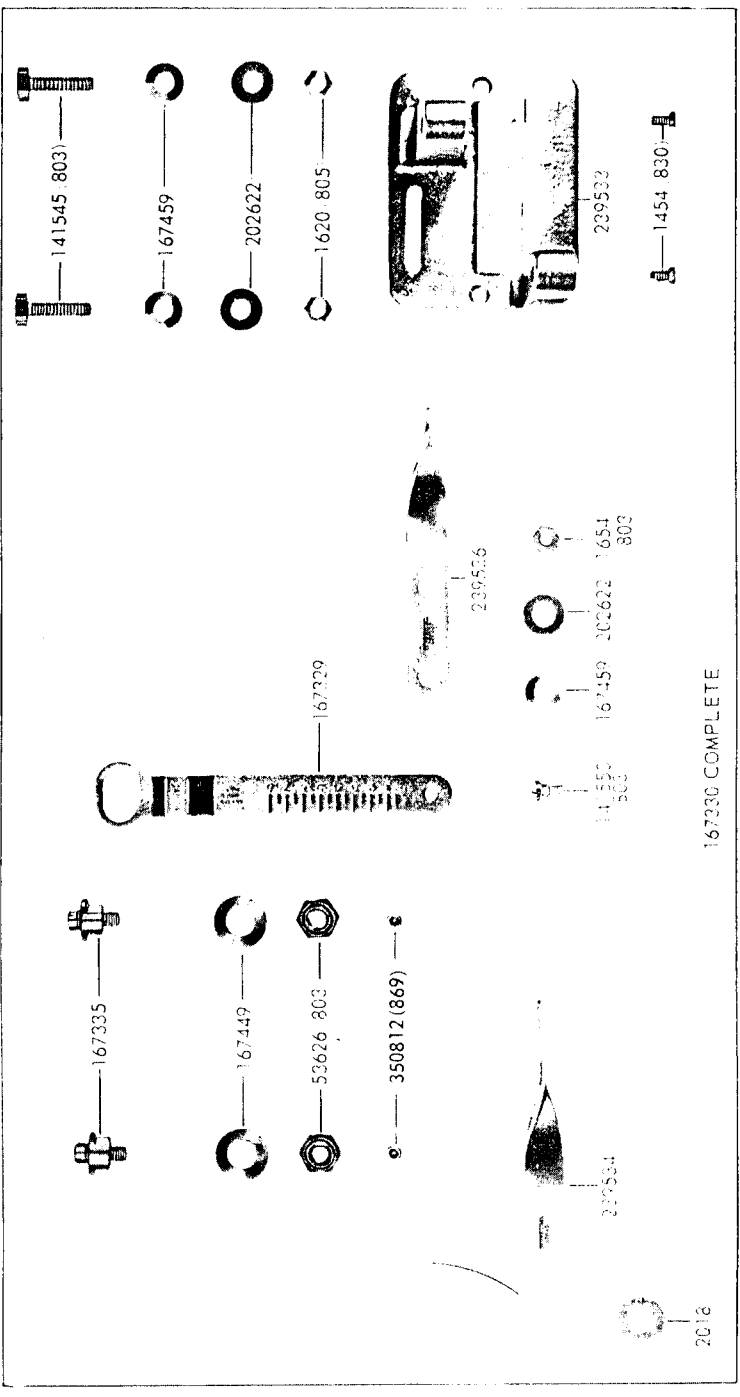

167330 COMPLETE

7201-13

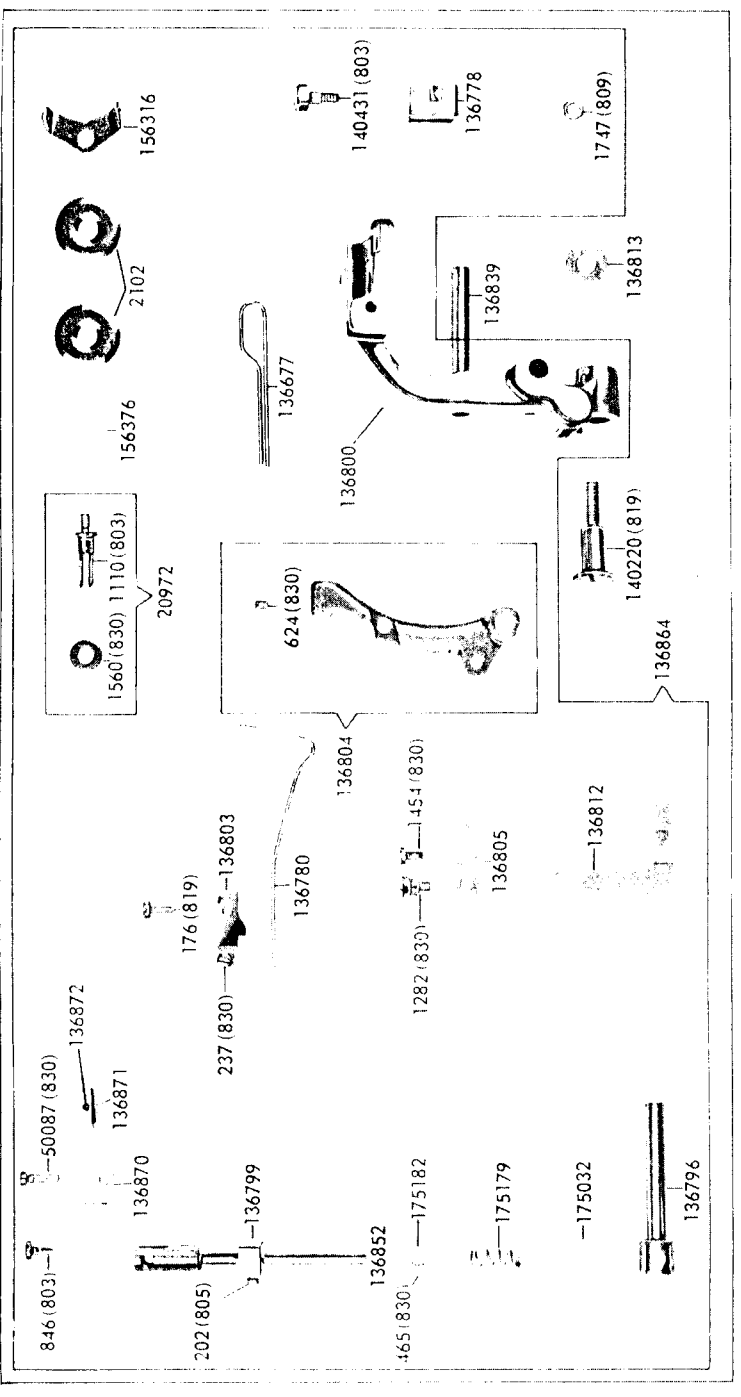

7201-14

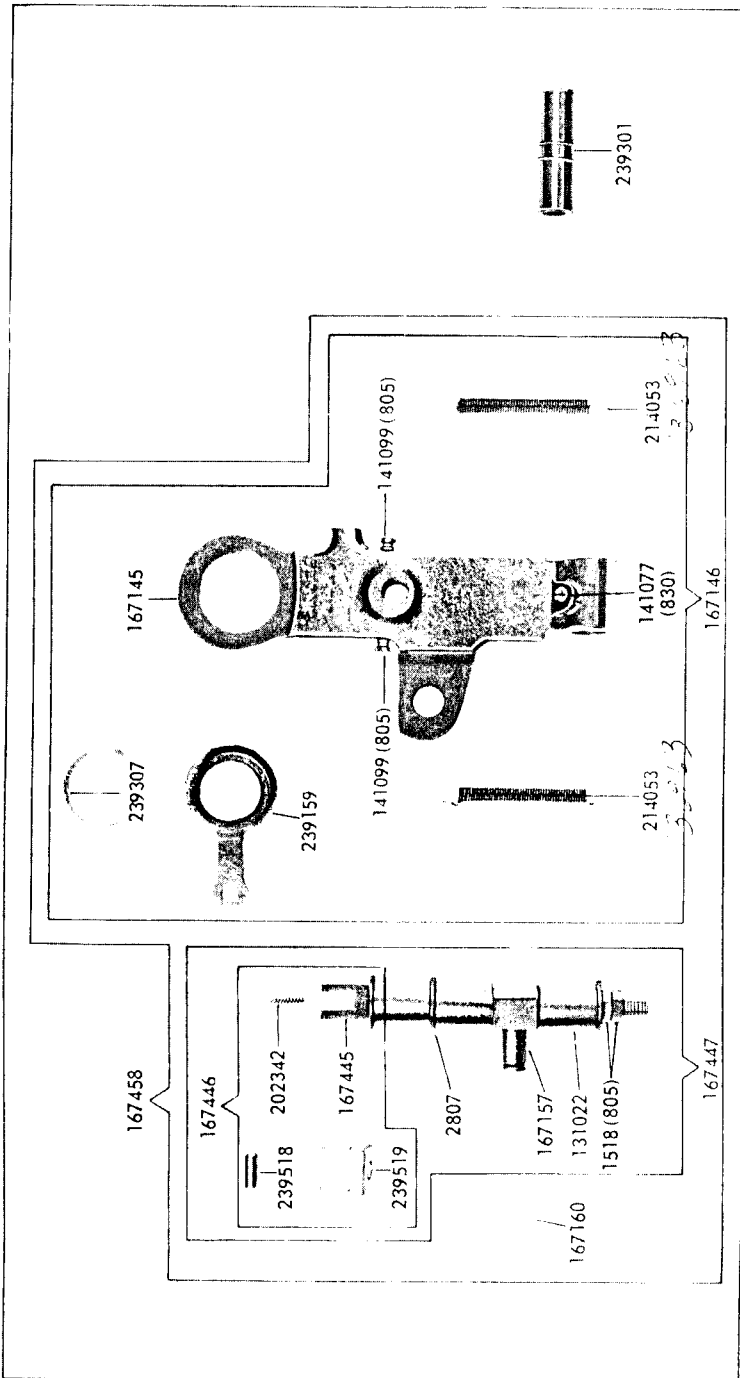

7201-15

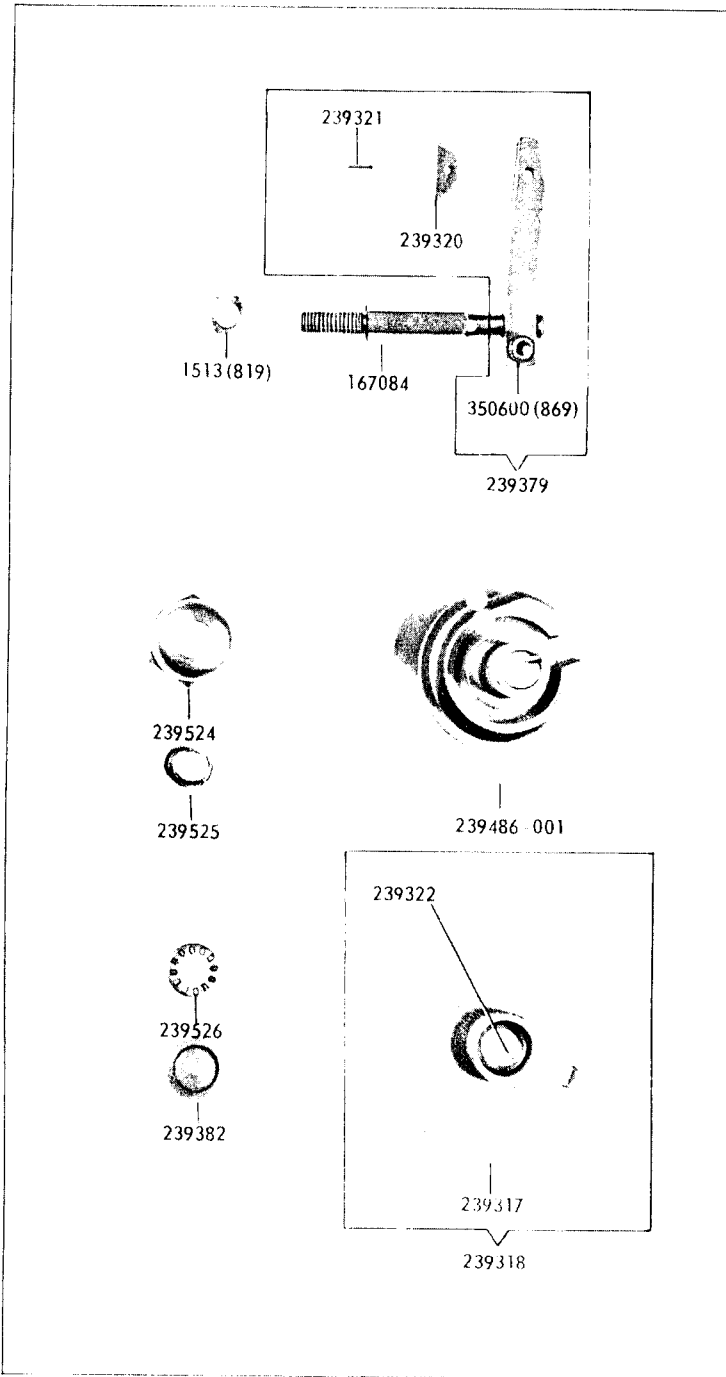

IR
re
lac

p
p
p
p
p
ch

7201-16

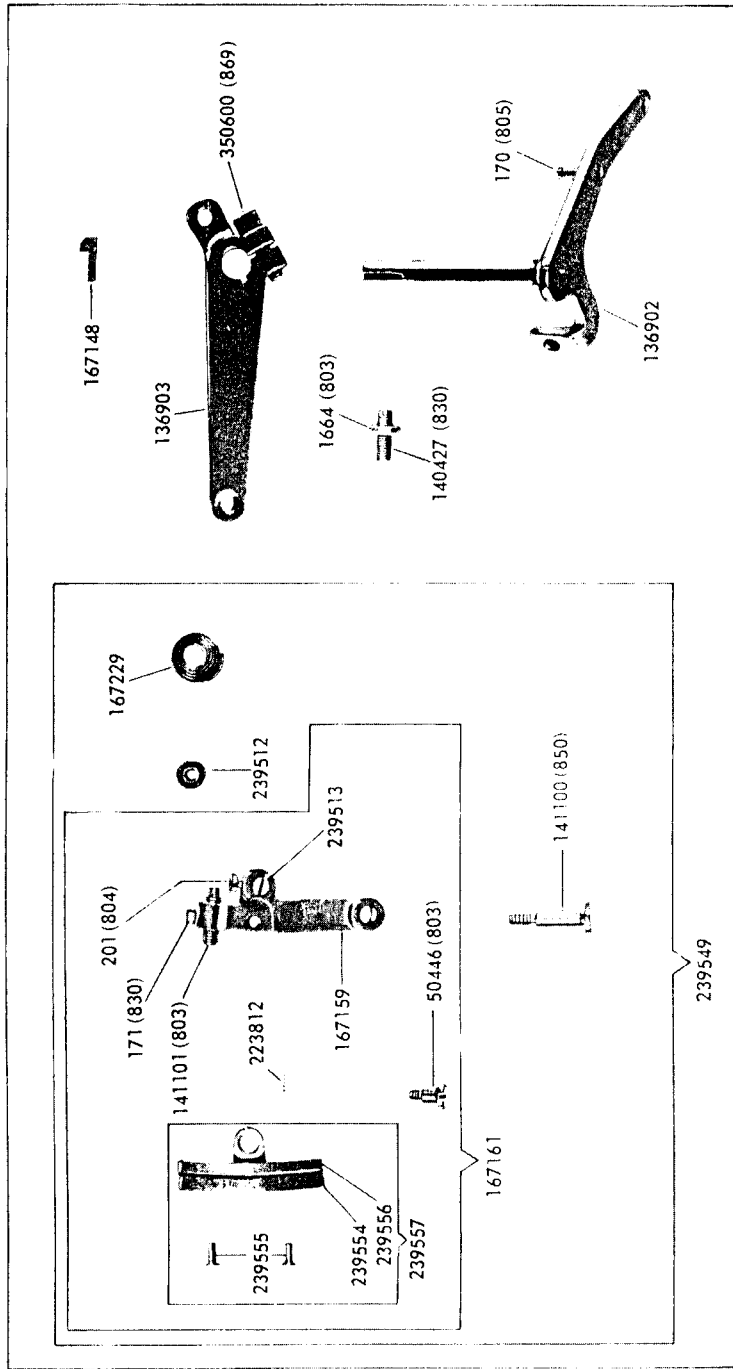

7201-17

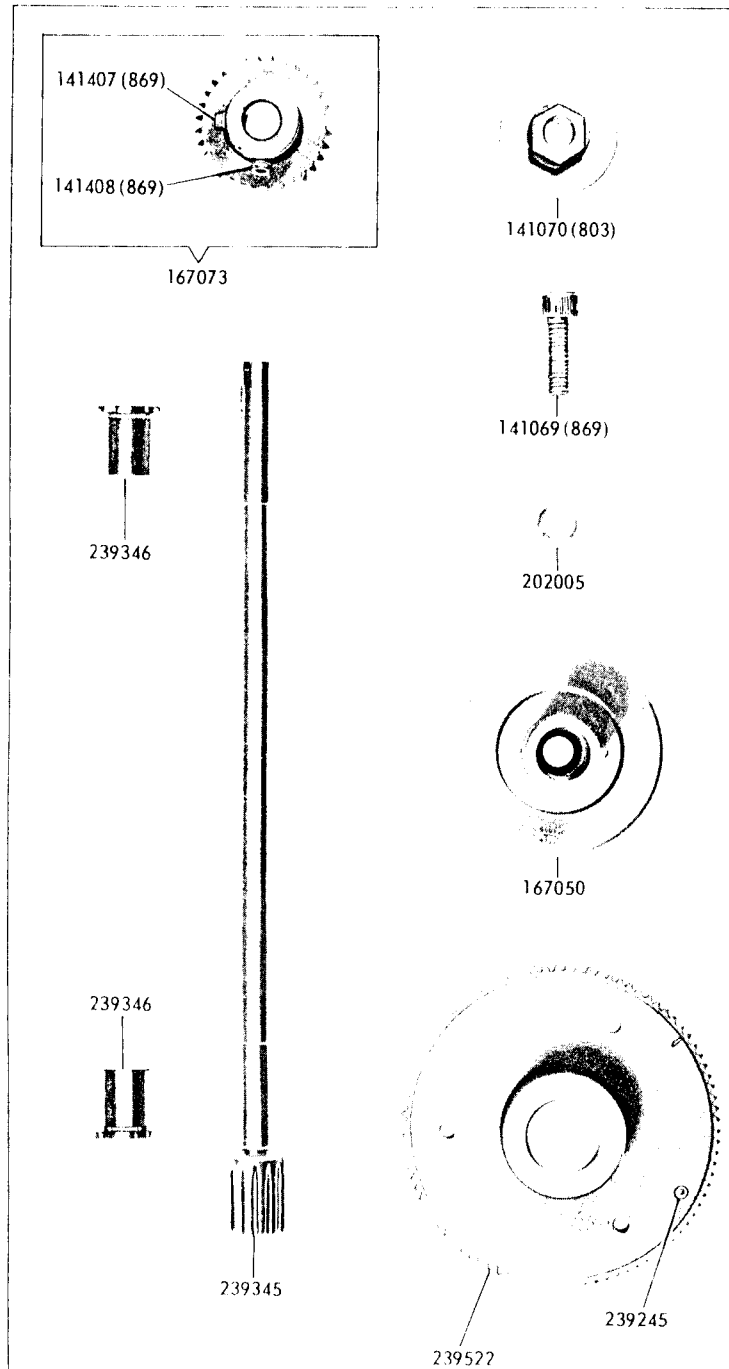

IR
or
la
p
p
p
p
ch

7201-18

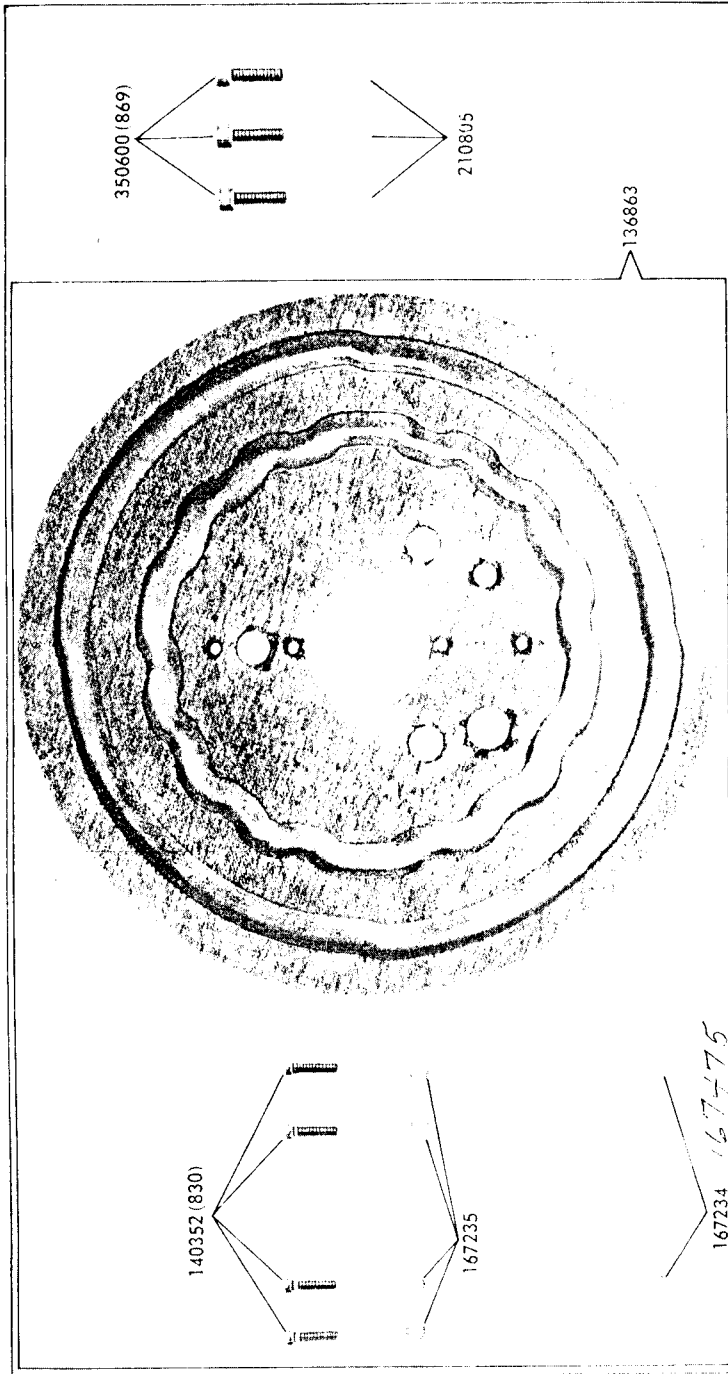

7201-19

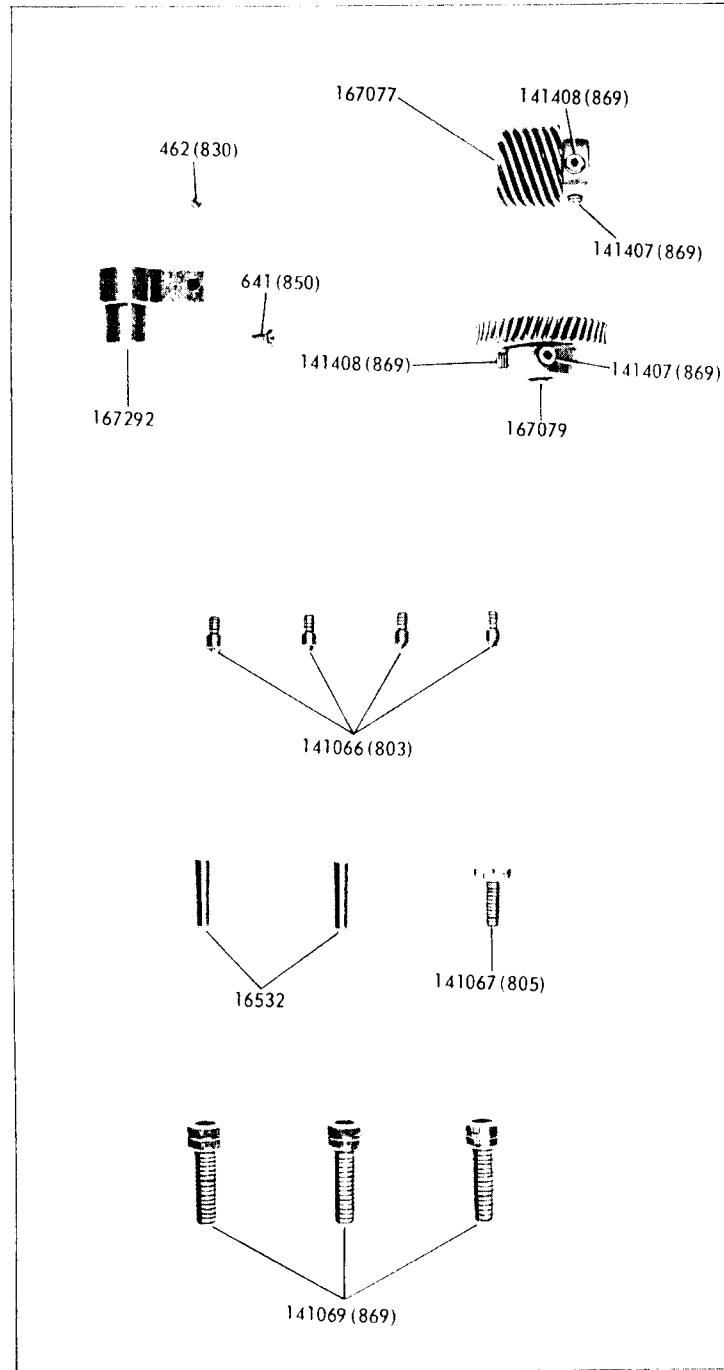

IR

r
a

p

p

p

p

p

ch

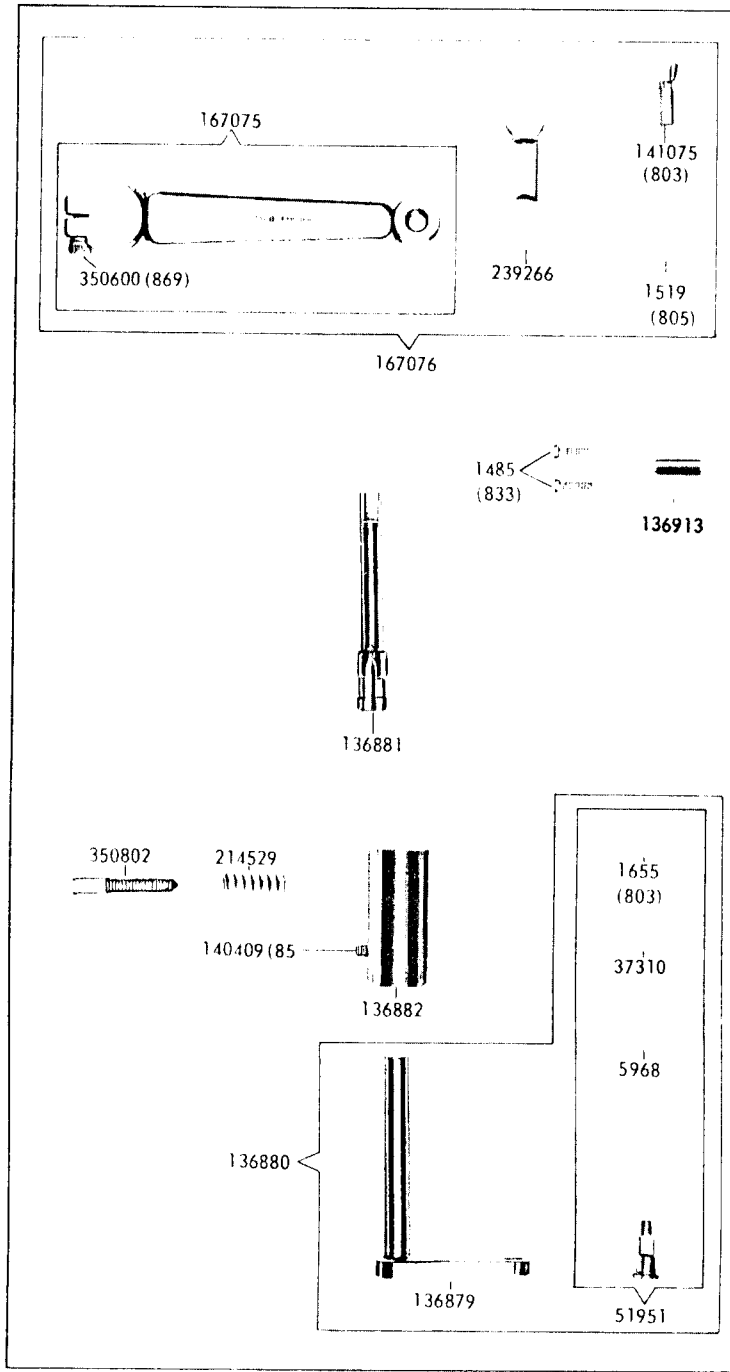
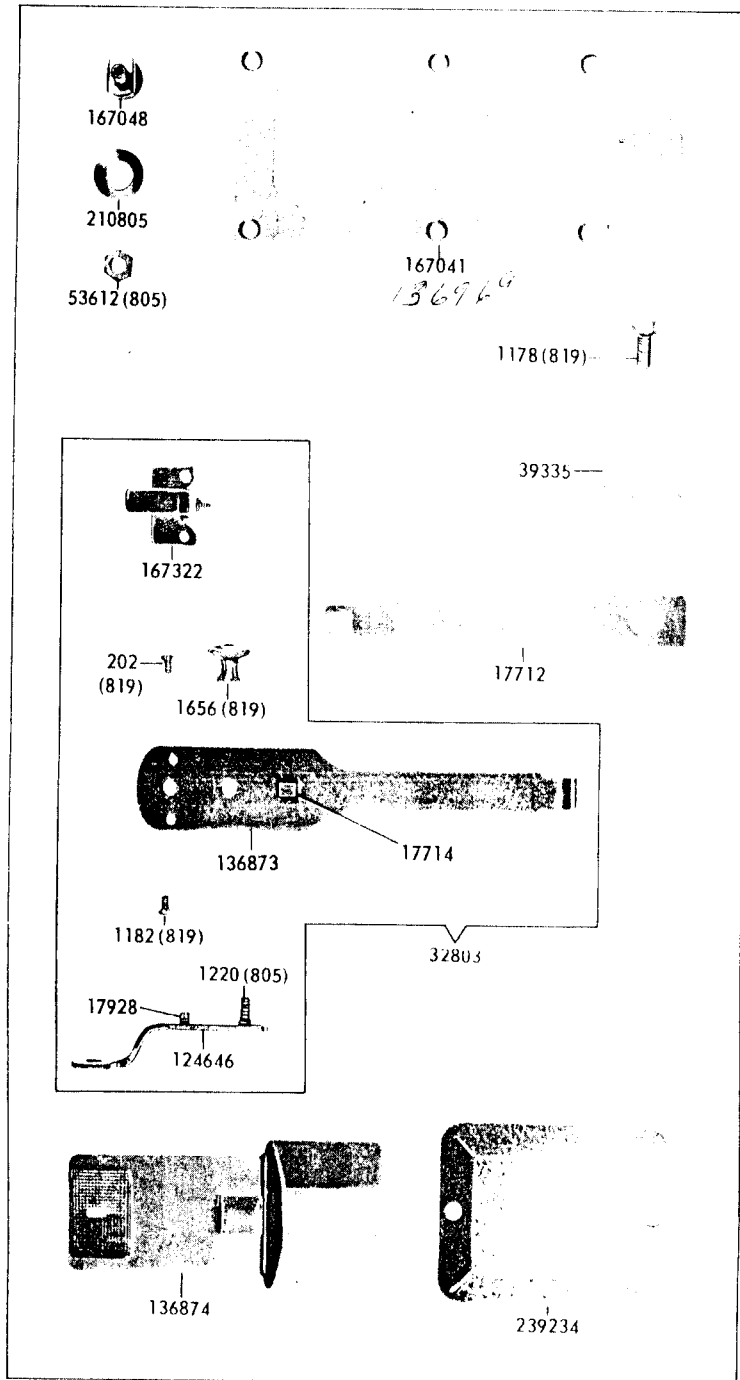

F
r
la
p
p
p
p
p
ch

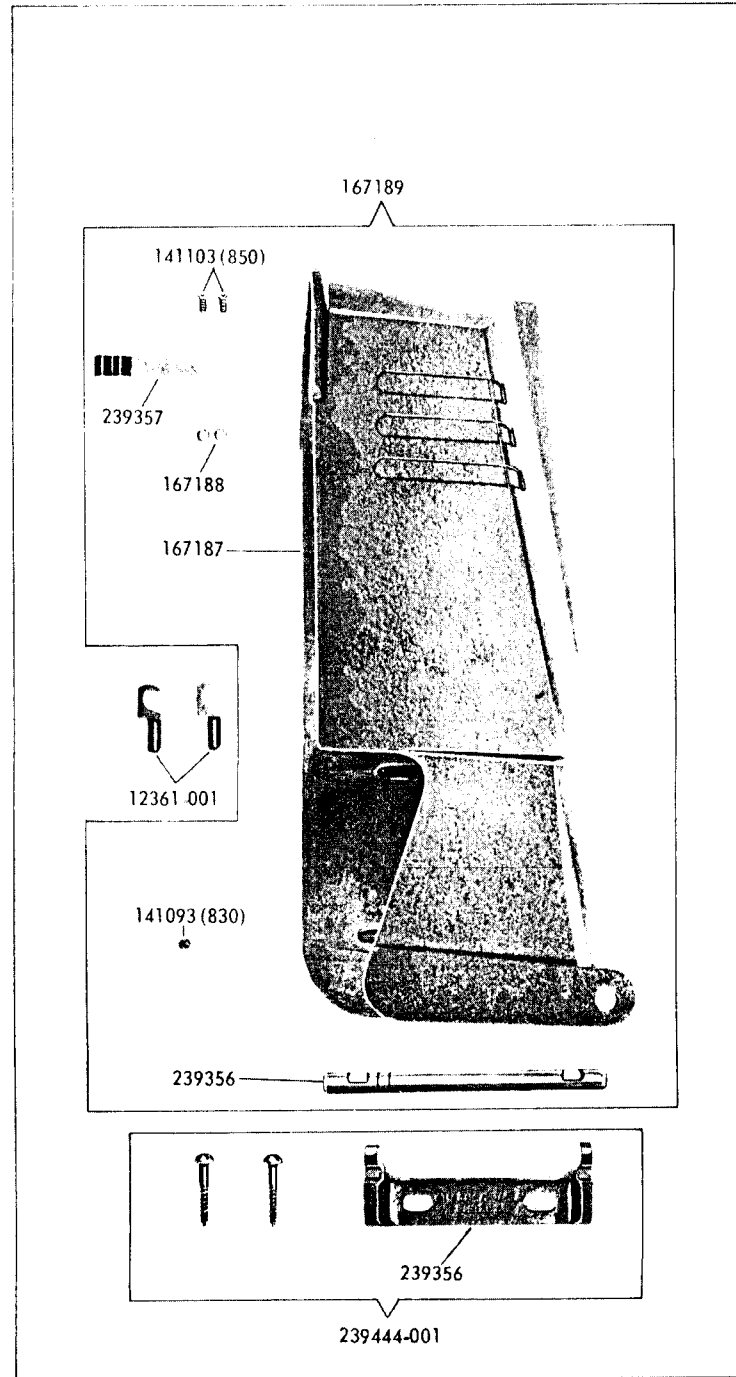
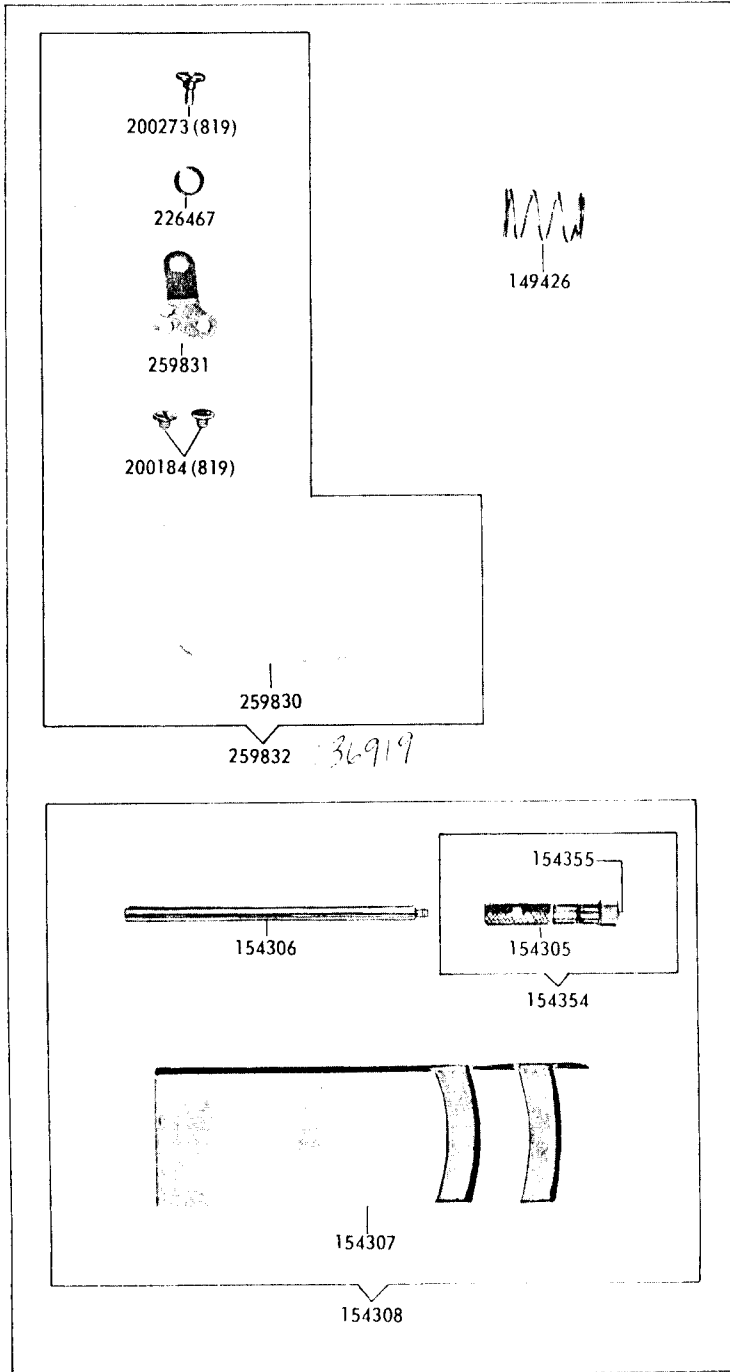

IF
r
la
p
p
p
p
p
:cl

7201-24

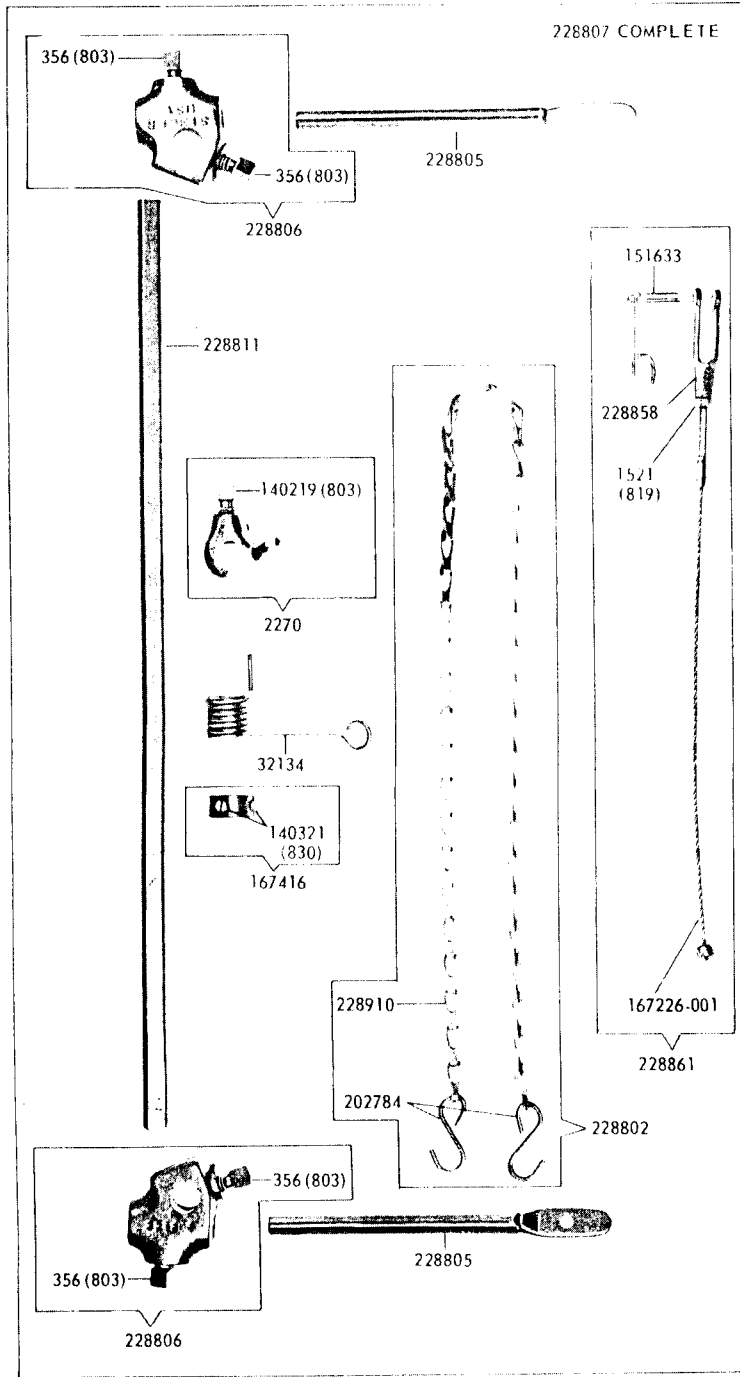

7201-25

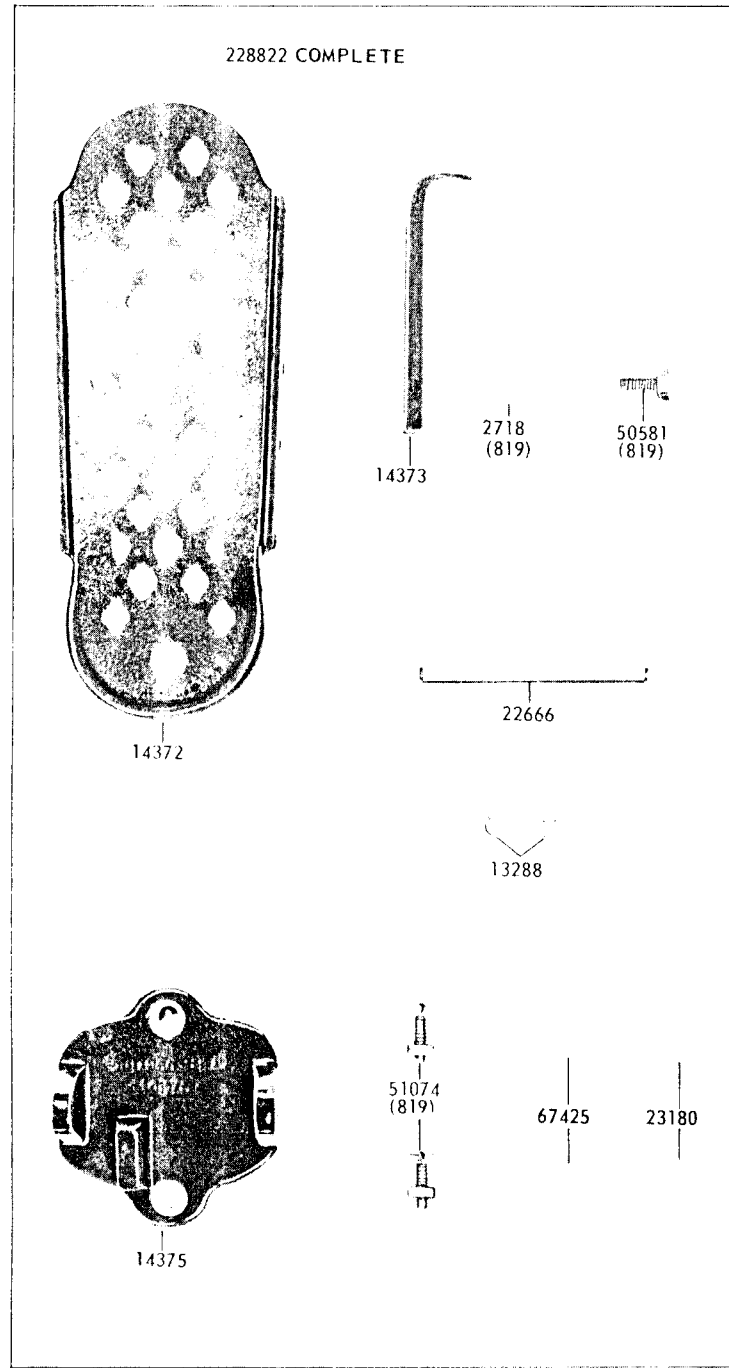

7201-26

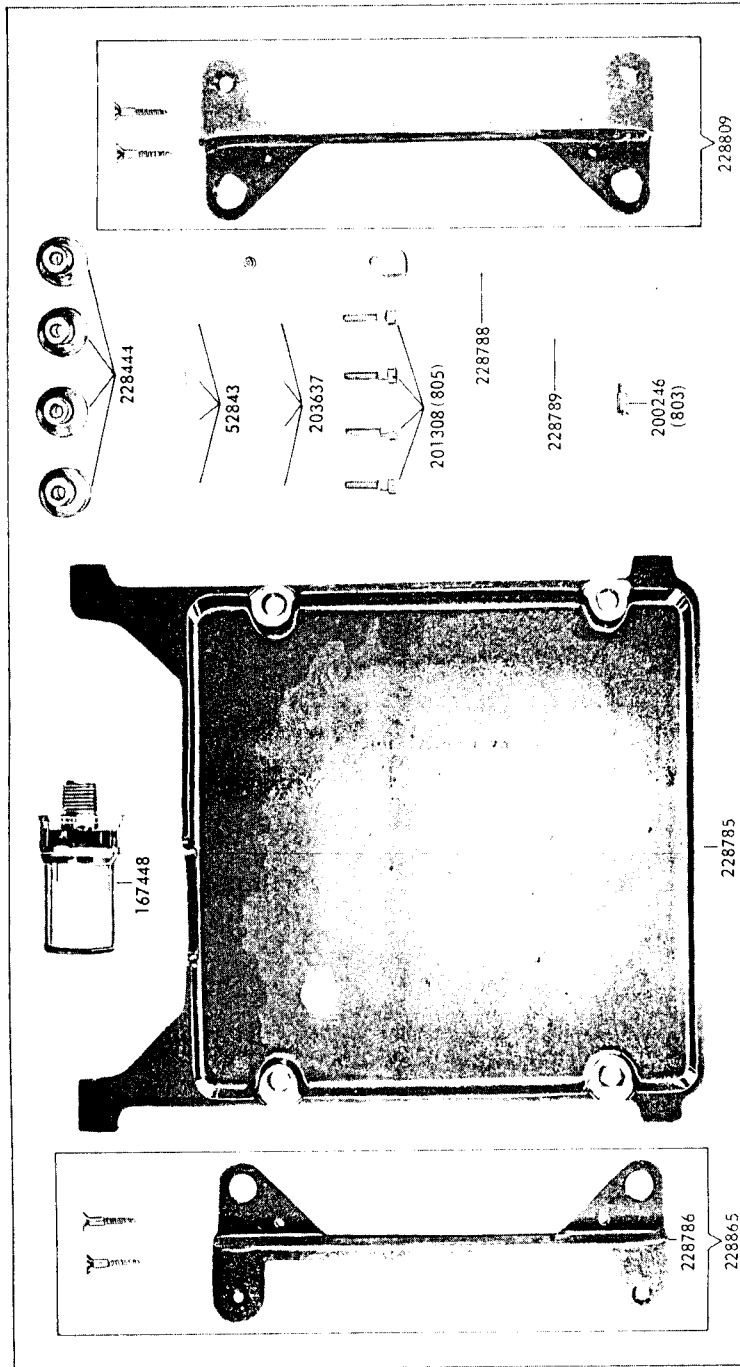

7201-27

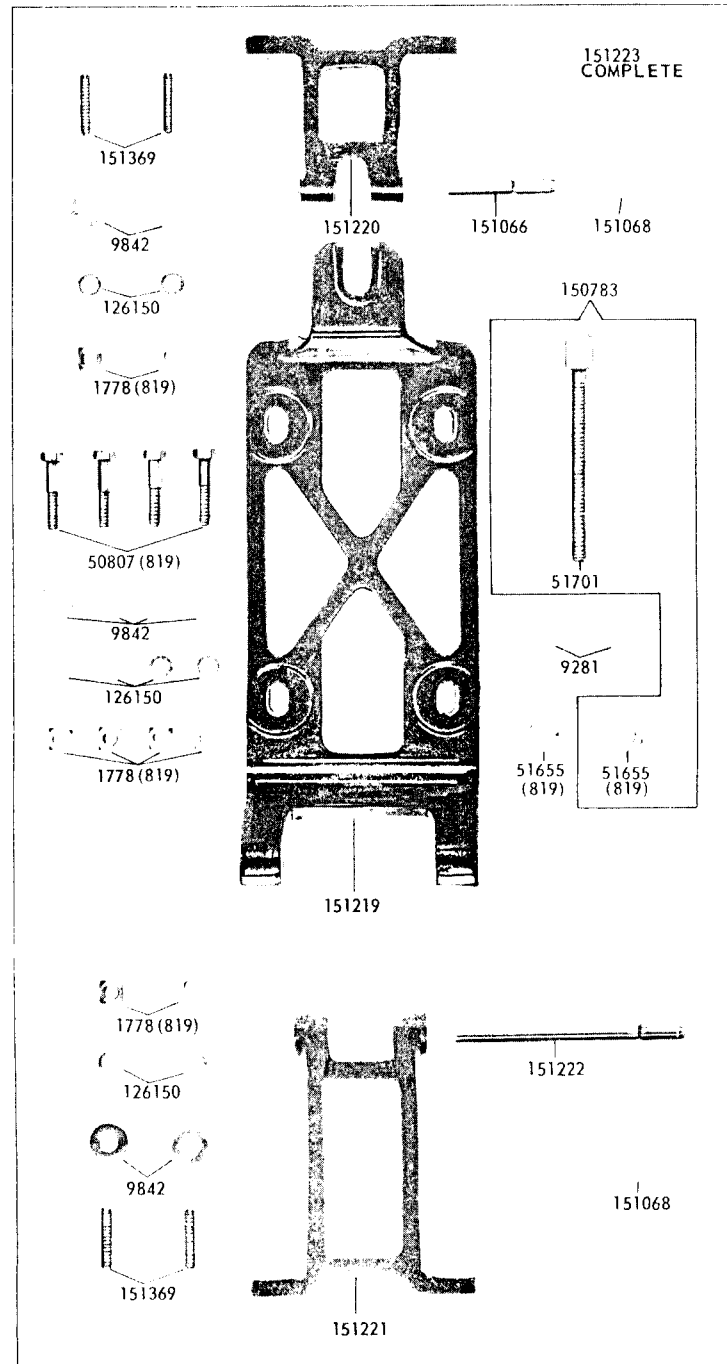

7201-28

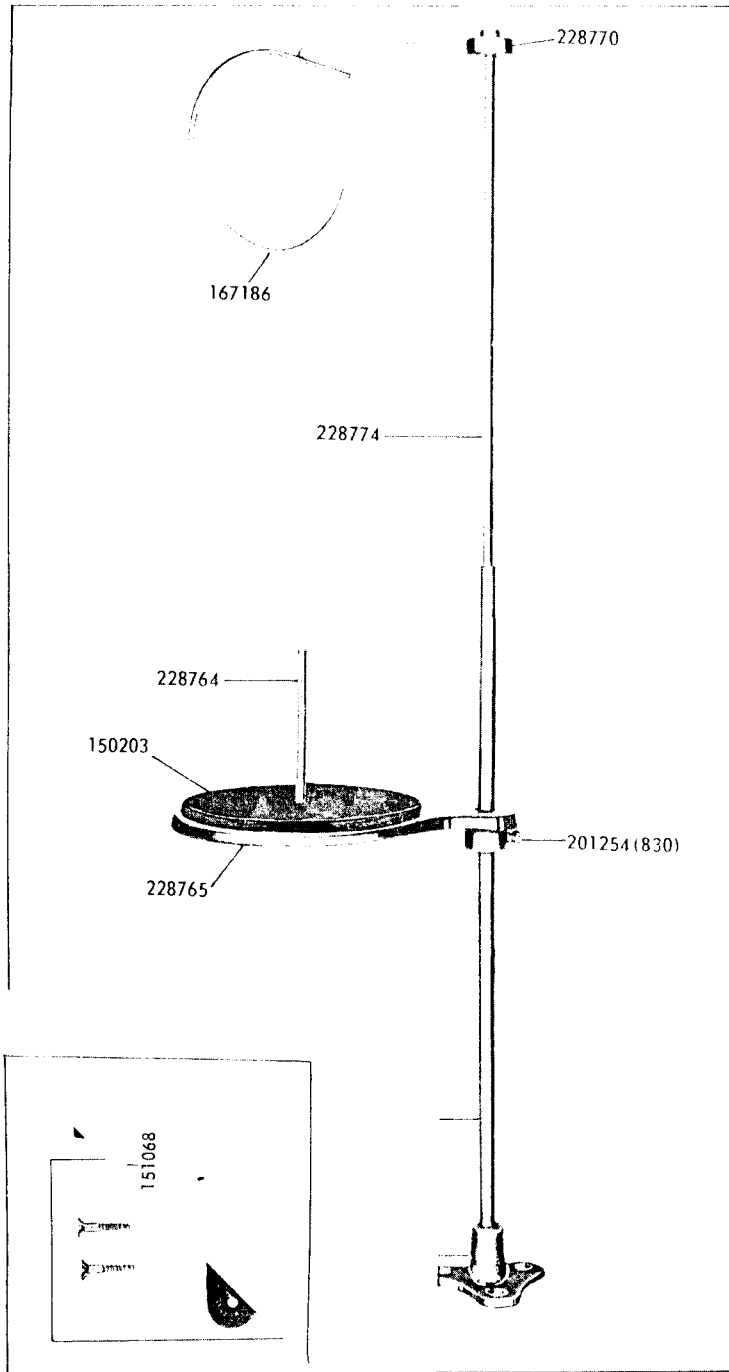

7201-29

