

**FIRST  
EDITION**



*Union Special*  
INDUSTRIAL SEWING EQUIPMENT

**CATALOG NO. T106 P**

---

---

**STYLE**

**51200**

---

---

**LIST OF PARTS**

**FOR**

**STYLE 51200 BE**

Catalog No. T106 P

LIST OF PARTS

CLASS 51200

Style

51200 BE

First Edition

Copyright 1963  
by  
Union Special Corporation  
Rights Reserved in All Countries.

**UNION SPECIAL CORPORATION**

INDUSTRIAL SEWING MACHINES

**CHICAGO**

Printed in U.S.A.

October, 1978

## IDENTIFICATION OF MACHINES

Each UNION SPECIAL machine is identified by a Style number which is stamped into the name plate on the machine. Style numbers are classified as standard and special. Standard Style numbers have one or more letters suffixed, but never contain the letter "Z". Example: "51200 BE". Special Style numbers contain the letter "Z". When only minor changes are made in a standard machine, a "Z" is suffixed to the Standard Style number. Example: "51200 BEZ".

Styles of machines similar in construction are grouped under a class number which differs from the Style number, in that it contains no letters. Example: "51200".

## APPLICATION OF CATALOG

This catalog applies specifically to the Standard Style of machine as listed herein. It can also be applied with discretion to some Special Styles of machines in this class. Reference to direction, such as right, left, front, back, etc., are given from the operator's position while seated at the machine. Operating direction of handwheel is toward the operator.

## STYLE OF MACHINE

Streamlined Flat Bed, Low Throw, Trimming Knife Abreast of Needle, Rear Chip Disposal, One Needle, Needle Bearing Needle Bar Drive, Light Weight Presser Bar and Needle Bar Driving Mechanism, Single Disc Take-up, Single Reservoir Enclosed Automatic Lubricating System, Filter Type Oil Return Pump with Oil Pan Base Plate, Oil Siphon Assembly, Lateral Looper Travel.

51200 BE For miscellaneous operations (while simultaneously trimming) on ladies' blouses, children's and ladies' dresses and similar operations where chaining is required on light to medium weight materials. Knee press and tape reel furnished with machine. Presser foot with 9/16 inch tape tube on toe for taping operation is optional and will be furnished in place of other presser foot, if specified. Seam specification 401-SSa-1. Stitch range 9 to 14 per inch.

## NEEDLES

Each UNION SPECIAL needle has both a type number and size number. The type number denotes the kind of shank, point, length, groove, finish and other details. The size number, stamped on the needle shank, denotes the largest diameter of blade measured in thousandths of an inch, midway between the shank and the eye. Collectively, the type number and size number is the complete symbol, which is given on the label of all needles packaged and sold by Union Special.

Standard needle for Style 51200 BE is Type 108 GHS. It has a round shank, round point, extra short, double groove, struck groove, ball eye, spotted, ball point, chromium plated - sizes 070/027, 075/029, 080/032, 090/036, 100/040, 110/044, 125/049.

To have needle orders promptly and accurately filled, an empty package, a sample needle, or the type and size number should be forwarded. Use description on label. A complete order would read as follows: "1000 Needles, Type 108 GHS, Size 080/032.

Selection of the proper needle size should be determined by the size of thread used. Thread should pass freely through the needle eye in order to produce a good stitch formation.

## IDENTIFYING PARTS

Where construction permits, each part is stamped with its part number. On some of the smaller parts, and on those where the construction does not permit, an identification letter is stamped in to distinguish the part from similar ones.

Part numbers represent the same part, regardless of catalog in which they appear.

**IMPORTANT! ON ALL ORDERS, PLEASE INCLUDE PART NAME AND STYLE OF MACHINE FOR WHICH PART IS ORDERED.**

## USE GENUINE NEEDLES AND REPAIR PARTS

Success in the operation of these machines can be secured only with genuine UNION SPECIAL Needles and Repair Parts as furnished by the Union Special Corporation, its subsidiaries and authorized distributors. They are designed according to the most approved scientific principles, and are made with utmost precision. Maximum efficiency and durability are assured.

Genuine needles are packaged with labels marked *Union Special*®. Genuine repair parts are stamped with the Union Special trademark, U S Emblem. Each trademark is your guarantee of the highest quality in materials and workmanship.

## TERMS

Prices are net cash and subject to change without notice. All shipments are forwarded f. o. b. shipping point. Parcel Post shipments are insured unless otherwise directed. A charge is made to cover postage and insurance.

## OILING

The oil has been drained from the machine before shipping, and the reservoir must be filled before beginning to operate. Use a straight mineral oil with a Saybolt viscosity of 90 to 125 seconds at 100° Fahrenheit.

Oil is filled at the spring cap in the top cover and the level is checked at the sight gauge on the front of the machine. The oil level should be maintained between the red lines on the gauge. The capacity of the oil reservoir is 12 ounces.

The machine is automatically lubricated and no oiling, other than keeping the main reservoir filled, is necessary.

A daily check before the morning start should be made and oil added if required. Oil which has gone through the machine is filtered and pumped back into the main reservoir, making too frequent oilings unnecessary. Excessive oil in the main reservoir may be drained at the plug screw in the main frame directly under the handwheel.

The following is a numerical list of the parts in this machine. Quantities, part numbers, and descriptions are given. Following the parts list are photographs of some of the major parts.

Amt.	Part No.	Description	Amt.	Part No.	Description	Amt.	Part No.	Description
1	8	Feed Rocker Shaft	2	531	Screw for 51493 BQ	1	21171 AC	Tape Reel Pin for 21171 AB (258 A)
3	18	Nut for 51240 E, 55241 N, 55244 G	1	643-127	Gasket for 51493 AG	1	21177 A	Tape Reel Spring
3	20	Washer for 51282AH	1	660-136	Feed Crank Link	1	21210 A	Collar for 21171 AB (22647 K-24)
2	20	Washer for 51236 G, 51758	1	660-168	Oil Tube (258 A)	1	21212	Looper Collar
2	25 S	Screw for 51282AJ	1	660-202	Knee Press Plate	1	B21375 AH	Oil Siphon Connection
1	27-435	Needle Bar	1	660-207	Cushion for 21664	1	21657-3	Locking Ring
	Blk.	Eyelet Washer	1	660-212	"O" Ring for pulley	1	21657 E	Belt Guard (93)
2	28	Screw for 51704	2	660-215	Oil Seal Ring for foot lifter lever	1	21657 W	Tension Release Separator (22598 C, 80557)
2	50-216	Pin for 51757 B	2	660-219 G	bushing	1	21657 X	Washer for 51757 B
1	50-458	Pin for 51241 K	1	666-65	Oil Seal Ring for 51150, 51250 E (22586 R)	1	21657 Y	Tension Release Lever Shaft
1	50-648	Lucite Oil Gauge	2	666-111	Retaining Ring for 52336	1	21660 H	Tension Release Lever Shaft Bushing
1	50-789	Oil Cap Hinge	2	666-114	Hinge Pin for 21662 R	1	21662 R	Tension Release Lever Connection (402, 22596)
	Blk.	Pin for 52882 AD	2	666-118	Oil Wick for 51144	1	21662 S	Knee Press Assembly
3	52 A	Looper Thread Eyelet (98 A)	2	666-149	Oil Wick for 8	1	21662 T	Knee Press Lifter Arm for 21660 H (660-219 G, 22650 CE-6, 39536 AD)
1	69 FD	Screw for 21664	2	666-170	Oil Wick for right main shaft bearing	1	21662 U	Knee Press Link Connection for 21660 H (531)
1	73	Screw for looper	1	666-179	Oil Wick for left main shaft bearing	1	21662 V	Knee Press Link for 21660 H
1	77	Screw for needle lever link pin, upper	1	666-201	Felt Wick for 51054	1	21662 W	Knee Press Lever for 21660 H (22557 A, 39536 AD)
1	77	Screw for 51054	1	666-208	Oil Wick for needle lever	1	21662 X	Torsion Spring for 21660 H
1	77	Screw for 51236 A	1	666-209	Wedge Pin for 666-111	1	21662 Y	Knee Press Plate Lever for 21660 H (69 FD)
2	77 F	Screw for 51281 AR	1	666-214	Felt Plug for 51294 U	1	21662 Z	Mounting Bracket for 21660 H (80, 92201)
2	80	Screw for cloth plate	1	666-219	Oil Wick for 51150, 56350 A	1	21695 Y	Finger Guard (22517 B)
2	80	Screw for 21664 F	2	667 B-10	Felt Siphon Cup Disc for 51294 U	3	22513	Screw for 35731 A
2	80	Screw for 51280 N	2	668-25	Felt Lint Filter for 51294 M	2	22517	Screw for 51273 C
1	81	Screw for 51242 Y (12982)	2	668-28	Dowel Pin for 51273 C	2	22517 B	Screw for 21695 Y
1	82	Screw for 51236 G	2	719	Eyelet for 51292 D	2	22519 C	Screw for 51235 A (51235 G)
2	87	Screw for throat plate	1	753	Eyelet Locking Ring for 51292 D	1	22519 H	Screw for 51244 B
2	88	Set Screw for 15465 F	1	753	Screw for 51150, 56350 A	1	22524	Feed Dog Height Adjusting Screw
1	88	Screw for 52894 AK	1	906	Support Axle Cone for 21171 AB (188 D)	6	22524	Screw for 51282 AF
2	90	Screw for 52882 Y	1	1349 A-5	Support Axle Cone for 21171 AB (22576)	1	22528	Screw for feed dog
2	90	Screw for 52882 AD	1	1741 A	Screw for 39271 A	1	22528	Screw for 51757 B
2	90	Screw for 52894 AB	1	1741 B	Screw for 51250 T (51242 M)	1	22537	Screw for 53783 N
1	91	Clamp Screw for presser foot	1	6042 A	Spring for 21177 A	1	22539 H	Plug Screw
2	93	Screw for B21375 AH	1	7947	Pin for 1741 B	3	22541 B	Screw for 52882 AD
1	95	Plug Screw for bed	1	12538	Chain Cutting Knife for 51220 K (187 A, 1741 A)	1	22542	Screw for 51282 Y
1	95	Screw for 51270 B	1	12982	Washer for 52894 AM	4	22548	Screw for 52882 AE
2	95	Screw for 51147	1	12982	Nut for 51294 R	2	22550	Screw for 51278 H
1	96	Screw for 51244	1	15465 F	Nut for 51241 K	1	22557 A	Screw for 21662 U (43137 E)
1	96	Spot Screw for 51723 A	1	20149 C	Lock Nut for 81	1	22557 B	Screw for 53783 L
2	98	Screw for 482	1	21114	Nut for 92201	2	22559 A	Bearing Cap Screw, lower, for 29105 AA
2	98	Screw for 51235	2	21171 S	Looper Rocker Cone for 29192 (88)	2	22559 B	Bearing Cap Screw, upper, for 29105 AA
1	98	Screw for 51244	1	21171 T	Pin for 51250 T	2	22559 G	Screw for 29066 R
3	98 A	Screw for 52 A	1	21171 U	Tape Reel Disc for 21171 AB	1	22560 B	Set Screw for 51134
1	98 A	Screw for 51291 A	1	21171 V	Tape Reel Support for 21171 AB (22581, 52782 C)	2	22560 B	Screw for 51493 BP
4	109	Tension Disc	1	21171 W	Tape Guide for 21171 AB (22585 C)	1	22562 A	Screw for 51254 J
2	166	Screw for 52972	1	21171 X	Tape Guide Support for 21171 AB (22585 A)	1	22564	Screw for ndl, lever link pin, lower
1	187 A	Screw for 1741 B	1	21171 Y	Tape Guide Support for 21171 AB (22585 A)	3	22569 B	Screw for bearing housing
1	188 D	Thumb Screw for 753	2	21171 Z	Tape Guide Wire for 21171 AB (22585 A)	5	22569 B	Screw for 51282 Y
1	258	Nut for 51280 E	1	21171 AA	Tape Reel Assembly	3	22569 B	Screw for 51493 AH
1	258 A	Nut for 660-136	1	21171 AB		15	22571 A	Plug Screw
2	258 A	Nut for 21171 AC	1	21171 AC		2	22571 B	Plug Screw
1	258 A	Nut for 56334 E	1	21171 AD		1	22576	Screw for 753
1	258 A	Lock Nut for 51745	1	21171 AE		1	22580 D	Set Screw for 51723 A
1	258 A	Nut for 52894 AM	1	21171 AF		2	22581	Screw for 21171 S
2	269	Nut for 51236 G, 51240 E	1	21171 AG		1	22585 A	Screw for 21171 V
1	402	Screw for 53783 A	1	21171 AH				
2	482	Collar for 8 (98)	1	21171 AI				
1	531	Screw for 21662 S, 51257 M	1	21171 AJ				



Amt.	Part No.	Description	Amt.	Part No.	Description	Amt.	Part No.	Description
1	51257 AA	Presser Bar	1	51493 D	Oil Pump Driving Shaft	1	52892	Tension Post Support
1	51270 B	Needle Thread	2	51493 E	Driving Shaft Gear	2	52894 AB	Oil Tube Holder (90)
1	51272 D	Take-up Wire (95)	1	51493 AG	Oil Pump Housing (22569 B)	1	52894 AK	Oil Tube for looper rocker and left ball joint (88)
1	51273 C	Block Guide Collar	1	51493 AH	Oil Pump Housing Cover (22569 B)	1	52894 AM	Oil Tube for right ball joint (258 A, 6042A)
1	51278 H	Shaft Spring	1	51493 BK	Lint Filter Screen	2	52936	Feed Rocker Shaft Bushing
1	51280 E	Upper Knife Lever Stud Support Bracket (667 B-10, 22517)	1	51493 BP	Oil Pump Driving Gear (22560 B)	1	52944 T	Looper Rocker Shaft Bushing, left
1	51280 J	Chip Guard (22550)	1	51493 BQ	Oil Pump Driven Gear (531)	1	52944 U	Looper Rocker Shaft Bushing, right
1	51280 E	Throat Plate Support Pin (258)	1	51704	Cast-off Plate (28)	1	52971 J	Knife Clamp Plate (22799N)
2	51280 J	Dowel Pin for 51280 N	1	51723 A	Take-up (96, 22580 D)	1	52972	Knife Guide Collar (166)
1	51280 N	Throat Plate Support (80)	1	51745	Looper Rocker Cone Stud for 29192 (258 A, 22829, 51246)	1	52978 G	Hinge Pin for 51282 AJ
1	51281 AN	Cloth Plate Cover Spring (22760 A, 22845 B, 35772 H)	1	51757 B	Cast-off Plate Support (21657 E, 22528)	1	53783 A	Lifter Lever Link (402, 22758 C)
1	51281 AP	Cloth Plate Cover Adjustable Extension (77 F)	1	51758	Frame Needle Thread Eyelet (20, 22848, 22889 A)	1	53783 L	Presser Foot Lifter Lever Bell Crank (22557 B)
1	51281 AR	Cloth Plate Cover Adjustable Extension (77 F)	1	52336	Link Pin for 52373 C (660-215)	1	53783 M	Presser Foot Lifter Lever Connecting Rod
1	51282 Y	Head Cover (22569 B)	2	52373 A	Bushing for 52373	1	53783 N	Presser Foot Lifter Lever, internal (22537)
1	51282 Z	Gasket for 51282 Y	1	52373 B	Knife Arm Stud	1	55241 E	Spring for 51241 K
1	51282 AE	Needle Lever Bearing Oiler (90)	1	52373 C	Knife Arm	1	55241 N	Looper Connecting Rod Ball Joint, left (18)
1	51282 AF	Oil Reservoir Top Cover (22524, 22585 A)	1	52470	Stop for looper connecting rod	1	55244 G	Looper Rocker Shaft Collar Stud (18, 51216 N)
1	51282 AH	Oil Shield (20, 22848)	1	52703 A	Edge Guide	1	56315	Needle Lever for 29348 Y
1	51282 AJ	Hinged Oil Shield (25 S)	2	52782 C	Adaptor Screw for 21171 S	1	56334 E	Feed Dog Holder (258 A, 51134 J)
2	51282 AK	Spring for 51282 AJ	1	52794 G	Oil Tube for feed lift and looper	1	56341 G	Spring for 51241 K
1	51283 H	Presser Foot Lifter and Tension Disc Release Lever	1	52841 G	Locking Stud for 51242 Y (52841 J)	1	56350 A	Needle Lever Stud for 29348 Y (719)
1	51290 T	Main Shaft Bushing, middle	1	52841 J	Nut for 52841 G	1	56354 A	Needle Bar Link for 29348 Y
1	51291 A	Looper Thread Guard (98 A)	1	52882 L	Oil Reservoir Back Cover (22733 B, 22848, 41394 A)	1	56356	Presser Spring Regulator
2	51292 A	Tension Post Ferrule	1	52882 M	Gasket for 52882 L	1	56358	Needle Bar Thread Eyelet (22768)
2	51292 C	Tension Nut	1	52882 P	Gasket for 52882 AD	1	56358 A	Needle Lever Thread Eye, (22768)
2	51292 D	Tension Thread Eyelet	1	52882 U	Gasket for 52882 AE	1	56390 E	Crankshaft Bearing Housing Gasket
1	51292 F-1	Tension Spring, looper	1	52882 W	Gasket for 22542	2	80557	Spacing Washer for 21657-3 52892
1	51292 F-5	Tension Spring, needle	1	52882 Y	Baffle Plate (90)	1	92201	Spring Adjusting Screw for 21664 F, (12982)
2	51292 G	Tension Post (43266)	1	52882 AA	Oil Drip Plate for 52882 AD (90)			
1	51294 K	Upper Clamp for 51294 U	1	52882 AC	Oil Cap Torsion Spring for 52882 AD			
1	51294 M	Oil Siphon Tube	1	52882 AD	Chamber Cover (22541 B)			
1	51294 P	Oil Tube Clamp (7947, 51294 R)	1	52882 AE	Crank Chamber Cover (22548)			
1	51294 R	Screw for 51294 P (7947)	1	52883 R	Presser Foot Lifter Lever Bushing			
1	51294 U	Oil Siphon Assembly (22729 A, 22729 B)	1	52883 S	Presser Foot Lifter Lever Bell Crank Spring			
1	51294 X	Oil Tube for knife arm	2	52890 C	Main Shaft Bushing, left and inner right			
1	51294 Z	Oil Siphon Tube Connection (21212)	1	52891 B	Crankshaft Housing, includes bushing (22569 B)			
1	51382 A	Gasket for 51282 AF						
1	51406	Eccentric for 29476 DV (22894 D)						
1	51409 C	Looper (73, 21210 A)						
2	51491 C	Lead-in Thread Eyelet						

NOTE: Numbers in parenthesis following parts description indicate the screws, nuts, etc., used to attach or hold these parts.

22768

56358

27-435Blk.

51230 AE

51230 AD

51220 K

51205 K

51217 E

22801

22585 B

51225 W

51225

51409 C

21210 A

28

51704

50-216 Blk.

51757 B

21657 E

22528

96

Spot

22580 D

51723 A

22528

87

51224 K-1/8

87

22819



(2) 51280 J



(2) 80



51280 N

29476 KN

22894 T

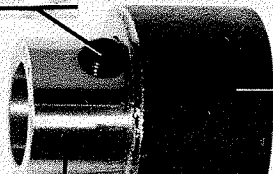

51145 E

51142 F

52336

(2) 22894 C

52373 B

52373 C

(2) 667 B-10

51273 C

39271 A

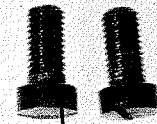

(2) 22517

906

52972

51272 D

39270 E

(2) 166

51250 S



906 A

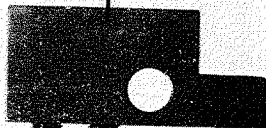

(2) 22596 D

20149 C



51250 T

22799 N

52971 J

51242 M



22852 A

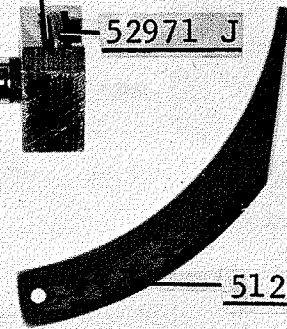

51249 B

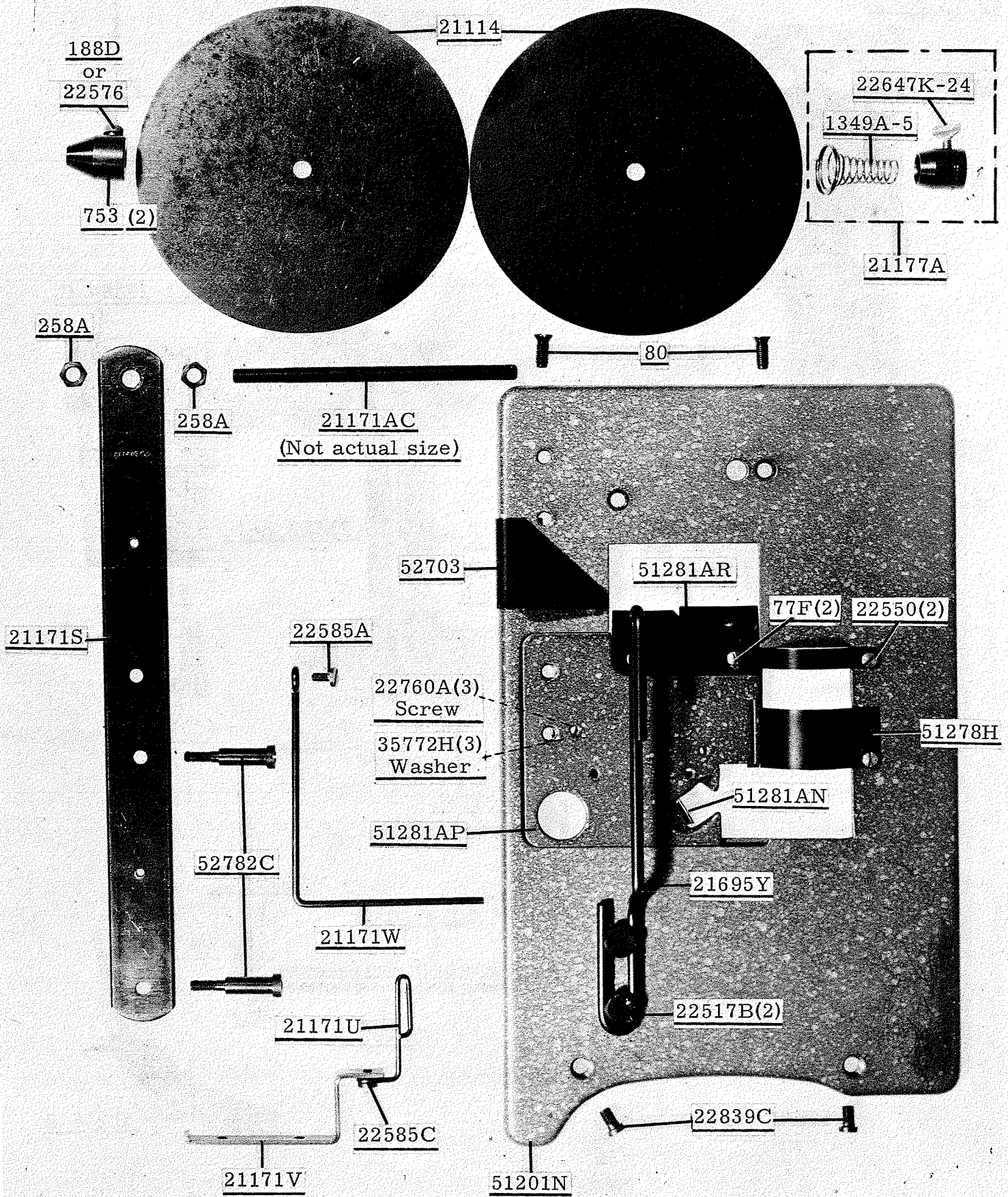

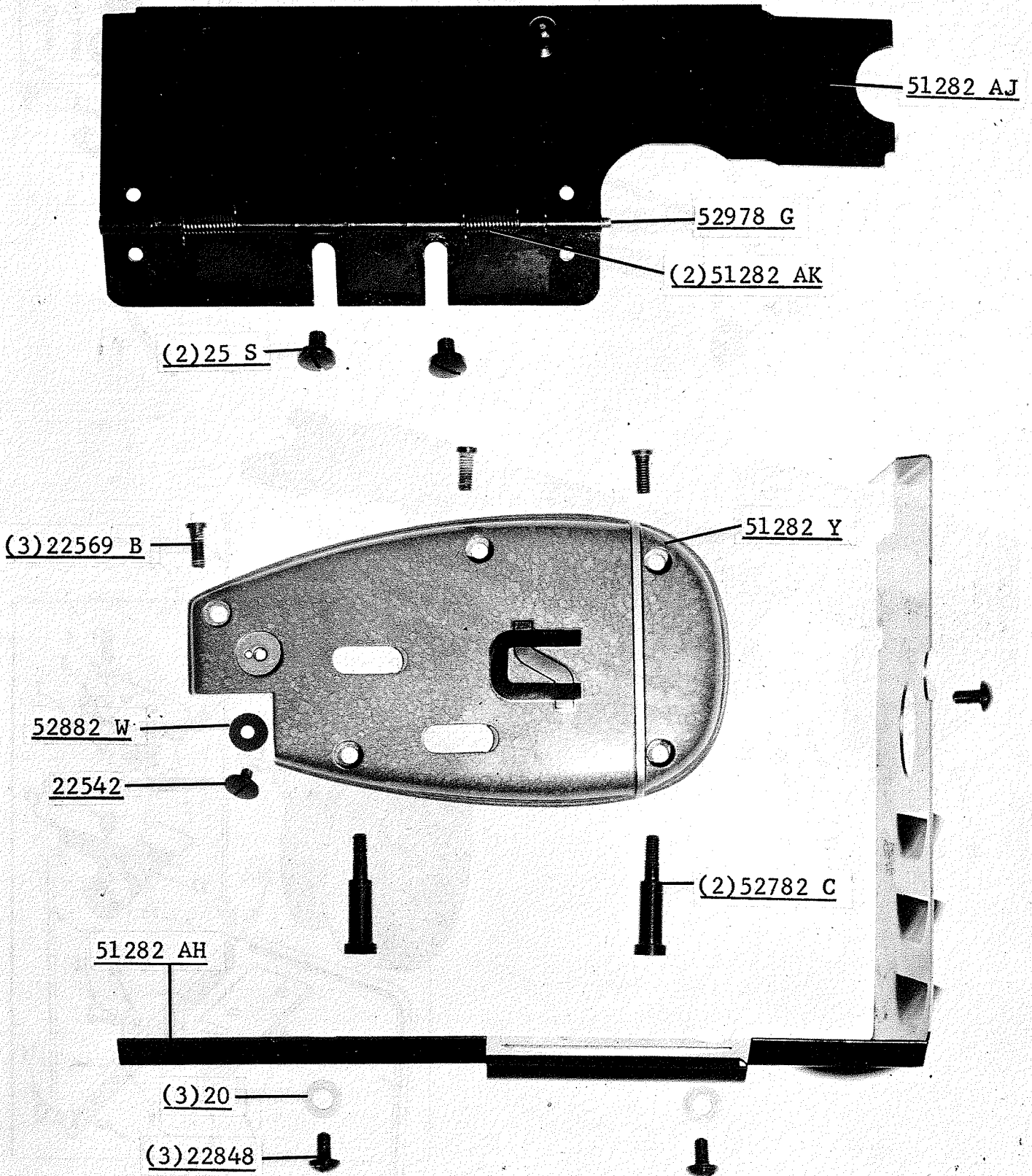

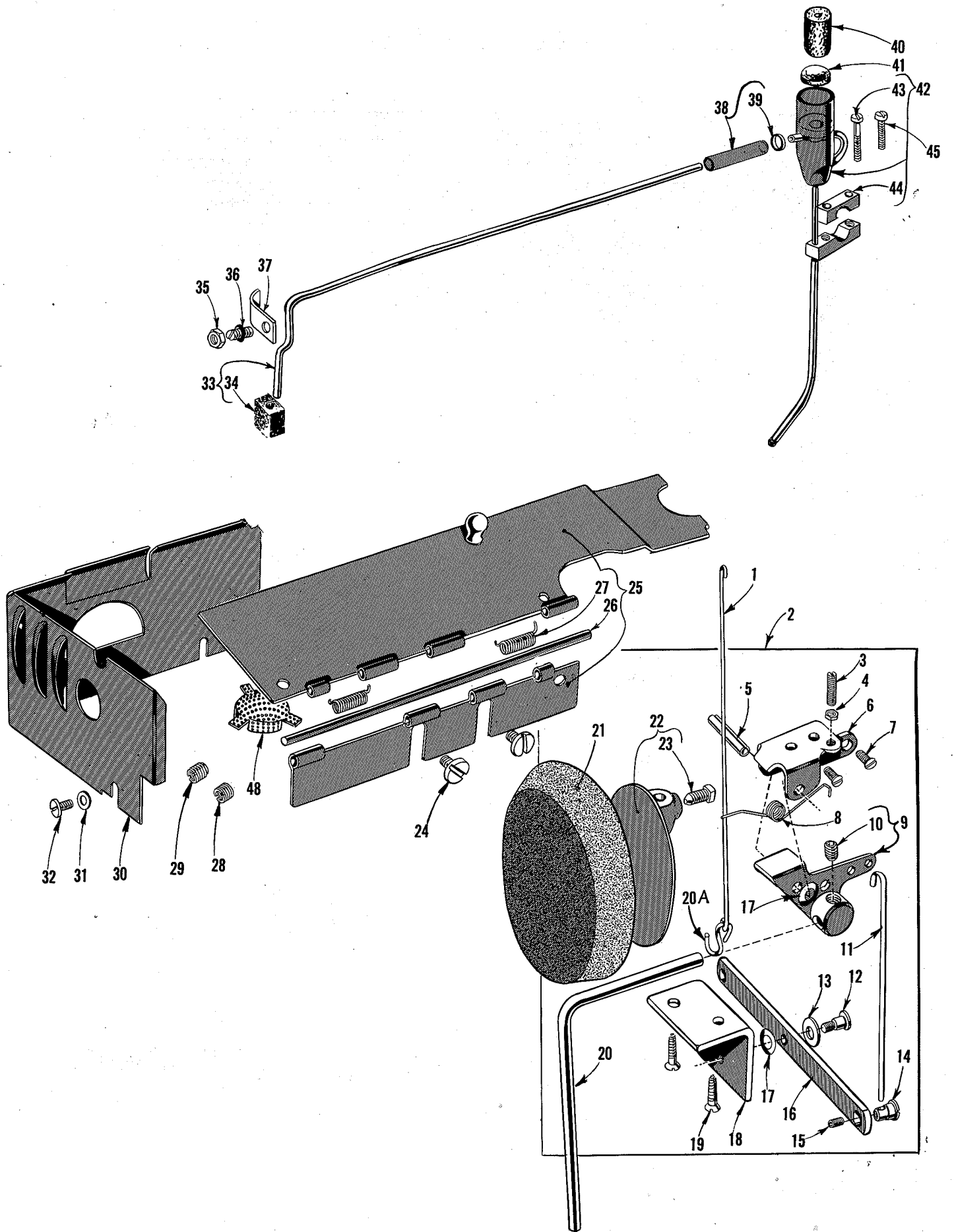

KNEE PRESS ASSEMBLY, OIL SIPHON ASSEMBLY AND  
MISCELLANEOUS COVERS

Ref. No.	Part No.	Description	Amt. Req.
1	51493 BC	Lifter Link -----	1
2	21660 H	Knee Press Assembly -----	1
3	92201	Screw -----	1
4	12982	Nut -----	1
5	660-219 G	Roll Pin -----	1
6	21664 F	Mounting Bracket -----	1
7	80	Screw, for attaching -----	2
8	21662 V	Torsion Spring -----	1
9	21662 R	Knee Press Lifter Arm -----	1
10	22650 CE-6	Screw -----	1
11	21662 T	Knee Press Link -----	1
12	22557 A	Screw -----	1
13	43137 E	Washer -----	1
14	21662 S	Knee Press Link Connection -----	1
15	531	Screw -----	1
16	21662 U	Knee Press Lever -----	1
17	39536 AD	Spring Washer -----	2
18	21664 C	Bracket -----	1
19	SC303	Wood Screw, #12 x 1 inch -----	2
20	21663 A	Knee Press Plate Lever -----	1
20A	660-264	"S" Hook -----	1
21	660-168	Knee Press Plate Cushion -----	1
22	21664	Knee Press Plate -----	1
23	69 FD	Screw -----	1
24	25 S	Screw -----	2
25	51282 AJ	Hinged Oil Shield -----	1
26	52978 G	Hinge Pin -----	1
27	51282 AK	Spring -----	2
28	22889 D	Adaptor Plug Screw, left side -----	1
29	22889 C	Adaptor Plug Screw, back -----	2
30	51282 AH	Oil Shield -----	1
31	20	Washer -----	3
32	22848	Screw -----	3
33	51294 M	Oil Siphon Tube -----	1
34	666-214	Felt Lint Filter -----	1
35	7947	Nut -----	1
36	51294 R	Screw -----	1
37	51294 P	Oil Tube Clamp -----	1
38	51294 Z	Oil Tube Connection -----	1
39	21212	Locking Ring, for oil siphon connection -----	1
40	666-201	Felt Plug -----	1
41	666-209	Felt Plug -----	1
42	51294 U	Oil Siphon Assembly -----	1
43	22729 B	Screw -----	1
44	51294 K	Clamp, upper -----	1
45	22729 A	Screw -----	1
48	51493 BK	Lint Filter Screen -----	1

# Here are Oil Specifications for Union Special Sewing Machines



**Specification 174** specifies a high quality petroleum oil, viscosity 100 seconds at 100°F. Recommended for all oiling applications on high speed machines.

**Specification 175** specifies a high quality petroleum oil, viscosity 100 seconds at 100°F., water white or with a maximum A.S.T.M. color number of 1. *For use where freedom from oil staining is paramount.*

**Specification 87** specifies a high quality petroleum oil, viscosity 300 seconds at 100°F.

**Specification 100** specifies a general purpose high quality grease for use in ball bearings and transmitters. It is similar to commercial N.L.G.I., grease No. 3. Where No. 3 grease is not obtainable, No. 2 may be used.

## UNION SPECIAL

SPECIFICATION NO.	174	175	87
Viscosity S.S.U. at 100°F	90-125	90-125	300-350
Flash (Min.)	350	350	350
Pour (Max.)	20	20	20
Color A.S.T.M. (Max.)	3	1	3
Neutralization No. (Max.)	0.10	0.10	0.10
Viscosity Index (D & D Min.)	85	85	85
Compounding	None	None	None
Copper Corrosion (Max.)	1A	1A	1A

\*Anline No. 175-225 175-225 175-225

\*Used with Buna N Rubber "O" Retainers

**NOTE 1:** The use of non-corrosive additives in oils meeting above classification is desirable but not essential. These may include:

1. Oxidation inhibitors
2. Rust inhibitors
3. Lubricity additives
4. Anti-oxidants
5. Film strength additives

These additives must be completely soluble in the oil and not removable by wick feeding nor shall they separate.

**NOTE 2:** Oils containing the following type additives shall not be used at any time:

1. Extreme pressure additives—corrosive
2. Tackiness or adhesive additives
3. Lead soap additives
4. Detergents



**UNION SPECIAL  
CORPORATION**



1. The first part of the document discusses the importance of maintaining accurate records of all transactions and activities. This is essential for ensuring transparency and accountability in the organization's operations.

2. The second part of the document outlines the various methods and techniques used to collect and analyze data. This includes both qualitative and quantitative approaches, as well as the use of advanced statistical tools and software.

3. The third part of the document focuses on the challenges and limitations of data collection and analysis. It highlights the need for careful planning and execution to overcome these obstacles and ensure the reliability of the results.

4. The fourth part of the document provides a detailed overview of the data analysis process, from the initial data cleaning and preprocessing to the final interpretation and reporting of findings. It emphasizes the importance of clear communication and documentation throughout the entire process.

5. The fifth part of the document discusses the ethical considerations and best practices associated with data collection and analysis. It stresses the need for transparency, honesty, and respect for the privacy and rights of individuals whose data is being used.

6. The sixth part of the document concludes with a summary of the key points and a call to action for the organization to continue to improve its data management and analysis practices. It encourages a culture of continuous learning and innovation in the field of data science.

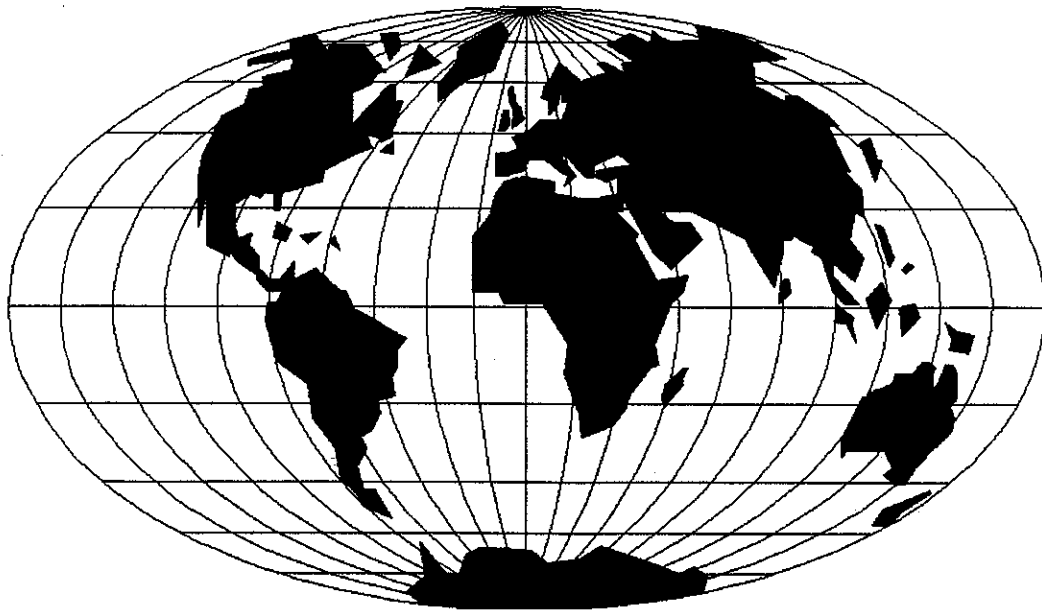

## WORLDWIDE SALES AND SERVICE

Union Special Corporation maintains sales and service facilities throughout the world. These offices will aid you in the selection of the right sewing equipment for your particular operation. Union Special Corporation representatives and service technicians are factory trained and are able to serve your needs promptly and efficiently. Whatever your location, there is a qualified representative to serve you.

---

Brussels, Belgium  
Charlotte, N.C.  
El Paso, TX  
Hong Kong, China  
Huntley, IL  
Leicester, England  
Lille, France  
Miami, FL  
Milan, Italy  
Möglingen, Germany  
Montreal, Quebec  
Osaka, Japan  
Santa Fe Springs, CA

Other Representatives throughout  
all parts of the world.



*Union Special*  
INDUSTRIAL SEWING EQUIPMENT