

SINGER
307G2

FORM 21097
(1059)
PRINTED IN U. S. A.

LIST OF PARTS COMPLETE
FOR
MACHINE No. 307G2

THE SINGER MANUFACTURING COMPANY

SINGER 30782

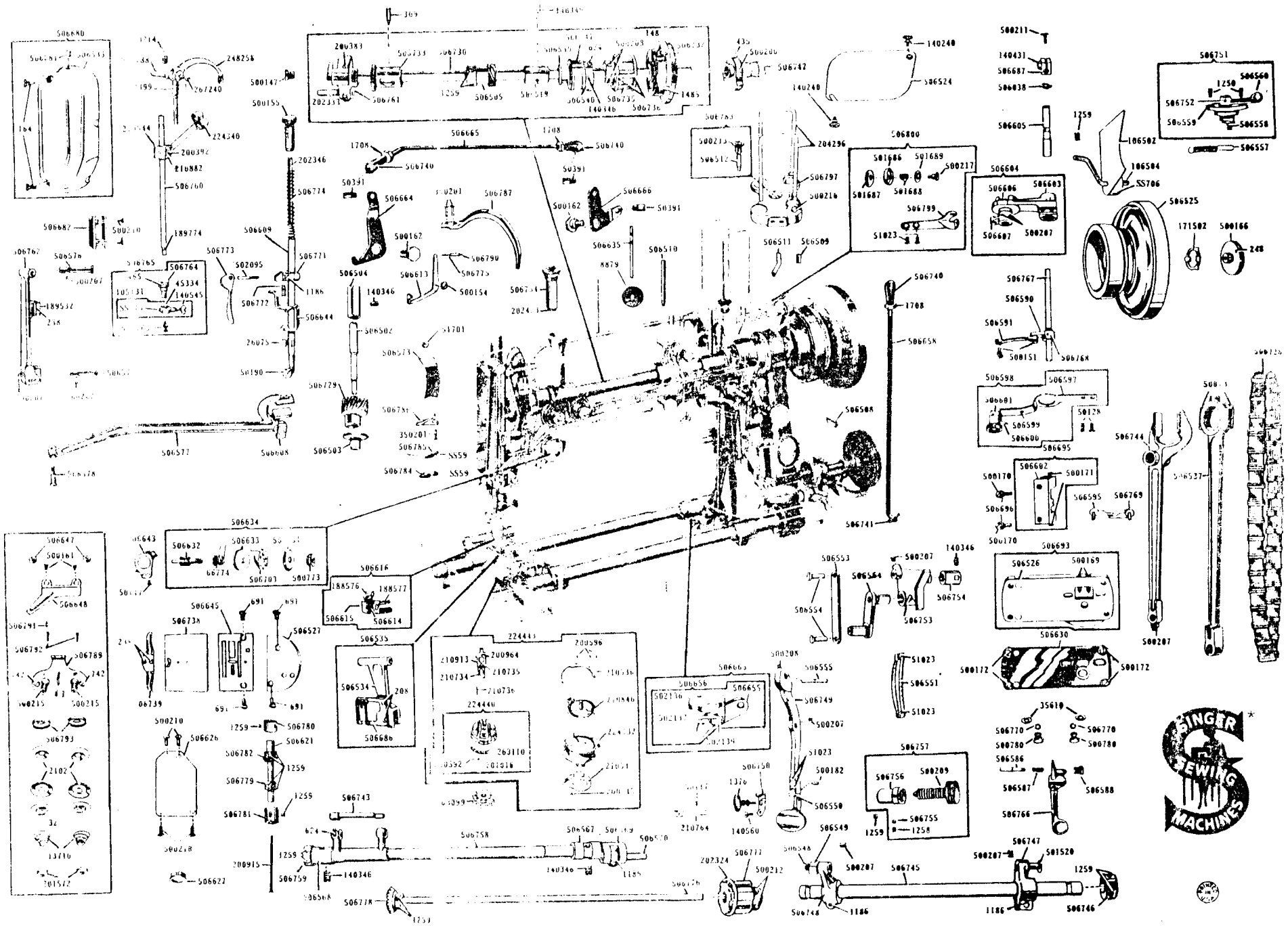

LIST OF PARTS COMPLETE

FOR

MACHINE NO. 307G2

Single Needle, Lock Stitch, Transverse Hook, Drop Feed Mechanism
Makes Straight or Zig-Zag Stitches. For General Tailoring Work.

| No. | Name |
|----------|--|
| 506727 | Arm with 1259AL and four 140543L |
| 506728 | Arm and Bed, Nos. 500203E, 506727, 506737, two 506507 and three 500204E |
| 506502 | Arm Cross Shaft |
| 506503 | Arm Cross Shaft Bushing (fork end) |
| 506504 | Arm Cross Shaft Clamping Bushing |
| 140346AL | Arm Cross Shaft Clamping Bushing Set Screw |
| 506505 | Arm Cross Shaft Driving Worm with two 1259AL |
| 1259AL | Arm Cross Shaft Driving Worm Set Screw (2) |
| 506729 | Arm Cross Shaft Spiral Gear and Needle Bar Frame Pitman Eccentric |
| 506507 | Arm Dowel Pin (2) |
| 506508 | Arm Oil Tube, for oiling Arm Cross Shaft Spiral Gear and Needle Bar Frame Pitman Eccentric and Needle Vibrator Zero Position Lever Swivel Stud Slide Block (3) |
| 506509 | Arm Oil Tube, for oiling Arm Shaft Bushing (back) |
| 506510 | Arm Oil Tube, for oiling Arm Shaft Bushing (intermediate) |
| 506511 | Arm Oil Tube, for oiling Feed Eccentric |
| 500203E | Arm Screw (long) |
| 500204E | Arm Screw (short) (3) |
| 506730 | Arm Shaft |
| 506731 | Arm Shaft 506730 with 500147F, 506523 and 506761 |
| 506732 | Arm Shaft Bushing (back) |
| 1485X | Arm Shaft Bushing (back) Cap Screw (4) |
| 506733 | Arm Shaft Bushing (front) |
| 506734 | Arm Shaft Bushing (front) Oil Tube |
| 204329 | Arm Shaft Bushing (front) Oil Tube Packing (felt) |
| 202423 | Arm Shaft Bushing (front) Oil Tube Packing (wick) |
| 309C | Arm Shaft Bushing (front) Set Screw |
| 506519 | Arm Shaft Bushing (intermediate) |
| 140346AL | Arm Shaft Bushing (intermediate) Set Screw |
| 506726 | Arm Shaft Connection Belt |
| 506735 | Arm Shaft Connection Belt Pulley with two each 500205AL and 506736 |
| 500205AL | Arm Shaft Connection Belt Pulley Set Screw (2) |
| 506736 | Arm Shaft Connection Belt Pulley Spring Ring (2) |
| 506523 | Arm Shaft Packing (cotton) |

| No. | Name |
|----------|---|
| 500147F | Arm Shaft Screw |
| 506524 | Arm Side Cover (back) |
| 140240W | Arm Side Cover (back) Thumb Screw (2) |
| 506526 | Arm Side Cover (front) |
| 506693 | Arm Side Cover (front) 506526 with two 500169X |
| 506737 | Bed |
| 506527 | Bed Cover Plate |
| 691AL | Bed Cover Plate Screw (2) |
| 506738 | Bed Slide |
| 506739 | Bed Slide Spring |
| 238X | Bed Slide Spring Screw (2) |
| 506655 | Bell Crank |
| 506656 | Bell Crank 506655 with 502136 and 502137 |
| 502136 | Bell Crank Bracket |
| 178E | Bell Crank Bracket Screw (2) |
| 506638 | Bell Crank Connecting Rod |
| 506740 | Bell Crank Connecting Rod Joint |
| 50391XC | Bell Crank Connecting Rod Joint Hinge Screw |
| 1708X | Bell Crank Connecting Rod Lock Nut |
| 506741 | Bell Crank Connecting Rod Retaining Pin |
| 502137 | Bell Crank Hinge Pin |
| 502139 | Bell Crank Spring |
| 506663 | Bell Crank complete, Nos. 502139 and 506656 |
| 106502 | Belt Guard with two SS706X |
| 106504 | Belt Guard Holder |
| 1259AL | Belt Guard Holder Set Screw |
| SS 706X | Belt Guard Set Screw |
| 500166J | Clamp Stop Motion Clamp Screw |
| 248A | Clamp Stop Motion Clamp Stop Screw |
| 171502 | Clamp Stop Motion Clamp Washer |
| 506742 | Clamp Stop Motion Flanged Bushing with 435AL and 500206AL |
| 500206AL | Clamp Stop Motion Flanged Bushing Position Screw |
| 435AL | Clamp Stop Motion Flanged Bushing Set Screw |
| 140543L | Class Number Plate Drive Screw (2) |
| 506533 | Face Plate |
| 506680 | Face Plate 506533 with 506681 |
| 506681 | Face Plate Oil Tube |
| 164X | Face Plate Screw (2) |
| 506534 | Feed Bar |
| 506535 | Feed Bar 506534 with 506686 and two 208AL |
| 506743 | Feed Bar Hinge Pin (eccentric) |
| 624ALX | Feed Bar Hinge Pin Set Screw |
| 506537 | Feed Connecting Rod with two 50073C |
| 50073C | Feed Connecting Rod Cap Screw (2) |

| No. | Name |
|----------|---|
| 140346AL | Feed Regulator Segment Bushing Set Screw |
| 506564 | Feed Regulator Segment Connecting Arm |
| 500209K | Feed Regulator Stop Screw |
| 1258AL | Feed Regulator Stop Screw Adjusting Screw |
| 506755 | Feed Regulator Stop Screw Adjusting Screw Washer |
| 506756 | Feed Regulator Stop Screw Bushing |
| 506757 | Feed Regulator Stop Screw Bushing 506756 with 1258AL, 500209K and 506755 |
| 1259AL | Feed Regulator Stop Screw Bushing Set Screw |
| 506758 | Feed Eock Shaft with 624ALX |
| 506759 | Feed Rock Shaft Adjusting Collar with two 1259AL |
| 1259AL | Feed Rock Shaft Adjusting Collar Set Screw (2) |
| 506567 | Feed Rock Shaft Bushing (back) |
| 140346AL | Feed Rock Shaft Bushing (back) Set Screw |
| 506568 | Feed Rock Shaft Bushing (front) |
| 140346AL | Feed Rock Shaft Bushing (front) Set Screw |
| 506569 | Feed Rock Shaft Crank with 1186C |
| 1186C | Feed Rock Shaft Crank Clamping Screw |
| 506570 | Feed Rock Shaft Crank Hinge Pin |
| 500207C | Feed Rock Shaft Crank Hinge Pin Set Screw |
| 506664 | Lifting Lever |
| 500162X | Lifting Lever Hinge Screw |
| 506665 | Lifting Lever Pitman Rod |
| 506666 | Lifting Lever Pitman Rod Connection |
| 500162X | Lifting Lever Pitman Rod Connection Hinge Screw (2) |
| 506740 | Lifting Lever Pitman Rod Joint (2) |
| 50391XC | Lifting Lever Pitman Rod Joint Hinge Screw (2) |
| 1708X | Lifting Lever Pitman Rod Lock Nut (2) |
| 506525 | Machine Pulley |
| 506760 | Needle Bar with 189774 |
| 224340 | Needle Bar Connecting Link |
| 506682 | Needle Bar Connecting Link Guide Bar |
| 500210C | Needle Bar Connecting Link Guide Bar Screw (2) |
| 202333 | Needle Bar Connecting Link Stud with 202254 |
| 202254 | Needle Bar Connecting Link Stud Oil Packing (wick) |
| 200383C | Needle Bar Connecting Link Stud Position Screw |
| 200383C | Needle Bar Connecting Link Stud Set Screw |
| 210544 | Needle Bar Connecting Stud with 202299 |
| 202299 | Needle Bar Connecting Stud Oil Packing (wick) |
| 210882 | Needle Bar Connecting Stud Swivel with 200392C |
| 200392C | Needle Bar Connecting Stud Swivel Set Screw |
| 506761 | Needle Bar Crank with 200335C, 200428C, 202333 and two 200383C |
| 506573 | Needle Bar Crank Oil Guard |
| 200428C | Needle Bar Crank Position Screw |
| 200335C | Needle Bar Crank Set Screw |

| No. | Name |
|----------|---|
| 506762 | Needle Bar Frame with 238X, 189532 and 500207C |
| 506575 | Needle Bar Frame Guide Stud |
| 500207C | Needle Bar Frame Guide Stud Set Screw |
| 506576 | Needle Bar Frame Hinge Stud |
| 500207C | Needle Bar Frame Hinge Stud Set Screw |
| 506577 | Needle Bar Frame Pitman (forked) |
| 506578 | Needle Bar Frame Pitman Eccentric Stud |
| 500207C | Needle Bar Frame Pitman Eccentric Stud Set Screw |
| 189532 | Needle Bar Height Indicator |
| 238X | Needle Bar Height Indicator Screw |
| 45334 | Needle Clamp with 140545J |
| 105131 | Needle Clamp 45334 with SS675AL |
| 506763 | Needle Clamp Gib and Thread Guide |
| SS 675AL | Needle Clamp Position Screw |
| 140545J | Needle Clamp Thumb Screw |
| 506764 | Needle Holder with 465J |
| 506765 | Needle Holder complete, Nos. 105131, 506763 and 506764 |
| 465J | Needle Holder Clamping Screw |
| 189774 | Needle Holder Position Pin |
| 506766 | Needle Vibrator Amplitude Regulating Lever with two 500207AL |
| 506586 | Needle Vibrator Amplitude Regulating Lever Position Pin |
| 506587 | Needle Vibrator Amplitude Regulating Lever Position Pin Spring |
| 506588 | Needle Vibrator Amplitude Regulating Lever Position Pin Thumb Nut |
| 500207AL | Needle Vibrator Amplitude Regulating Lever Set Screw (2) |
| 506767 | Needle Vibrator Amplitude Regulating Lever Shaft complete, Nos. 500151C, 506590, 506591 and 506768 |
| 500211X | Needle Vibrator Amplitude Regulating Lever Shaft Cap Screw |
| 506590 | Needle Vibrator Amplitude Regulating Lever Shaft Crank |
| 506591 | Needle Vibrator Amplitude Regulating Lever Shaft Crank Connecting Link |
| 500151C | Needle Vibrator Amplitude Regulating Lever Shaft Crank Connecting Link Hinge Screw (2) |
| 506768 | Needle Vibrator Amplitude Regulating Lever Shaft Crank Pin |
| 506038 | Needle Vibrator Amplitude Regulating Lever Shaft Friction Washer |
| 506687 | Needle Vibrator Amplitude Regulating Lever Shaft Pressure Block with 140431X |
| 140431X | Needle Vibrator Amplitude Regulating Lever Shaft Pressure Block Clamping Screw |
| 506595 | Needle Vibrator Amplitude Regulating Lever Stop (left) |
| 500780A | Needle Vibrator Amplitude Regulating Lever Stop (left) Thumb Nut |
| 506769 | Needle Vibrator Amplitude Regulating Lever Stop (right) |
| 500780A | Needle Vibrator Amplitude Regulating Lever Stop (right) Thumb Nut |
| 35610 | Needle Vibrator Amplitude Regulating Lever Stop Friction Washer (2) |
| 506770 | Needle Vibrator Amplitude Regulating Lever Stop Washer (2) |
| 500169X | Needle Vibrator Amplitude Regulating Lever Stop Screw (2) |
| 506597 | Needle Vibrator Zero Position Control Lever |

| No. | Name |
|----------|---|
| 506598 | Needle Vibrator Zero Position Control Lever 506597 with 506599, 506600 and 506601 |
| 506599 | Needle Vibrator Zero Position Control Lever Button |
| 506600 | Needle Vibrator Zero Position Control Lever Indicator |
| 506601 | Needle Vibrator Zero Position Control Lever Push Button |
| 50128X | Needle Vibrator Zero Position Control Lever Screw (2) |
| 506602 | Needle Vibrator Zero Position Control Lever Stop Block |
| 506695 | Needle Vibrator Zero Position Control Lever Stop Block 506602 with two 500171X |
| 500170XC | Needle Vibrator Zero Position Control Lever Stop Block Screw (2) |
| 506696 | Needle Vibrator Zero Position Control Lever Stop Block Screw Washer (2) |
| 500171X | Needle Vibrator Zero Position Control Lever Stop Screw (2) |
| 506603 | Needle Vibrator Zero Position Lever |
| 506604 | Needle Vibrator Zero Position Lever 506603 with 506606 and 506607 |
| 506605 | Needle Vibrator Zero Position Lever Bearing |
| 506606 | Needle Vibrator Zero Position Lever Swivel Stud |
| 506607 | Needle Vibrator Aero Position Lever Swivel Stud Crank with two 500207C |
| 500207C | Needle Vibrator Zero Position Lever Swivel Stud Crank Set Screw (2) |
| 506608 | Needle Vibrator Zero Position Lever Swivel Stud Slide Block |
| 506609 | Presser Bar |
| 506771 | Presser Bar Guide with 1186C |
| 1186C | Presser Bar Guide Clamping Screw |
| 506722 | Presser Bar Guide Pressure Spring |
| 506773 | Presser Bar Lifter |
| 502095 | Presser Bar Lifter Hinge Pin |
| 506774 | Presser Bar Spring |
| 202346 | Presser Bar Spring Stop Rod |
| 506613 | Presser Bar Tension Release Lever |
| 500154E | Presser Bar Tension Release Lever Hinge Screw |
| 506775 | Presser Bar Tension Release Lever Pressure Spring |
| 506614 | Presser Foot Hinge Pin |
| 188577 | Presser Foot Plate |
| 188576 | Presser Foot Shank |
| 506615 | Presser Foot Spring |
| 506616 | Presser Foot complete, Nos. 188576, 188577, 506614 and 506615 |
| 50190J | Presser Foot Screw |
| 500155J | Pressure Regulating Thumb Screw |
| 224432 | Rotating Hook with 203101 and 263134 |
| 224433 | Rotating Hook 224432 with 200145C, 210536, 210541 and three 200596F |
| 224443 | Rotating Hook and Bobbin Case complete, Nos. 224433 and 224442 |
| 263099 | Rotating Hook Bobbin |
| 224442 | Rotating Hook Bobbin Case complete, Nos. 210846 and 224441 |
| 210846 | Rotating Hook Bobbin Case Base |
| 224440 | Rotating Hook Bobbin Case Cap with 200592C, 201016C and 263110 |

| No. | Name |
|----------|---|
| 224441 | Rotating Hook Bobbin Case Cap complete, Nos. 200964C, 210736, 210914 and 224440 |
| 210913 | Rotating Hook Bobbin Case Latch |
| 210914 | Rotating Hook Bobbin Case Latch 210913 with 210734 and 210735 |
| 210734 | Rotating Hook Bobbin Case Latch Lever |
| 210735 | Rotating Hook Bobbin Case Latch Lever Fulcrum Pin |
| 210736 | Rotating Hook Bobbin Case Latch Spring |
| 200964C | Rotating Hook Bobbin Case Latch Stop Screw |
| 263110 | Rotating Hook Bobbin Case Tension Spring |
| 201016C | Rotating Hook Bobbin Case Tension Spring Regulating Screw |
| 200592C | Rotating Hook Bobbin Case Tension Spring Screw |
| 506776 | Rotating Hook Driving Shaft |
| 506777 | Rotating Hook Driving Shaft Connection Belt Pulley with 202324 and two 500212AL |
| 500212AL | Rotating Hook Driving Shaft Connection Belt Pulley Set Screw (2) |
| 202324 | Rotating Hook Driving Shaft Connection Belt Pulley Spring Ring |
| 506778 | Rotating Hook Driving Shaft Spiral Gear with two 1259AL |
| 1259AL | Rotating Hook Driving Shaft Spiral Gear Set Screw (2) |
| 210536 | Rotating Hook Gib |
| 200596F | Rotating Hook Gib Screw (3) |
| 203101 | Rotating Hook Oil Wick |
| 263134 | Rotating Hook Oiling Felt |
| 210764 | Rotating Hook Position Finger |
| 50117AL | Rotating Hook Position Finger Screw |
| 200915C | Rotating Hook Retaining Screw |
| 506621 | Rotating Hook Shaft |
| 506779 | Rotating Hook Shaft Adjusting Collar with two 1259AL |
| 1259AL | Rotating Hook Shaft Adjusting Collar Set Screw (2) |
| 506780 | Rotating Hook Shaft Bushing (back) |
| 506781 | Rotating Hook Shaft Bushing (front) |
| 1259AL | Rotating Hook Shaft Bushing Set Screw (2) |
| 506782 | Rotating Hook Shaft Spiral Gear with two 1259AL |
| 506626 | Rotating Hook Shaft Spiral Gear Cover |
| 500210X | Rotating Hook Shaft Spiral Gear Cover Screw (4) |
| 506627 | Rotating Hook Shaft Spiral Gear Grease Plug |
| 1259AL | Rotating Hook Shaft Spiral Gear Set Screw (2) |
| 210541 | Rotating Hook Washer Needle Guard |
| 200145C | Rotating Hook Washer Needle Guard Screw |
| 500213XC | Spool Holder Bracket Screw |
| 506783 | Spool Holder Bracket Screw 500213XC with 206512 |
| 506512 | Spool Holder Bracket Screw Oil Tube |
| 506630 | Stitch Pattern Central Indicator Plate |
| 500172XC | Stitch Pattern Central Indicator Plate Screw (4) |
| 506631 | Tension Friction Washer |
| 500773 | Tension Regulating Thumb Nut |

| No. | Name |
|----------|---|
| 506632 | Tension Stud |
| 624AL | Tension Stud Set Screw |
| 506633 | Tension Wheel |
| 506634 | Tension (wheel) complete, Nos. 66774, 500773B, 506631, 506632, 506633 and 506703 |
| 26075 | Thread Cutter and Holder |
| 506784 | Thread Guide (side of arm) lower |
| SS 59K | Thread Guide (side of arm) lower and middle Screw (2) |
| 506785 | Thread Guide (side of arm) middle |
| 506786 | Thread Guide (side of arm) upper |
| 350201K | Thread Guide (side of arm) upper and Needle Bar Crank Oil Guard Screw |
| 51701E | Thread Guide (side of arm) upper and Needle Bar Crank Oil Guard Screw Nut |
| 506635 | Thread Guide and Spool Pin (top of arm) |
| 8879 | Thread Guide and Spool Pin Washer (cloth) |
| 506787 | Thread Take-up Guard |
| 350201K | Thread Take-up Guard Screw (2) |
| 248258 | Thread Take-up Lever |
| 202399 | Thread Take-up Lever Driving Stud with 244071 |
| 244071 | Thread Take-up Lever Driving Stud Oil Packing (wick) |
| 506788 | Thread Take-up Lever Hinge Stud with 267240 |
| 267240 | Thread Take-up Lever Hinge Stud Oil Packing (wick) |
| 500214AL | Thread Take-up Lever Hinge Stud Set Screw |
| 66774 | Thread Take-up Spring |
| 506643 | Thread Take-up Spring Regulator and Thread Guide |
| 50117AE | Thread Take-up Spring Regulator and Thread Guide Screw |
| 506703 | Thread Take-up Spring Thread Guard |
| 506644 | Thread Tension Lifter Lever |
| 506645 | Throat Plate |
| 691ALX | Throat Plate Screw (2) |
| 2102 | Two Thread Tension Disc (4) |
| 506789 | Two Thread Tension Plate with 506648, 506791 and two each 500161K, 500215J and 506792 |
| 506647 | Two Thread Tension Plate Spacer (2) |
| 742J | Two Thread Tension Plate Screw (2) |
| 201572B | Two Thread Tension Regulating Thumb Nut (2) |
| 32572 | Two Thread Tension Releasing Disc (2) |
| 506648 | Two Thread Tension Releasing Lever |
| 506790 | Two Thread Tension Releasing Lever Pin |
| 506791 | Two Thread Tension Releasing Lever Pressure Spring |
| 500161K | Two Thread Tension Releasing Lever Screw (2) |
| 506792 | Two Thread Tension Releasing Pin (2) |
| 13710 | Two Thread Tension Spring (2) |
| 500215J | Two Thread Tension Stud (2) |
| 506793 | Two Thread Tension Stud Flange (2) |
| 140543L | Trade Mark Drive Screw (2) |
| 139637 | Drip Pan with four 1 in. wire nails |

ACCESSORIES
(Supplied with Machine)

| No. | Name |
|-------|--|
| 12361 | Machine Hinge Connection (2) |
| 44139 | Machine Hinge Plate (2) |
| 44140 | Machine Hinge complete, Nos. 12361, 44139 and wood screw 1-1/4 in. No. 14 F. H. (2) |
| 41400 | Machine Rest Pin (wood) |

ATTACHMENT SET NO. 503528
(Packaged in Metal Box)
(Supplied with Machine)

| No. | Name |
|--------|---|
| 263099 | Bobbin (4) |
| 503518 | Box (metal) |
| 503535 | Bushing Extractor for Feed Regulator Segment Bushing |
| 188657 | Guide |
| 50190D | Guide Thumb Screw |
| 135x17 | Needles (5) two each of sizes 14 and 16 and one size 19 |
| 160347 | Presser Foot (edge stitching) with needle hole on right side, for 1/64 in. stitching margin |
| 160348 | Presser Foot (edge stitching) with needle hole on left side, for 1/32 in. stitching margin |
| 35134 | Presser Foot |
| 161185 | Presser Foot 35134 with 337B, 35002, 35135, 35136 and 36696 |
| 35137 | Presser Foot with Extension and Graduated Adjustable Guides complete, Nos. 35003, 35004, 35005, 35006 and 161185 |
| 35002 | Presser Foot Extension |
| 188658 | Presser Foot Graduated Adjustable Guide |
| 35003 | Presser Foot Graduated Adjustable Guide (long, left) |
| 35004 | Presser Foot Graduated Adjustable Guide (long, right) |
| 35005 | Presser Foot Graduated Adjustable Guide (short, right) |
| 35006 | Presser Foot Graduated Adjustable Guide (short, right flush) |
| 35134 | Presser Foot Graduated Adjustable Guide Clamp |
| 35136 | Presser Foot Graduated Adjustable Guide Clamp Lever |
| 337J | Presser Foot Graduated Adjustable Guide Clamp Screw |
| 36696 | Presser Foot Graduated Adjustable Guide Clamp Steady Pin |
| 188740 | Presser Foot with Extension and Graduated Adjustable Guide complete, Nos. 35137 and 188658 |
| 188691 | Presser Foot |
| 188692 | Presser Foot Adjustable Guide |

| No. | Name |
|--------|---|
| 506691 | Presser Foot Adjustable Guide 188692 with 188694 |
| 188696 | Presser Foot Adjustable Guide Bracket |
| 188694 | Presser Foot Adjustable Guide Hinge Pin |
| 188695 | Presser Foot Adjustable Guide Hinge Pin Spring |
| 188693 | Presser Foot Adjustable Guide Hinge Pin Stop Pin |
| 50238J | Presser Foot Adjustable Guide Thumb Screw |
| 188690 | Presser Foot Adjustable Guide Thumb Screw Washer |
| 506692 | Presser Foot Adjustable Guide, Nos. 188693, 188695, 188696 and 506691 |
| 188697 | Presser Foot with Adjustable Guide complete, for Blind Stitching, Nos. 50238J, 188690, 188691 and 506692 |
| 120378 | Screw Driver (shuttle tension) |
| 503505 | Screw Driver (machine) |
| 161083 | Oil Container |
| 503533 | Oil Container 161083 (filled with light grade Oil, Type "C") |
| 503528 | Attachment Set complete, Nos. 50190D, 120378, 160347, 160348, 188657, 188697, 188740, 503505, 503518, 503533, 503535, four 263099 and five needles (135x17, two each of sizes 14 and 16 and one size 19) |

BOBBIN WINDER
(Supplied with Foot Power Drive Machine)

| No. | Name |
|----------|---|
| 506795 | Bracket with 457AL |
| 506688 | Frame with 457AL |
| 34105 | Frame Hinge Pin |
| 457AL | Frame Hinge Pin Set Screw |
| 41914 | Frame Spring |
| 506796 | Pulley with 171ALX |
| 171ALX | Pulley Set Screw |
| 41586 | Spindle |
| 506797 | Spool Holder Bracket |
| 506798 | Spool Holder complete, Nos. 506797 and two each 204296 and 500216XC |
| 204296 | Spool Thread Unwinder Holder (2) |
| 500216XC | Spool Thread Unwinder Holder Screw (2) |
| 506689 | Stop Latch |
| 42614 | Stop Latch Hinge Stud |
| 457AL | Stop Latch Hinge Stud Set Screw |
| 7958 | Stop Latch Stop Pin |
| 41588 | Stop Latch Tripping Arm with 185X |
| 185X | Stop Latch Tripping Arm Clamping Screw |
| 501686 | Tension Disc |

BOBBIN WINDER
(Supplied with Foot Power Drive Machine)
(Continued)

| No. | Name |
|---------|---|
| 501687 | Tension Disc Seat |
| 501688 | Tension Disc Spring |
| 500217J | Tension Screw |
| 501689 | Tension Screw Washer |
| 506799 | Thread Guide and Tension Bracket |
| 506800 | Thread Guide and Tension Bracket complete, Nos. 500217J, 501686, 501687, 501688, 501689 and 506799 |
| 51023K | Thread Guide and Tension Bracket Screw (2) |
| 506801 | Bobbin Winder, Nos. 7958, 34105, 41586, 41588, 41914, 42614, 506688, 506689, 506795 and 506796 |
| 506802 | Bobbin Winder complete, Nos. 506798, 506800 and 506801 |
| 692J | Bobbin Winder Screw |
| 506654 | Bobbin Winder Screw Washer |

BOBBIN WINDER
(Supplied with Motor Drive Machine)

| No. | Name |
|---------|---|
| 202470 | Base |
| 203094 | Bobbin Position Pin |
| 202471 | Frame |
| 200221D | Frame Hinge Screw |
| 202472 | Frame Spring |
| 200161D | Frame Spring Screw |
| 225368 | Pulley with 200380C |
| 200380C | Pulley Set Screw |
| 203095 | Spindle with 203094 |
| 27306 | Spool Pin |
| 27307 | Spool Stand |
| 27308 | Spool Stand complete, Nos. 418C, 5162J, 2106, 10141, 11241, 27306, 27307 and two each 2455 and wood screws 1 in. No. 10 F.H. |
| 11241 | Spool Washer (cloth) |
| 202475 | Stop Latch |
| 200056E | Stop Latch Screw |
| 202477 | Stop Latch Thumb Lever |
| 200299X | Stop Latch Thumb Lever Hinge Screw |
| 200299X | Stop Latch Thumb Lever Joint Screw |

BOBBIN WINDER
(Supplied with Motor Drive Machine)
(Continued)

| No. | Name |
|---------|--|
| 201537X | Stop Latch Thumb Lever Joint Screw Nut |
| 202478 | Stop Latch Trip Lever |
| 200299X | Stop Latch Trip Lever Hinge Screw |
| 2455 | Tension Disc (2) |
| 1562J | Tension Regulating Thumb Nut |
| 418C | Tension Screw Stud |
| 10141 | Tension Spring |
| 2106 | Tension Thread Guide |
| 203096 | Bobbin Winder, Nos. 200056E, 200161D, 200221D, 201537X, 202470, 202471, 202472, 202475, 202477, 202478, 203095, 225368, two wood screws 3/4 in. No. 12 R.H. and three 200299X |
| 506722 | Bobbin Winder Nos. 203096 and two 9331 |
| 506723 | Bobbin Winder (swinging automatic, right hand) complete, Nos. 27308 and 506722 |
| 9331 | Bobbin Winder Washer |

AIR TUCKING ATTACHMENT NO. 506803
(Supplied only when ordered and at an additional charge)

| No. | Name |
|--------|---|
| 506704 | Air Tucking Foot (for wide Tucks) |
| 506705 | Air Tucking Foot (for narrow Tucks) |
| 506706 | Air Tucking Stay (for narrow Tucks) |
| 506707 | Air Tucking Stay (for medium Tucks) |
| 506708 | Air Tucking Stay (for wide Tucks and cording) |
| | Twin Needle |
| 506803 | Air Tucking Attachment complete, Nos. 506704, 506705, 506706, 506707, 506708 and Twin Needle |

BLIND STITCH ATTACHMENT NO. 188724
 (Supplied only when ordered and at an additional charge)

| No. | Name |
|----------|---|
| 188698 | Side Pressure Adjusting Sewing Arm for 188710 |
| 183126XC | Side Pressure Adjusting Sewing Arm Hinge Screw for 188710 |
| 1700XC | Side Pressure Adjusting Sewing Arm Hinge Nut for 188710 |
| 188699 | Collateral Cloth Guide for 188710 |
| 188702 | Collateral Cloth Guide Pressing Spring for 188710 |
| 188706 | Collateral Cloth Guide Pressing Spring Set Pin for 188710 |
| 188700 | Collateral Cloth Guide Plate with 188701 for 188710 |
| 188706 | Collateral Cloth Guide Plate Set Pin for 188710 |
| 592X | Collateral Cloth Guide Plate Set Pin Screw for 188710 (2) |
| 188704 | Collateral Cloth Guide Plate Holder with 188705 for 188710 |
| 183127XC | Collateral Cloth Guide Plate Holder Screw for 188710 |
| 188705 | Collateral Cloth Guide Plate Hinge Pin for 188704 |
| 188701 | Collateral Cloth Guide Pin for 188700 |
| 188707 | Cloth Presser Foot for 188710 |
| 188710 | Blind Stitch Foot, complete Nos. 592X, 1700XC, 183126XC, 183127XC, 188698, 188699, 188700, 188702, 188704, 188707 and two 188706 |
| 188708 | Feller Clamp Plate for 188723 |
| 183128XC | Feller Clamp Plate Screw for 188723 (2) |
| 188709 | Feller Clamp Base for 188723 |
| 188711 | Feller Clamp Base Bow for 188723 |
| 183129X | Feller Clamp Base Bow Screw for 188723 (2) |
| 188712 | Feller Clamp Swing Arm for 188723 |
| 188713 | Feller Clamp Swing Arm Presser Spring for 188723 |
| 183130X | Feller Clamp Swing Arm Presser Spring Fastening Screw (190) shortened for 188723 |
| 188714 | Feller Clamp Swing Arm Guide for 188723 |
| 189696 | Feller Clamp Swing Arm Guide Spring Disc for 188723 (2) |
| 183131X | Feller Clamp Swing Arm Guide Screw for 188723 (2) |
| 188715 | Feller Clamp Swing Arm Fulcrum Pin for 188723 |
| 183132X | Feller Clamp Swing Arm Set Screw (No. 7740 with Slot for 188723) |
| 182514X | Feller Clamp Swing Arm Set Screw Nut for 188723 (2) |
| 188723 | Feller Clamp complete Nos. 183130X, 183132X, 188708, 188709, 188711, 188712, 188713, 188714, 188715 and two each 182514X, 183128XC, 183129X, 183131X and 189696 |
| 188724 | Blind Stitch Attachment, complete, Nos. 188710 and 188723 |

FITTINGS
for Straight Stitching, for Collar Point Work
(Supplied only when ordered and at an additional charge)

| No. | Name |
|--------|---|
| 506809 | Feed Dog, 23 teeth |
| 506614 | Presser Foot Hinge Pin |
| 506810 | Presser Foot Plate |
| 188576 | Presser Foot Shank |
| 506615 | Presser Foot Spring |
| 506811 | Presser Foot complete, Nos. 188576, 506614, 506615 and 506810 |
| 506812 | Throat Plate |

HEMMERS (Foot)
(Supplied only when ordered and at an additional charge)

| No. | Name |
|--------|----------------------------|
| 160344 | Hemmer (foot) 1/16 in. hem |
| 120938 | Hemmer (foot) 3/32 in. hem |
| 120803 | Hemmer (foot) 1/8 in. hem |
| 120804 | Hemmer (foot) 5/32 in. hem |
| 120805 | Hemmer (foot) 3/16 in. hem |
| 120806 | Hemmer (foot) 1/4 in. hem |
| 120807 | Hemmer (foot) 5/16 in. hem |

PRESSER FEET
(Supplied only when ordered and at an additional charge)

| No. | Name |
|---------|---|
| 506709 | Air Tucking Foot (for Thick Tucks) |
| 188659 | Presser Foot (solid) for Button sewing |
| 188660 | Presser Foot (solid) for Edge Quilting |
| 506808 | Presser Foot (solid) for straight stitching |
| 188661 | Presser Foot (solid) for zig-zag work |
| 188613 | Presser Foot (solid) for Satin stitching or Barring |
| 506710 | Presser Foot |
| 506711 | Presser Foot Buttonhole Indicator |
| 500174J | Presser Foot Buttonhole Indicator Clamping Screw |
| 500175J | Presser Foot Buttonhole Stop Screw |
| 506712 | Presser Foot complete, for Buttonholes, Nos. 500174J, 500175J, 506710 and 506711 |

THROAT PLATES

(Supplied only when ordered and at an additional charge)

| No. | Name |
|--------|---|
| 506684 | Throat Plate for zig-zag work, narrow slot for fine work (Lingerie) for use with regular Feed Dog No. 506686 or special Feed Dog No. 506538 |
| 506685 | Throat Plate for straight stitching and hemming for use with regular Feed Dog No. 506686 or special Feed Dog No. 506538 |

FEED DOG

(Supplied only when ordered and at an additional charge)

| No. | Name |
|--------|---|
| 506538 | Feed Dog, coarse (16 teeth per inch) for use with regular Throat Plate No. 506645 or special Throat Plate Nos. 506684 or 506685 |

KNEE LIFTER PARTS

(Supplied with Foot and Motor Drive Machines)

| No. | Name |
|---------|--|
| 2763 | Rock Shaft |
| 97502 | Rock Shaft Hanger (2) |
| ----- | Rock Shaft Hanger Wood Screw (1 in. No. 10 F.H.) (4) |
| 2765 | Rock Shaft Knee Arm with 1509E |
| 2766 | Rock Shaft Knee Arm Hub with 356C |
| 356C | Rock Shaft Knee Arm Hub Set Screw |
| 1509E | Rock Shaft Knee Arm Lock Nut |
| 2768 | Rock Shaft Knee Arm complete, Nos. 2765, 2766 and 2767 |
| 2767 | Rock Shaft Knee Plate with 356C |
| 356C | Rock Shaft Knee Plate Set Screw |
| 6337 | Rock Shaft Lifting Bracket with two 356C |
| 2778 | Rock Shaft Lifting Bracket Hook |
| 356C | Rock Shaft Lifting Bracket Hook Set Screw |
| 356C | Rock Shaft Lifting Bracket Set Screw |
| 2770 | Rock Shaft Stop Dog with 140219C |
| 140219C | Rock Shaft Stop Dog Set Screw |
| 84789 | Rock Shaft complete, Nos. 2763, 2768, 2770, 2778, 6337, two 97502 and four wood screws 1 in. No. 10 F.H. |

SPOOL HOLDER (unwinding) COMPLETE
(Supplied only when ordered and at an additional charge)

| No. | Name |
|--------|--|
| 503529 | Spool Holder Bracket with 219J and 50053D |
| 219J | Spool Holder Set Screw |
| 19066 | Spool Holder Spindle |
| 50053D | Spool Holder Spindle Set Screw |
| 184033 | Spool Holder Spindle Thread Slide Disc |
| 691A | Spool Holder Spindle Thread Slide Disc Screw |
| 503530 | Spool Holder (unwinding) complete, Nos. 691A, 19066, 503529 and 184033, attachable to Thread Guide and Spool Pin (top of arm) |